

# CITY OF BLOOMINGTON DEPARTMENT OF ENGINEERING

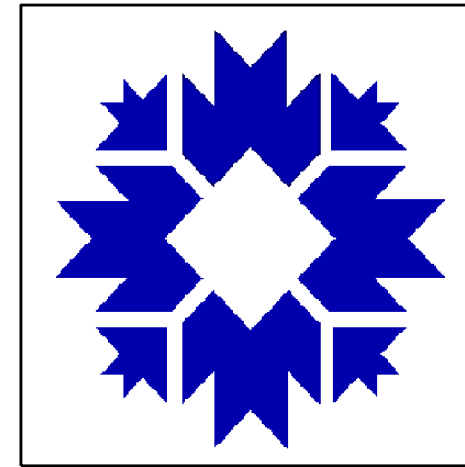

## LONGVIEW AVENUE GREENWAY PETE ELLIS DRIVE TO SMITH ROAD

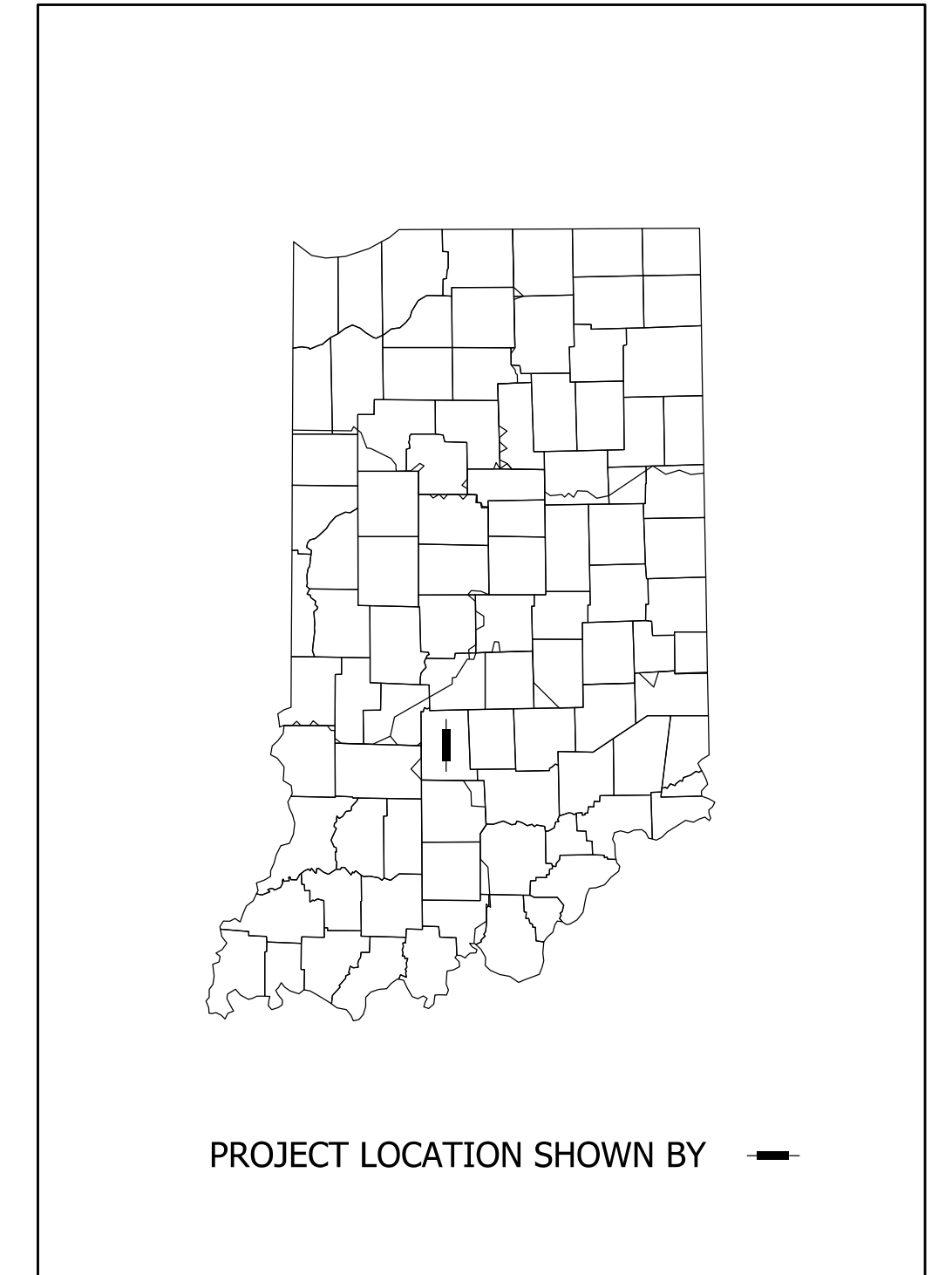

PROJECT LOCATION

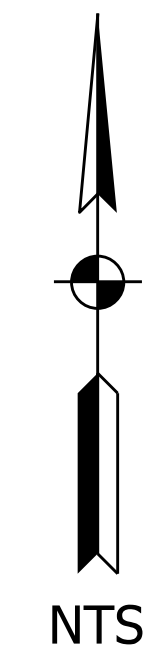
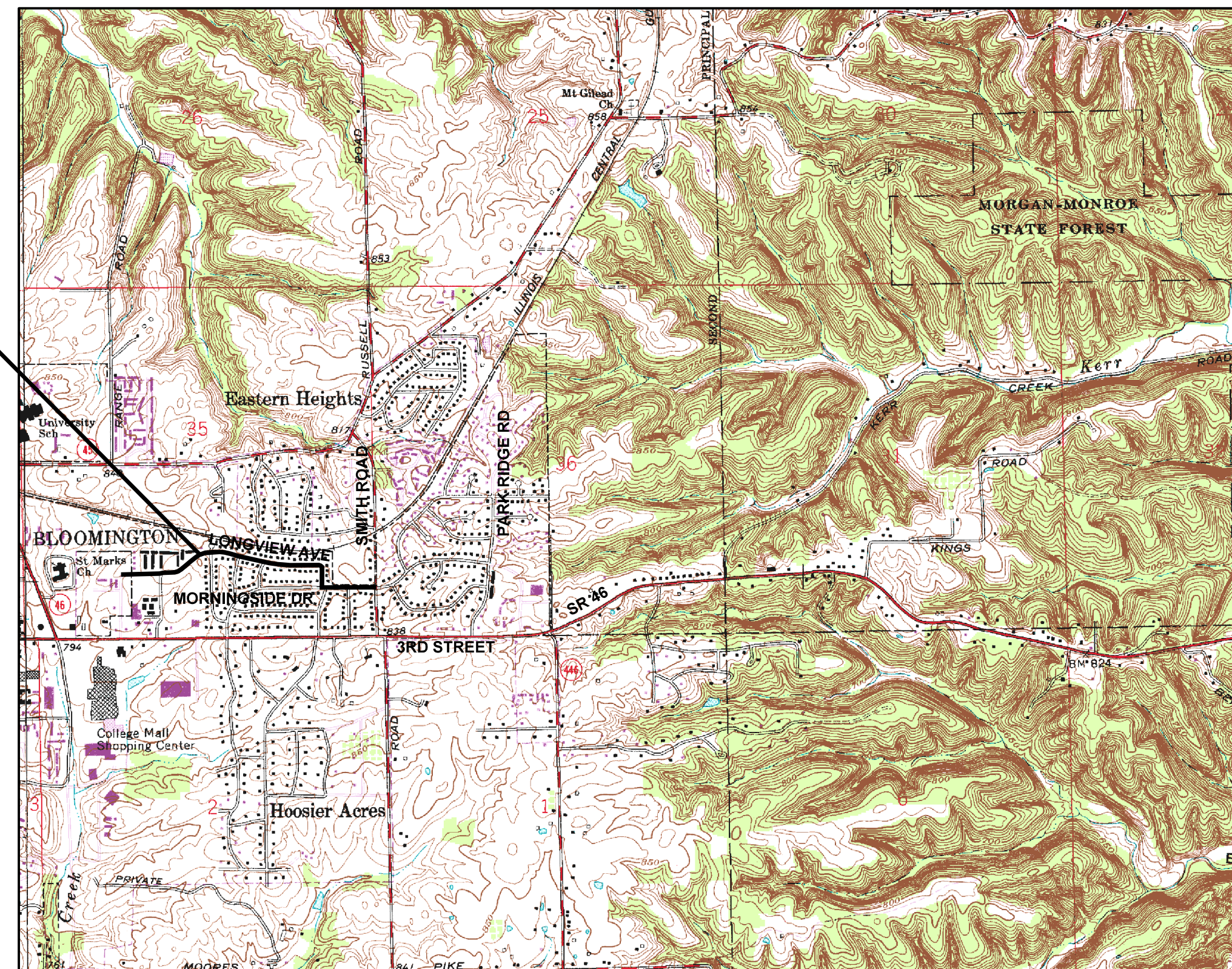

PROJECT LOCATION MAP  
CITY OF BLOOMINGTON, MONROE COUNTY

INDIANA DEPARTMENT OF TRANSPORTATION  
STANDARD SPECIFICATIONS CURRENT EDITION  
TO BE USED WITH THESE PLANS.



8720 Castle Creek Pkwy E Dr, Suite 400,  
Indianapolis, IN 46250  
<https://eticagroup.com>

FOR  
REVIEW  
ONLY

PLANS PREPARED BY: ETICA GROUP, INC. (317) 370-9672  
PHONE NUMBER

CERTIFIED BY: \_\_\_\_\_ DATE

APPROVED FOR LETTING: \_\_\_\_\_ DATE

ETICA GROUP	
230240	
SHEETS	
1	of X
PROJECT	
230240	

LONGVIEW AVENUE GREENWAY

## UTILITIES

**CABLE TELEVISION**  
COMCAST  
ATTN: STEVE McARTOR  
2450 SOUTH HENDERSON ST.  
BLOOMINGTON, IN 47401  
(812) 360-3090

**GAS**  
CENTERPOINT ENERGY  
ATTN: ARIEL THOMAS  
205 SOUTH MADISON  
BLOOMINGTON, IN 47404  
(812) 330-4018  
ariel.thomas@centerpoint.com

**DATA**  
BLOOMINGTON DIGITAL UNDERGROUND  
ATTN: RICK DIETZ  
ITS DEPT. CITY HALL  
401 N. MORTON ST.  
SUITE 150  
BLOOMINGTON, IN 47404  
(812) 349-3485

**ELECTRIC**  
DUKE (DISTRIBUTION)  
ATTN: CHRISTINA GIROD  
16475 SOUTH PARK DRIVE  
WESTFIELD, IN 46074  
(812) 273-9596  
christina.girod@duke-energy.com

**STORM/SANITARY/WATER**  
CITY OF BLOOMINGTON UTILITIES  
ATTN: PHIL PEDEN  
600 E. MILLER DRIVE  
BLOOMINGTON, IN 47401  
(812) 349-3634  
peden@bloomington.in.gov  
24-HR CONTROL OPERATOR  
(812) 339-1444

**TELEPHONE/COMMUNICATIONS**  
US SIGNAL  
ATTN: JOHN LUNDELL  
201 IOWA AVENUE SW  
GRAND RAPIDS, MI 49503  
(616) 988-7117  
jlundell@ussignal.com

**CENTURYLINK**  
(FORMERLY LEVEL 3 AND GTE)  
ATTN: DEWAYNE HAMILTON  
4625 WEST 86TH STREET  
INDIANAPOLIS, IN 46268  
(317) 966-3356  
dewayne.hamilton@centurylink.com

**TELEPHONE/COMMUNICATIONS (CONT.)**  
AT & T  
PRIMARY: JOHN HALL  
(812) 334-4742  
ALT: TOD MOORE  
(812) 334-4718  
4517 INDIANA BELL COURT  
BLOOMINGTON, IN 47408

SMITHVILLE TELEPHONE CO.  
ATTN: JOE BRYNIARSKI  
1600 W. TEMPERANCE ST.  
ELLETTSVILLE, IN 47429-0729  
(812) 935-2262  
joe.bryniarski@smithville.com

CITY OF BLOOMINGTON  
CITY OF BLOOMINGTON STREET DEPARTMENT  
ATTN: FREDDIE LOVE  
1981 S. HENDERSON STREET  
BLOOMINGTON, IN 47401  
(812) 349-3448  
freddie.love@bloomington.in.gov

ZAYO  
ATTN: WAYLON HIGGINS  
9209 CASTLE GATE DRIVE  
INDIANAPOLIS, IN 46256  
(765) 341-1199  
waylon.higgins@zayo.com

## GENERAL NOTES

1	ALL REMOVAL AND EXCAVATION ITEMS ARE TO BE PAID AS CLEARING.
2	ALL RADII ARE TO BACK OF CURB LINE.
3	USE OF INDOT STANDARD SPECIFICATIONS; UNLESS OTHERWISE PROVIDED IN THESE PLANS OR THE TECHNICAL SPECIFICATIONS, MATERIALS AND WORKMANSHIP OF THE WORK SHALL BE AS REQUIRED BY THE CURRENT EDITION OF THE INDOT STANDARD SPECIFICATIONS.
4	USE OF PROPERTY; NO MATERIALS OR EQUIPMENT SHALL BE STORED IN A LOCATION OR MANNER WHICH PRESENTS A HAZARD TO THE PUBLIC OR THE ENVIRONMENT. THE SAFEGUARD OF MATERIALS REMAINING IN THESE AREAS IS THE SOLE RESPONSIBILITY OF THE CONTRACTOR.
5	COORDINATION OF DRAWINGS, TECHNICAL SPECIFICATIONS AND STANDARD SPECIFICATIONS; THE CONTRACT DOCUMENTS WHICH ARE LISTED IN THE AGREEMENT ARE INTENDED TO BE COMPLEMENTARY AND TO DESCRIBE AND PROVIDE FOR COMPLETE WORK. A REQUIREMENT APPEARING IN ONE IS BINDING AS THOUGH OCCURRING IN ALL IN CASE OF DISCREPANCY. THE FOLLOWING ORDER OF PRECEDENCE WILL APPLY: 1. CONSTRUCTION AGREEMENT. 2. INSTRUCTIONS TO BIDDERS. 3. SUPPLEMENTARY GENERAL CONDITIONS. 4. PERMITS ISSUED BY FED/STATE/LOCAL AGENCIES 5. TECHNICAL SPECIFICATIONS. 6. GENERAL CONDITIONS. 7. PROJECT DRAWINGS. 8. STANDARD SPECIFICATIONS AS PUBLISHED BY THE INDIANA DEPARTMENT OF TRANSPORTATION, CURRENT EDITION.
6	PRESENCE OF UTILITIES; MOST OF THIS PROJECT IS PRESENTED ON A GIS BASE MAP AND UTILITIES ARE NOT SHOWN. EXISTING UTILITIES THAT ARE SHOWN ON PLANS ARE APPROXIMATED IN ACCORDANCE WITH AVAILABLE RECORDS/LOCATOR'S MARKINGS, AND PHYSICAL EVIDENCE. OTHER UTILITIES MAY ALSO BE PRESENT. EXACT LOCATIONS AND ELEVATIONS ARE TO BE DETERMINED BY CONTRACTOR.
7	UTILITY LOCATIONS; CONTRACTOR IS REQUIRED BY LAW TO NOTIFY INDIANA UNDERGROUND LOCATION SERVICE AT LEAST TWO WORKING DAYS PRIOR TO COMMENCING ANY EXCAVATION WORK. CONTACT NUMBER IS 811. OTHER LOCAL UTILITIES MAY NOT BE SUBSCRIBERS AND MUST BE CONTACTED INDIVIDUALLY FOR LOCATE REQUESTS.
8	STAKING; CONTRACTOR SHALL BE RESPONSIBLE FOR ALL STAKING.

## INDEX

SHEET NO.	DRAWINGS INDEX
1	TITLE SHEET
2	INDEX / GENERAL NOTES / LEGEND / UTILITY DATA
3 - 5	MISCELLANEOUS DETAILS
6	MAINTENANCE OF TRAFFIC PLANS
7	PLAN KEY - GREENWAY PLANS
8 - 15	GREENWAY PLANS

## GENERAL LEGEND (EXISTING SCREENED, PROPOSED IN BOLD)

	LIGHT POLE		WATER METER
	WATER VALVE		GAS VALVE
	INLETS		GAS METER
	HYDRANT		BOLLARD
	TREES		DOWNSPOUT
	SIGN		STORM
	POWER POLE		UNDERGROUND ELECTRIC
	MANHOLE (STORM, SANITARY)		UNDERGROUND TELEPHONE
	TELECOM MANHOLES		OVERHEAD UTILITY
	AIR CONDITIONER		WATER MAINS/WATER LINES
	TELE. RISER		GAS MAINS/LINE
	ELEC. RISER		GUARDRAIL
	TELECOM MANHOLES		WOOD FENCE
	PARKING METER		
	MAILBOX		

### RAIN GARDEN PREFABRICATED STRUCTURE REQUIREMENTS:

PROJECT INCLUDES 2 EACH PRETREATMENT SEDIMENT AND TRASH TRAPS. THESE SHALL BE RAIN GUARDIAN "BUNKER" MODEL UNITS AS MANUFACTURED BY RINKER MATERIALS. FOR MORE INFORMATION [www.RainGuardian.biz](http://www.RainGuardian.biz)

## MAINTENANCE OF TRAFFIC AND EROSION CONTROL ITEMS

	INDOT STANDARD DRUM WITH STEADY BURN LIGHTS
	TEMPORARY CONSTRUCTION FENCING, 48" MESH, ORANGE, ON TEMPORARY STANDS
	BARRICADE (TYPE III)
	CONSTRUCTION SIGNS (SHAPE PER MUTCD)

## PROPOSED ITEMS

---	EXISTING R/W		CONSTRUCTION LIMITS
	CONCRETE CURB, MOUNTABLE (PROFILE TO MATCH EXISTING)		RAMP, CONCRETE, 6" INCLUDING DETECTABLE WARNING PLATES (PER CITY'S APPROVED MATERIALS LIST) ON 4" COMPACTED AGGREGATE BASE NO. 53s
	CONCRETE CURB		DETECTABLE WARNING PLATES (ON RADIUS, IF RADIUS LABELLED) - (MATERIAL PER CITY PRE-APPROVED MATERIAL LIST)
	REINFORCED CONCRETE CURB		CONCRETE SIDEWALK, 4" ON 4" COMPACTED AGGREGATE, NO. 53s
	MULCH SEEDED AREA - WITH CUSTOM SEED MIX (SEE TEXT BOX)		PCCP FOR PATCHING, 12" WITH 1.5" HMA OVERLAY
	24" WHITE LINES FOR CROSSWALKS OR STOP BARS, THERMOPLASTIC		MILL 10' AND RESURFACE/WEDGE UP TO 1.5" HMA SURFACE, B
	BIKE SYMBOLS, THERMOPLASTIC		NEW TREE, 2" MIN. CALIPER, AMELANCHIER X GRANDIFLORA (CROSS OF ALLEGHENY SERVICE BERRY AND DOWNY SERVICE BERRY)
	WHITE CHEVRONS (FOR BIKE ROUTE), THERMOPLASTIC		TURNING SPACE, MAX. 2% SLOPE IN ANY DIRECTION
	SPEED CUSHION MARKINGS, THERMOPLASTIC		
	REMOVE EXISTING SIGN AND POST		
	RESET EXISTING SIGN ON NEW TYPE I POST WITH UNREINFORCED ANCHOR BASE		
	NEW SIGN ON TYPE I POST WITH UNREINFORCED ANCHOR BASE		

### SEED MIX REQUIREMENTS:

SEED MIXTURE SHALL BE 50 LBS/ACRE OF PERENNIAL RYEGRASS, 50 LBS/ACRE OF CERTIFIED COMMON KENTUCKY BLUEGRASS, AND 50 LBS/ACRE OF MERIT KENTUCKY BLUEGRASS. CONTRACTOR SHALL SEED AT A RATE OF 150 LBS/ACRE. EQUIVALENT SEED MIXTURES MAY BE APPROVED, BUT SHALL NOT CONTAIN ANY PROHIBITED PLANT SPECIES AS LISTED IN BLOOMINGTON MUNICIPAL CODE 20D4.D80. CONTRACTOR SHALL NOT USE PLASTIC LANDSCAPE NETTING OR MESH FOR ANY TYPE OF PERMANENT LANDSCAPING OR EROSION CONTROL.

### TREES, MIN. 2.0"-2.5" CALIPER; UNRESTRICTED LOCATIONS:

T1 - SWAMP WHITE OAK  
T2 - KENTUCKY COFFEETREE  
T3 - TULIP TREE  
T7 - AMERICAN HORNBEAM

### HEIGHT/SIZE RESTRICTED LOCATIONS:

T4 - REDBUD - SINGLE STEM  
T5 - SERVICEBERRY - SINGLE STEM  
T6 - DOGWOOD - SINGLE STEM

FOR INFO ONLY:  
ALL TREES AND PLANTS TO BE INSTALLED BY CONTRACTOR

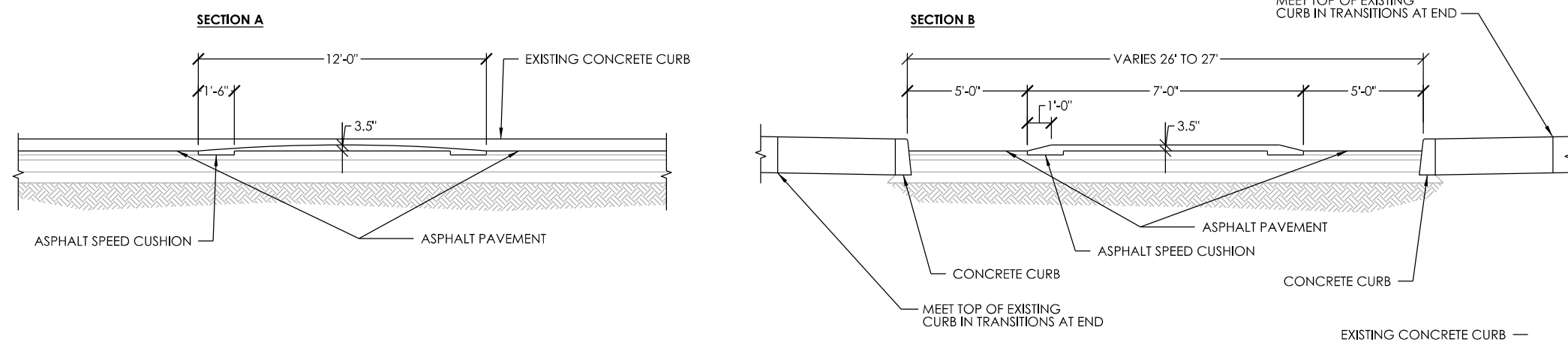

**SC1 ASPHALT SPEED CUSHION FOR FULLY CURBED ROADWAY - SECTION**  
NOT TO SCALE

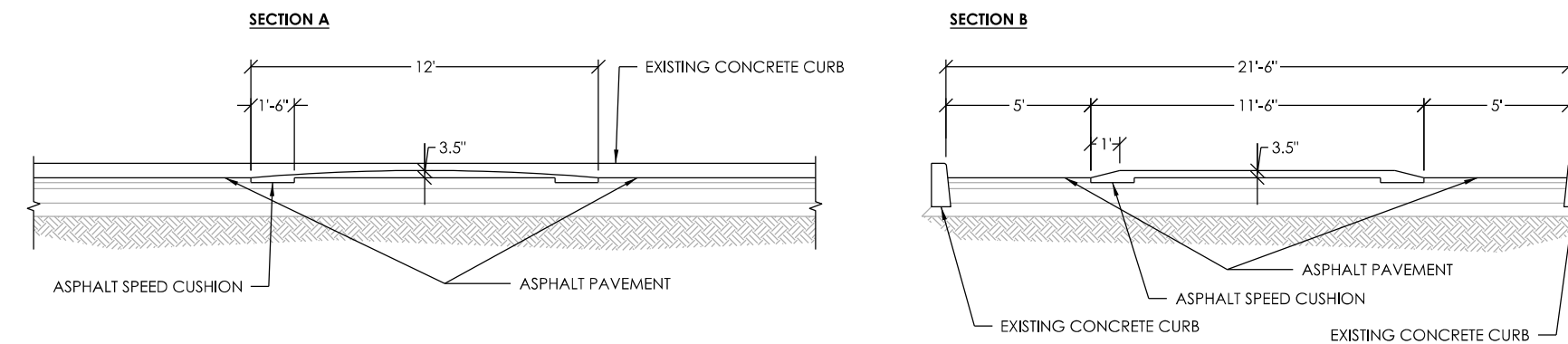

**SC6 ASPHALT SPEED CUSHION FOR FULLY CURBED ROADWAY - SECTION**  
NOT TO SCALE

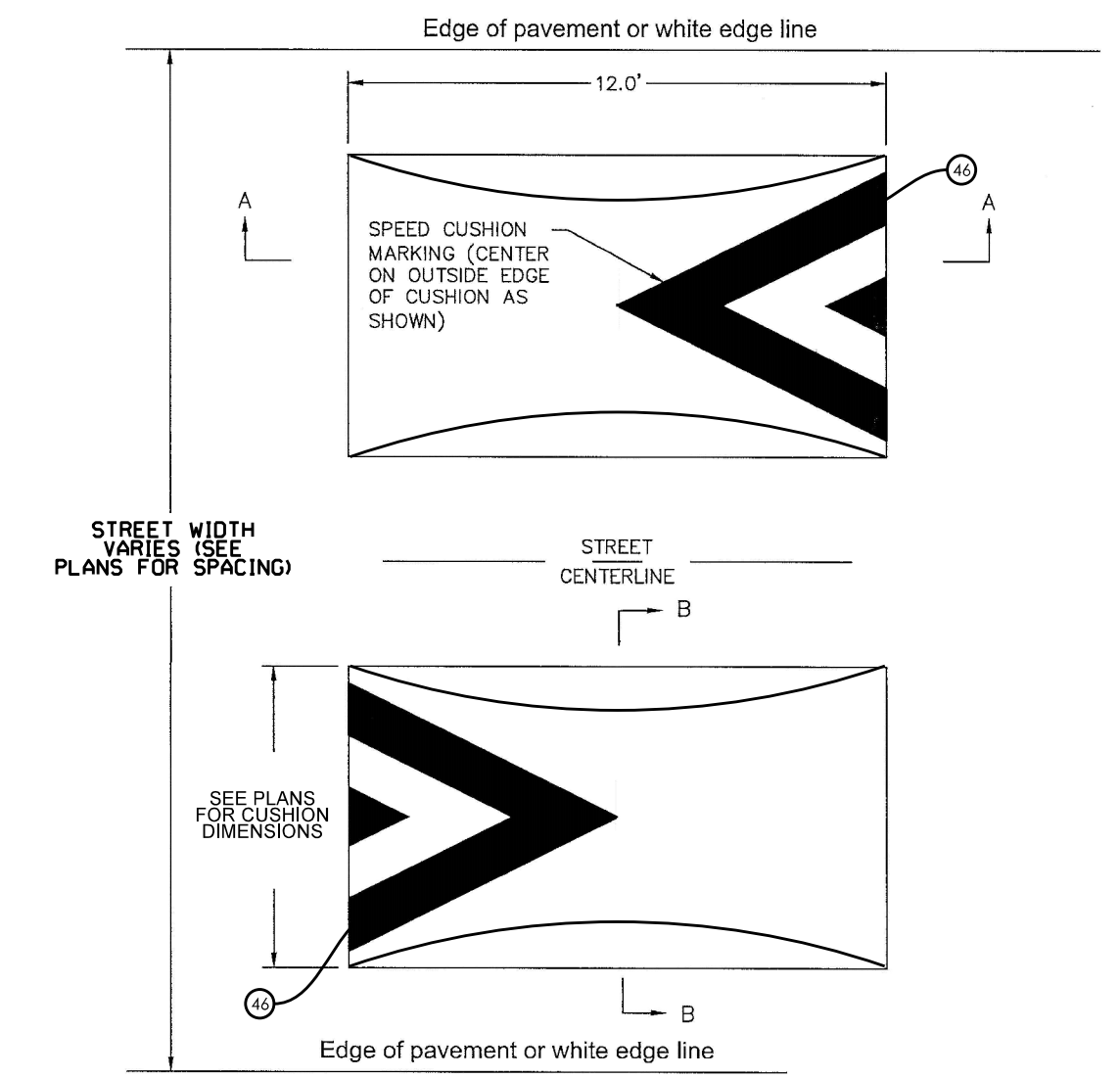

**SC7 ASPHALT SPEED CUSHION FOR INSTALLATIONS WITHOUT BUMPOUTS - TWIN CUSHION INSTALLATION**  
NOT TO SCALE

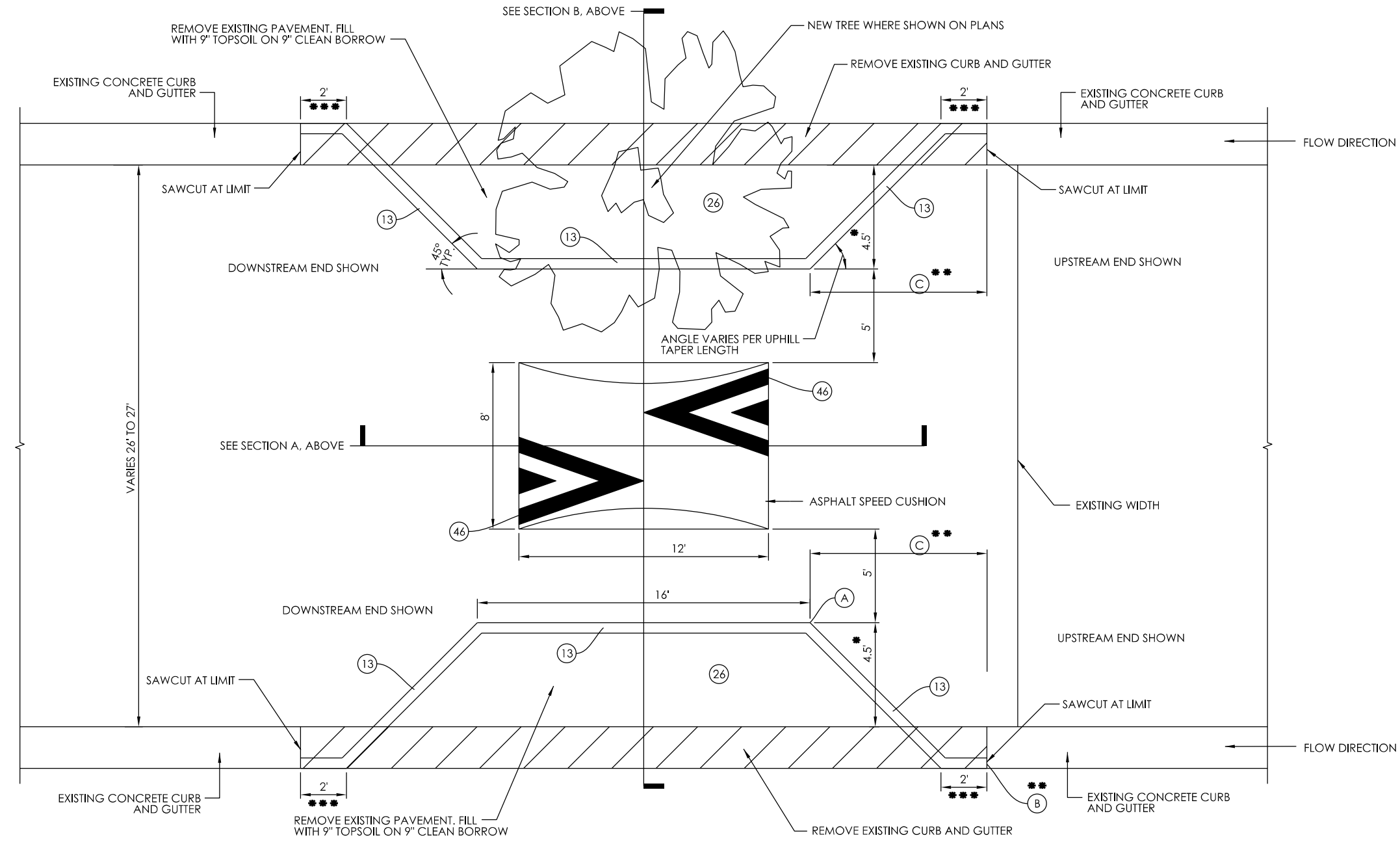

**SC1 ASPHALT SPEED CUSHION FOR FULLY CURBED ROADWAY - PLAN**  
NOT TO SCALE

- VARY THIS DIMENSION UP OR DOWN DEPENDING ON TRUE WIDTH OF STREET. EQUAL ON EACH SIDE OF STREET.
- CONTRACTOR SHALL VERIFY POSITIVE DRAINAGE FROM UPSTREAM GUTTER TRANSITION (B) TO CORNER POINT (A) ON THE UPHILL SIDE OF EACH BUMPOUT. SEE PLANS FOR UPHILL TAPER LENGTH (C).
- Z TRANSITION SLOPED CURB AND GUTTERS TO STANDARD CURB AND GUTTER SECTION.

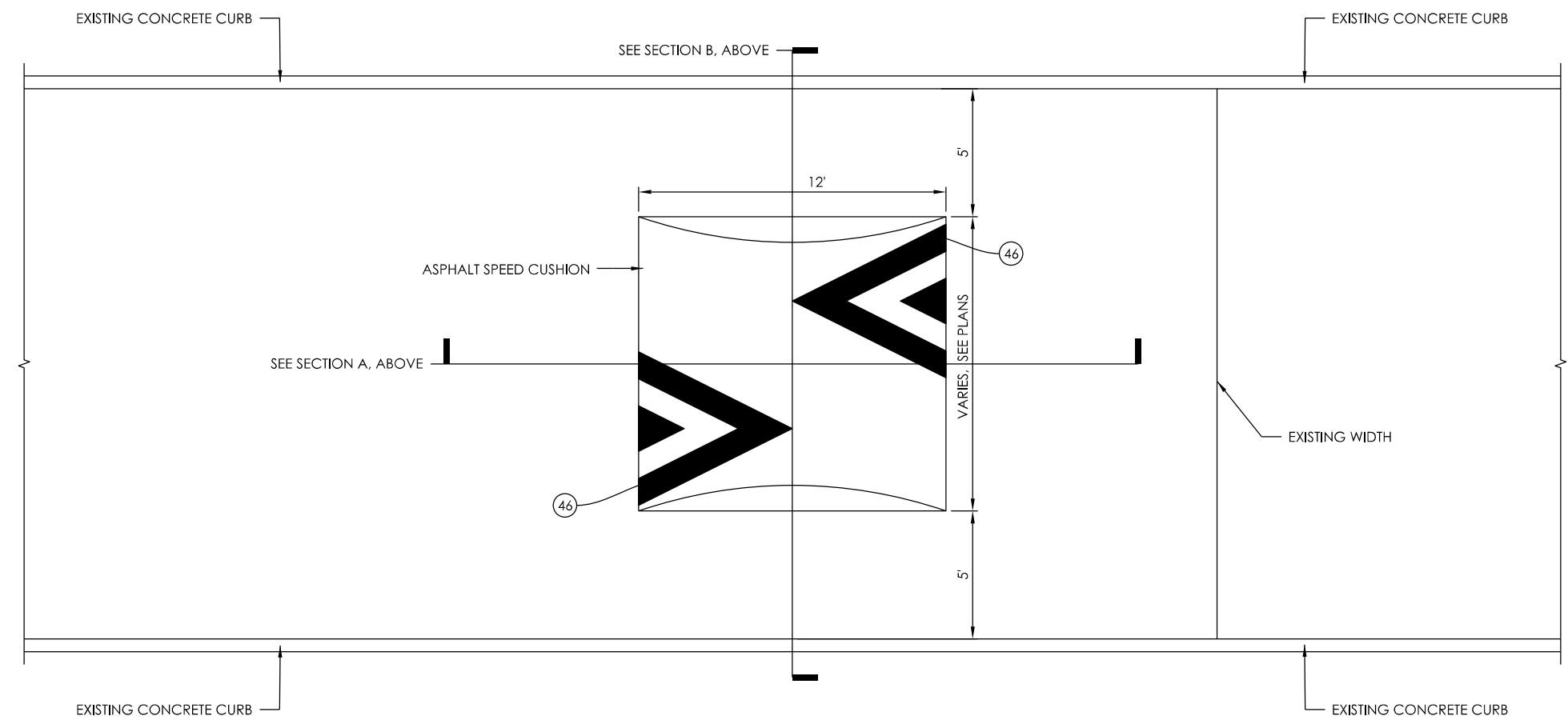

**SC6 ASPHALT SPEED CUSHION FOR FULLY CURBED ROADWAY - PLAN**  
NOT TO SCALE

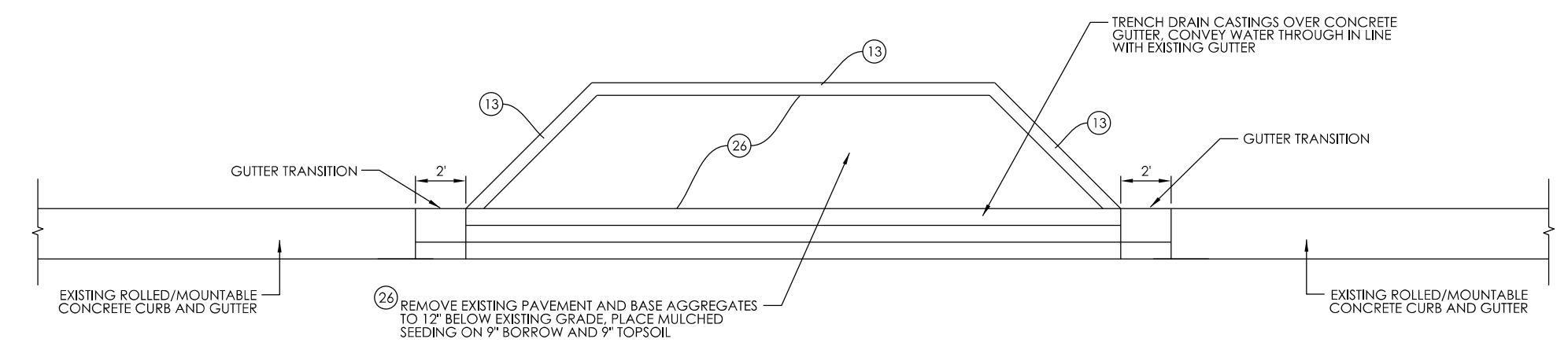

**MODIFIED SC1 FOR DRAINAGE ALONG GUTTERLINE - PLAN**  
NOT TO SCALE

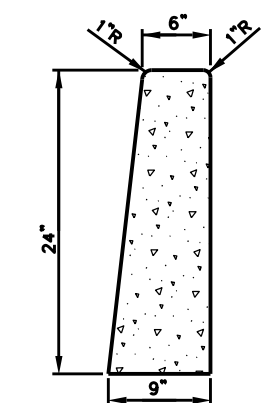

**13 TYPICAL STANDING CURB**  
NOT TO SCALE

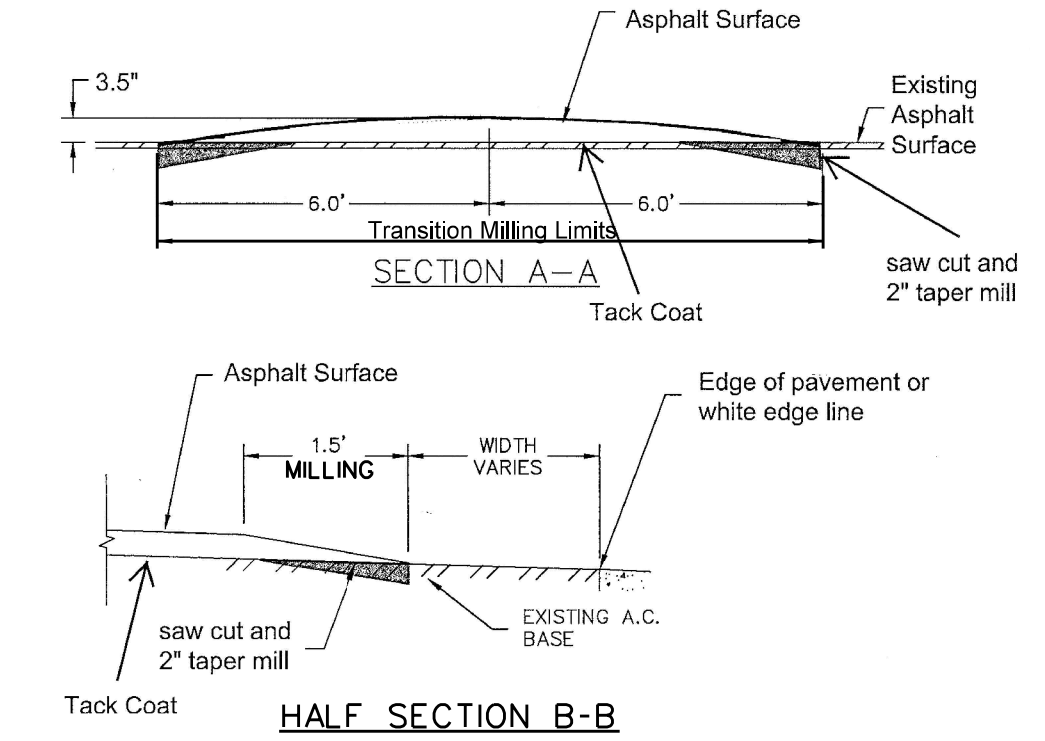

**SC1 SC6 SC7 SPEED CUSHION HEIGHT TOLERANCES**  
NOT TO SCALE

2406d1003-Longview.dgn 3:41:20 PM 5/13/2024



8720 Castle Creek Pkwy E Dr, Suite 400,  
Indianapolis, IN 46250  
<https://eticagroup.com>

FOR REVIEW ONLY

RECOMMENDED FOR APPROVAL _____	DESIGN ENGINEER _____	DATE _____
DESIGNED: BR	DRAWN: RBA	
CHECKED: MT	CHECKED: BR	

CITY OF BLOOMINGTON  
DEPARTMENT OF ENGINEERING

MISCELLANEOUS DETAILS

HORIZONTAL SCALE	ETICA GROUP
AS NOTED	230240
VERTICAL SCALE	
	SHEET NUMBER
	3

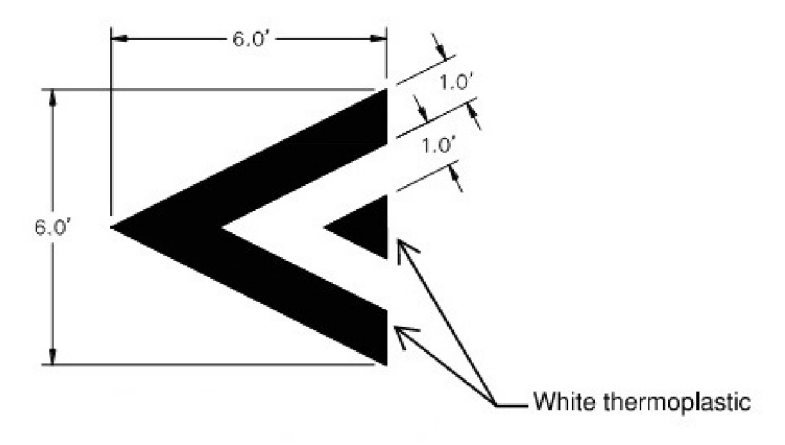
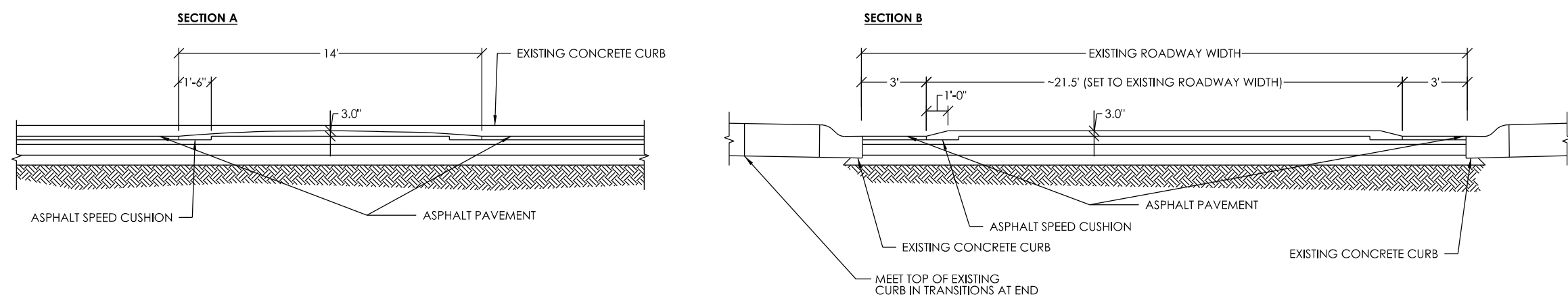

**46 SPEED CUSHION MARKING**  
NOT TO SCALE

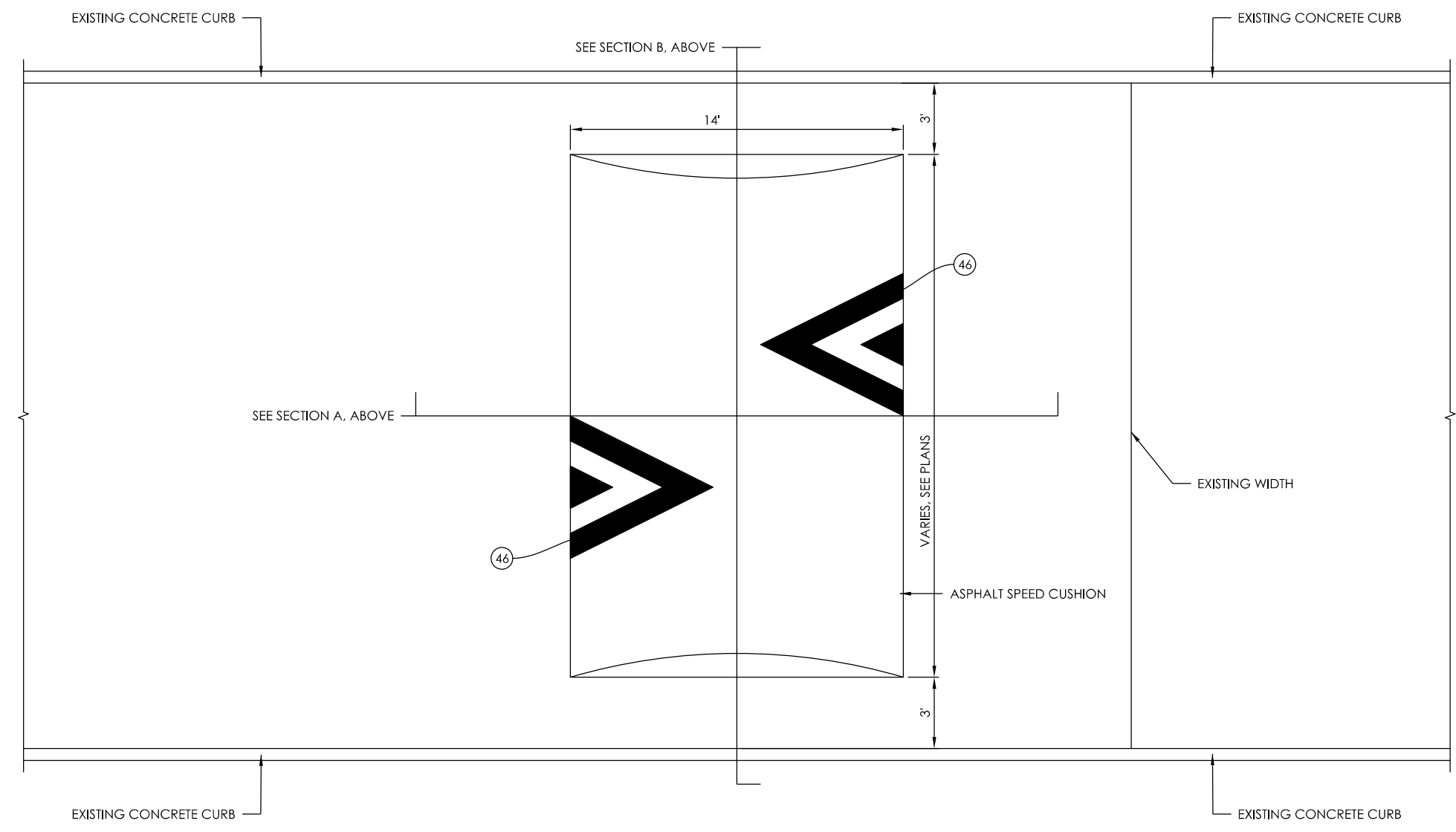

**SC5 14' ASPHALT SPEED HUMP**  
NOT TO SCALE

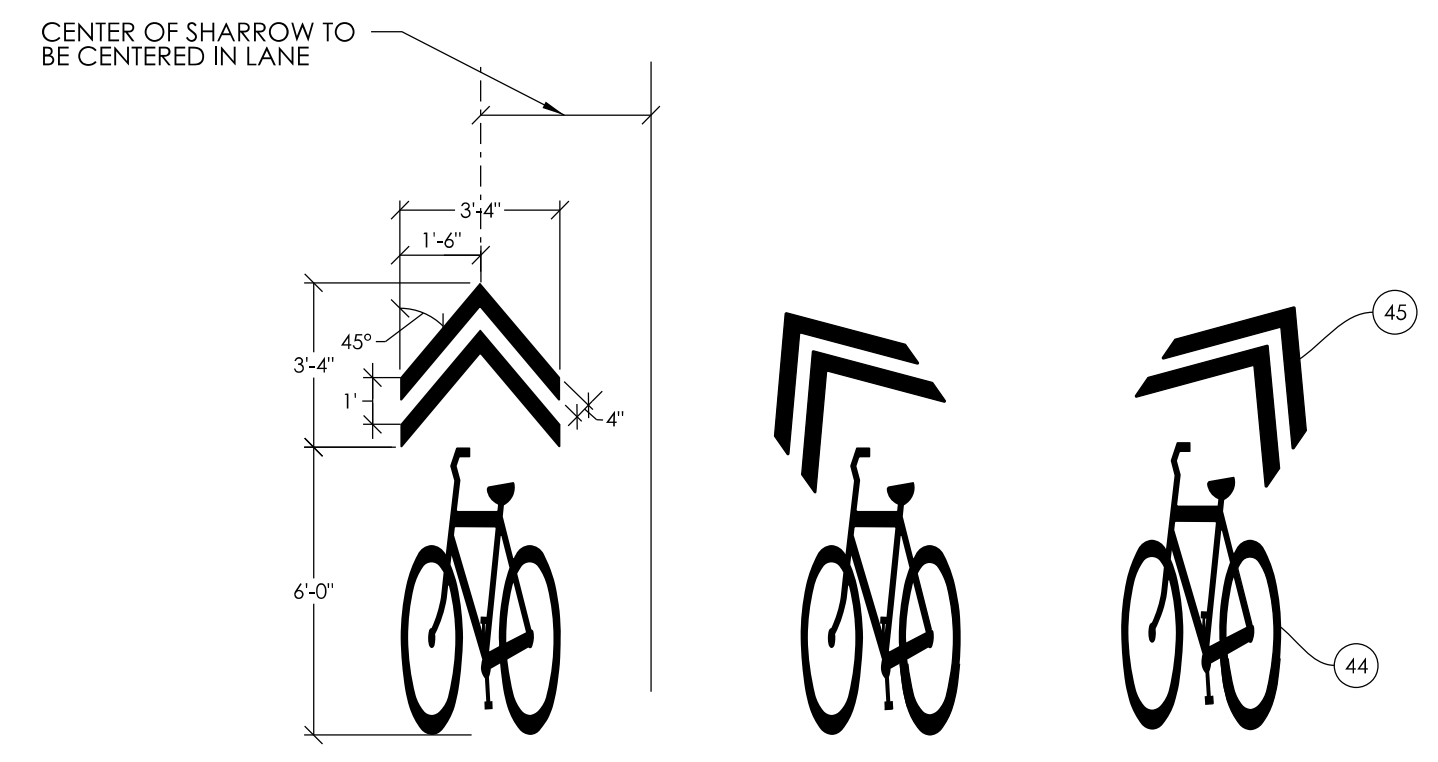

**44/45 SHARED LANE MARKINGS AND CHEVRON DIMENSIONS**  
NOT TO SCALE

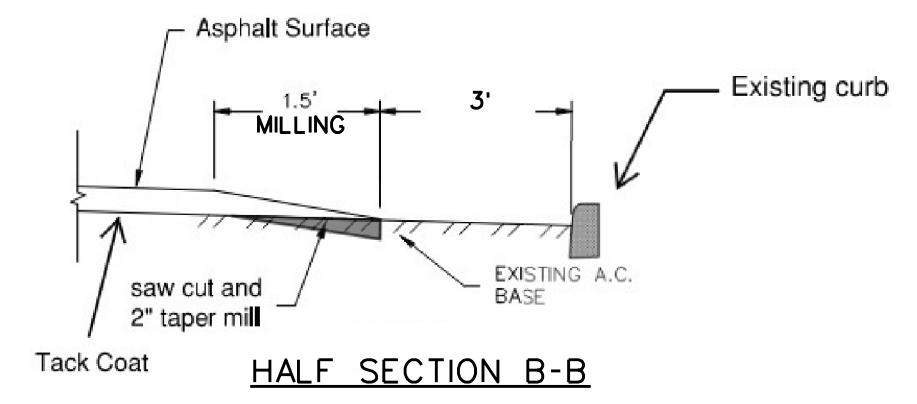
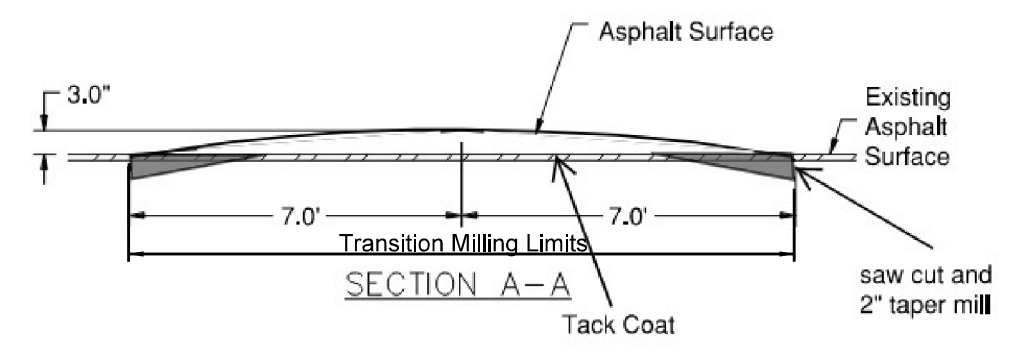

**SC5 SPEED HUMP HEIGHT TOLERANCES**  
NOT TO SCALE

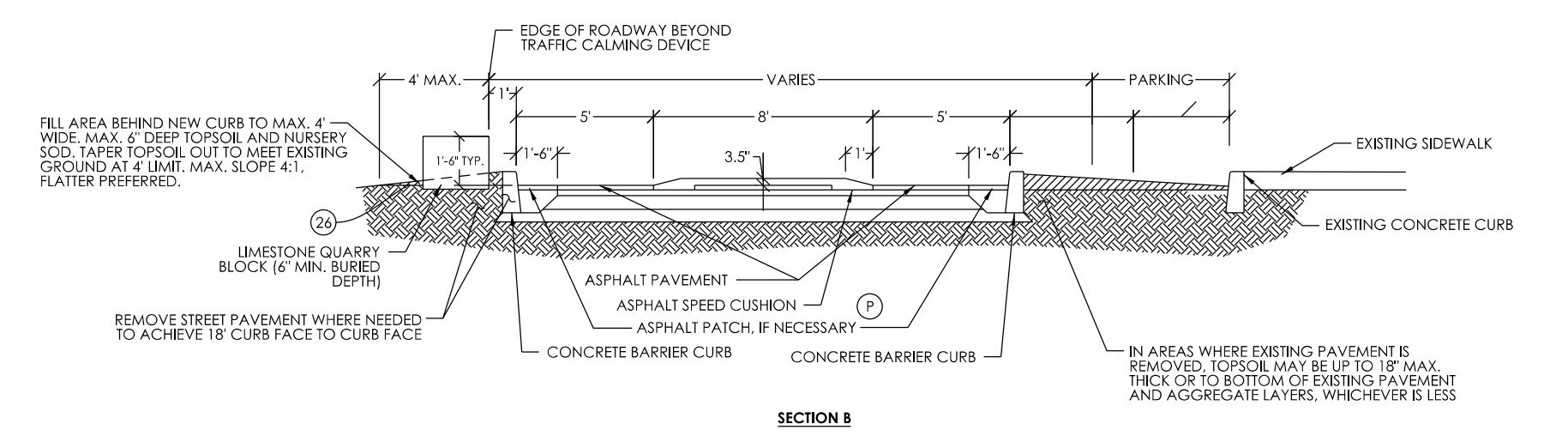
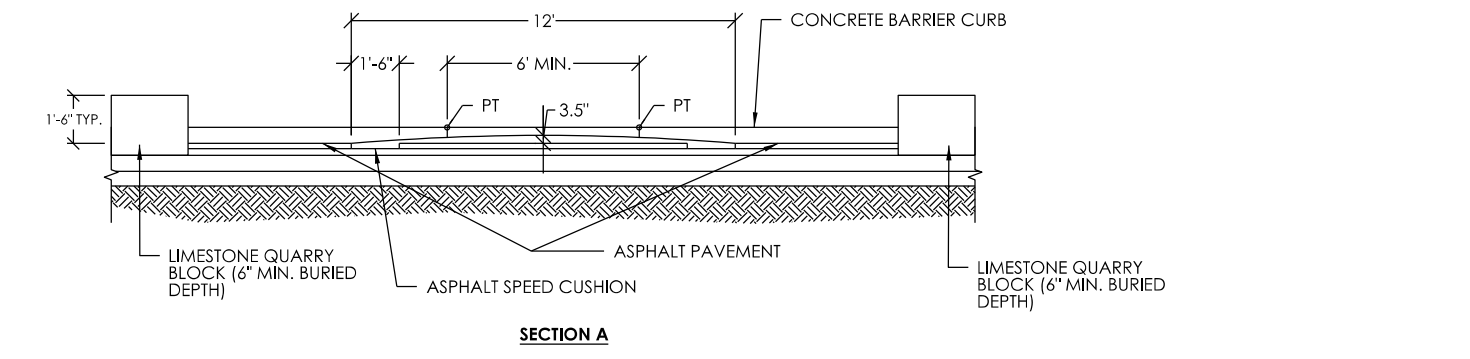

**SC3 ASPHALT SPEED CUSHION FOR CURBLESS ROADWAY - SECTION**  
NOT TO SCALE

**LIMESTONE BLOCK INFO:**  
LIMESTONE QUARRY BLOCKS MAY VARY IN SIZE WITHIN THE RANGES STIPULATED BELOW:  
1. LENGTH: 24" MIN. - 36" MAX.  
2. WIDTH: 24" MIN. - 30" MAX.  
3. HEIGHT: 24" MIN. - 30" MAX.  
NOTE THAT QUARRY BLOCK SHALL BE BURIED SO THAT THE EXPOSED HEIGHT ABOVE GRADE IS 18". MINIMUM BURIED DEPTH = 6"

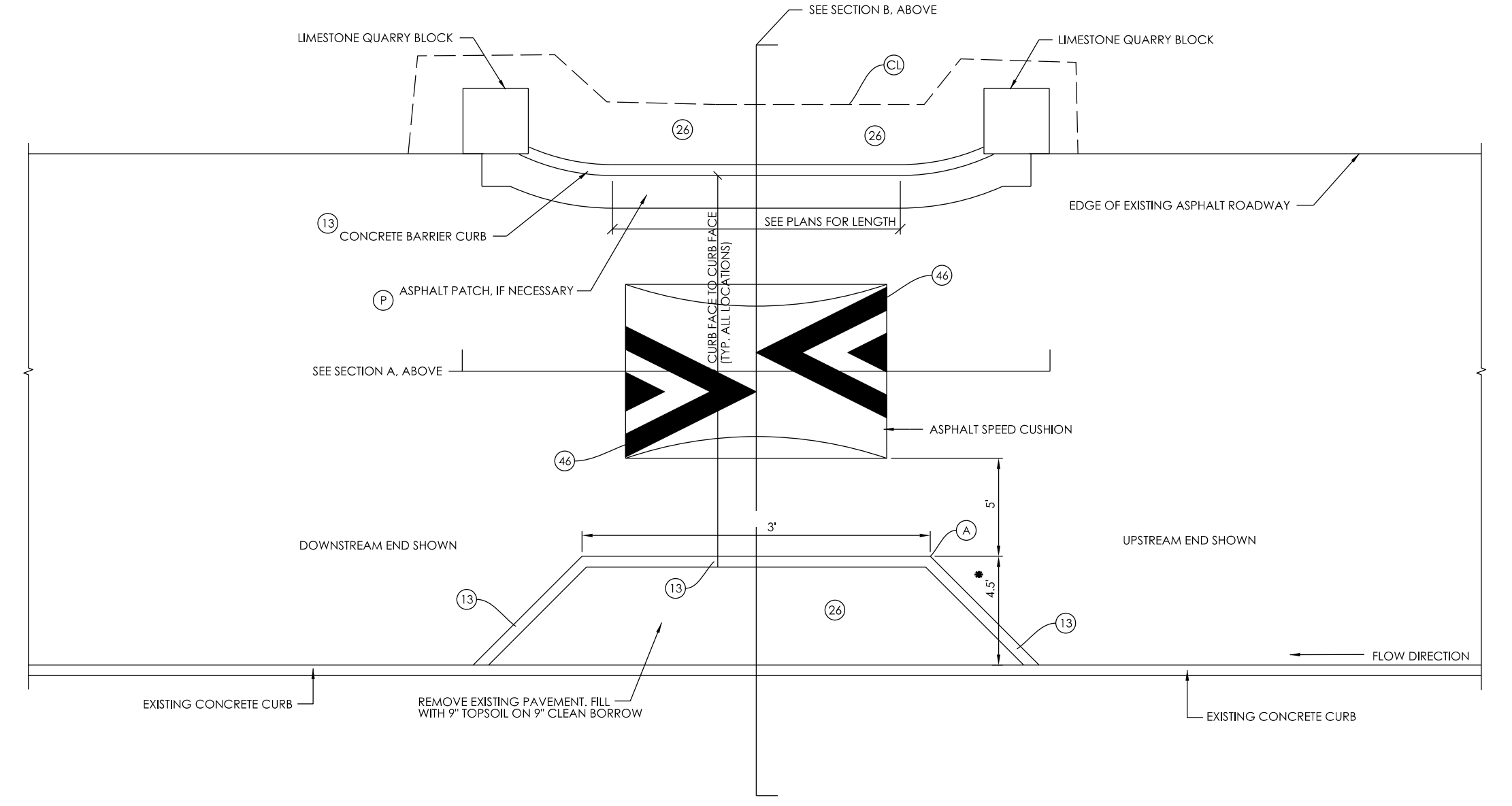

**SC3 ASPHALT SPEED CUSHION FOR CURBLESS ROADWAY - PLAN WITH ONE SIDE WIDTH RESTRICTIONS**  
NOT TO SCALE

EXTENT OF CURB ENCROACHMENT INTO EXISTING PAVEMENT SHALL VARY BASED ON ACHIEVING 18" CURB FACE TO CURB FACE ON STREET ON WHICH EXISTING WIDTH VARIES

240det003-Longview.dgn 3:41:20 PM 5/13/2024



8720 Castle Creek Pkwy E Dr, Suite 400,  
Indianapolis, IN 46250  
<https://eticagroup.com>

FOR REVIEW ONLY

RECOMMENDED FOR APPROVAL	DESIGN ENGINEER	DATE
DESIGNED: BR	DRAWN: RBA	
CHECKED: MT	CHECKED: BR	

CITY OF BLOOMINGTON  
DEPARTMENT OF ENGINEERING

MISCELLANEOUS DETAILS

HORIZONTAL SCALE	ETICA GROUP
AS NOTED	230240
VERTICAL SCALE	
	SHEET NUMBER
	4

SHEET SIGN SUMMARY TABLE																						
SIGN DATA																						
STREET / SHEET	LOCATION	VICINITY ADDRESS	NORTH	SOUTH	EAST	WEST	SIGN DESCRIPTION	SIGN CODE	SIGN SIZE (in. x in.)	RELOCATE EXISTING SIGN EACH	REMOVE SIGN (Paid as Clearing) EACH	NEW SIGN	ENCAPSULATED LENS METAL THICKNESS (in.)			SIGN POST TYPE 1 2.25" x 2.25" x 12 ga. UNREINFORCED ANCHOR BASE			REMARKS			
													0.080	0.100	0.125	POST LENGTH (FT)						
													SFT	SFT	SFT	1	2	TOTAL				
Sheet 8 / Morningside	Btw. Smith and Saratoga	3908		X			Existing 25 MPH	Existing	24 x 18			1										
Sheet 8 / Morningside	Btw. Smith and Saratoga	3908		X			7th / Longview Greenway	D11-1c	24 x 18				1	3.00								
Sheet 8 / Morningside	Btw. Smith and Saratoga	3908		X			Arrow Ahead	M6-1	12 x 9				1	0.75								Mount with Greenway
Sheet 8 / Saratoga	South of Morningside	3926			X		Existing 25 MPH	Existing	30 x 30			1										
Sheet 8 / Morningside	East of Saratoga	4001		X			SPEED HUMP	W17-1	30 x 30				1	6.25								
Sheet 8 / Morningside	East of Saratoga	4001		X			15 MPH (Advisory Plaque)	W13-1P	18 x 18				1	2.25								Mount with Speed Hump
Sheet 10 / Morningside	East of Hampton Court	4223		X			Existing 25 MPH	Existing	30 x 30			1										
Sheet 10 / Morningside	East of Hampton Court	4301		X			SPEED HUMP	W17-1	30 x 30				1	6.25								
Sheet 10 / Morningside	East of Hampton Court	4301		X			15 MPH (Advisory Plaque)	W13-1P	18 x 18				1	2.25								Mount with Speed Hump
Sheet 11 / Morningside	West of Park Ridge	4317		X			Existing Park Speed Limit	Existing	Existing			1										
Sheet 11 / Morningside	West of Park Ridge	4317		X			Existing 25 MPH	Existing	Existing			1										
Sheet 11 / Morningside	West of Park Ridge	4317		X			Existing Greenway Sign	Existing	Existing			1										Move sign to top of existing post
Sheet 11 / Morningside	West of Park Ridge	4317		X			Arrow Ahead	M6-1	12 x 9				1	0.75								Move sign to top of existing post
Sheet 11 / Park Ridge	Park Ridge, SE Corner	NA			X		Existing Stop	Existing	Existing			1										Replace post with relocation
Sheet 11 / Morningside	Park Ridge, SE Corner	NA		X			Existing All Way	Existing	Existing			1										Mount with Stop
Sheet 11 / Morningside	Park Ridge, NE Corner	NA	X				Existing All Way	Existing	Existing			1										Mount with Stop
Sheet 11 / Morningside	Park Ridge, NE Corner	NA	X				Existing Bus Stop and Route Plaques	Existing	Existing			3										Mount under Stop
Sheet 11 / Morningside	East of Park Ridge	NA		X			Existing 25 MPH	Existing	Existing			1										
Sheet 11 / Morningside	East of Park Ridge	4416		X			SPEED HUMP	W17-1	30 x 30				1	6.25								
Sheet 11 / Morningside	East of Park Ridge	4416		X			15 MPH (Advisory Plaque)	W13-1P	18 x 18				1	2.25								Mount with Speed Hump
Sheet 12 / Morningside	Btw. Indiana Bell Ct N & S	4488			X		Existing Park Speed Limit	Existing	Existing			1										
Sheet 12 / Morningside	Btw. Indiana Bell Ct N & S	4488			X		Existing 25 MPH	Existing	Existing			1										
Sheet 12 / Morningside	Btw. Indiana Bell Ct N & S	4488			X		Existing No Parking	Existing	Existing			1										Move sign to top of existing post
Sheet 13 / Morningside	N. of SR 46	4517		X			Existing 25 MPH	Existing	Existing			1										
Sheet 13 / Morningside	N. of SR 46	4517		X			SPEED HUMP	W17-1	30 x 30				1	6.25								
Sheet 13 / Morningside	N. of SR 46	4517		X			15 MPH (Advisory Plaque)	W13-1P	18 x 18				1	2.25								Mount with Speed Hump
Sheet 14 / Saratoga	South of Morningside	3934			X		SPEED HUMP	W17-1	30 x 30				1	6.25								
Sheet 14 / Saratoga	South of Morningside	3934			X		20 MPH (Advisory Plaque)	W13-1P	18 x 18				1	2.25								Mount with Speed Hump
Sheet 15 / Saratoga	West of Park Ridge	4233		X			20 MPH (Advisory Plaque)	W13-1P	18 x 18				1	2.25								Mount with Speed Hump
Sheet 15 / Saratoga	West of Park Ridge	4233		X			20 MPH (Advisory Plaque)	W13-1P	18 x 18				1	2.25								Mount with Speed Hump
TOTALS												9	9	55.5								96
PAY UNIT												EACH	EACH	SFT								LFT

NOTE: PAVEMENT MARKINGS AND SIGNS SHALL BE INSTALLED BEFORE OPENING ANY LANE TO TRAFFIC THAT IS OCCUPIED BY A SPEED CUSHION. TEMPORARY MARKINGS MAY BE USED UP TO TWO WEEKS IN LIEU OF PERMANENT MARKINGS. NO ADDITIONAL PAYMENT WILL BE MADE FOR TEMPORARY MARKINGS.

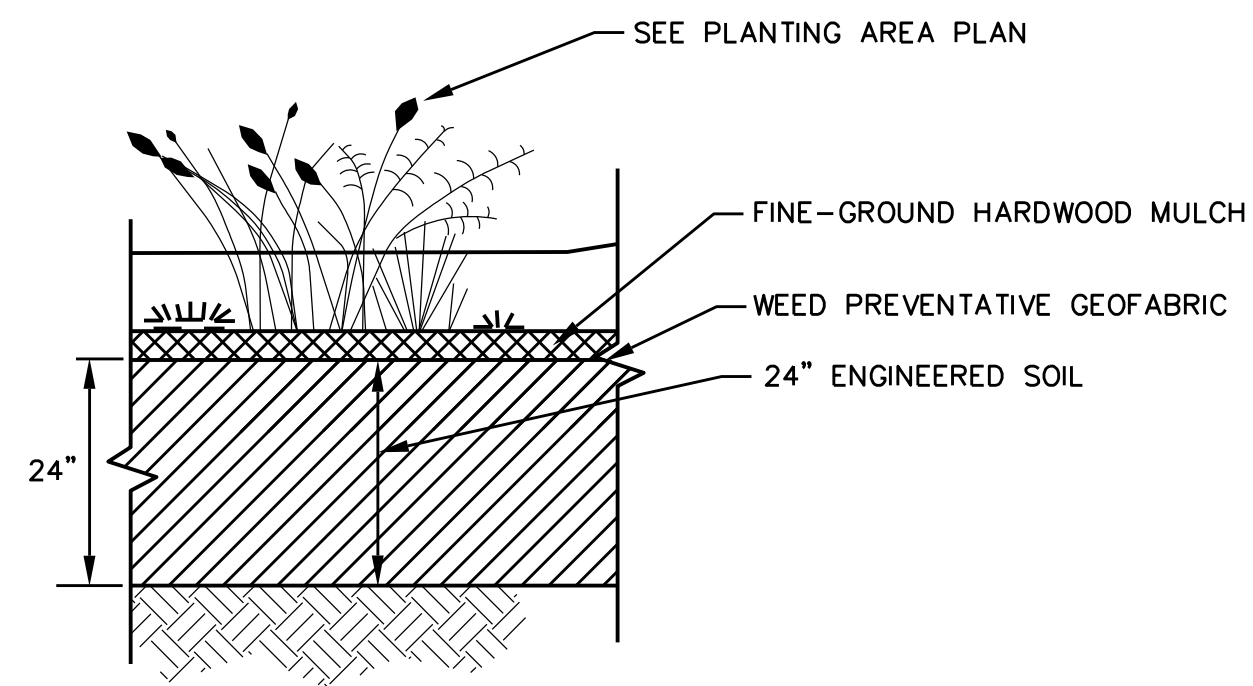

RAINGARDEN SOIL PROFILE SECTION NOT TO SCALE

ENGINEERED SOIL SPECIFICATION:

ENGINEERED SOIL MIX SHALL BE 24" DEEP. BIORETENTION SOIL SHALL BE PROVIDED IN ACCORDANCE WITH APPENDIX F OF THE CITY OF BLOOMINGTON RAINWATER MANAGEMENT GUIDE - SHOULD GENERALLY BE LOAMY SAND WITH THE FOLLOWING COMPOSITION: 85% TO 88% WASHED, COARSE SAND, 8% TO 12% SOIL FINES AND 3% TO 5% ORGANIC MATTER FROM PINE BARK, WITH A P-INDEX BETWEEN 10 AND 30. A MINIMUM INFILTRATION RATE OF 0.5 INCHES PER HOUR, AND A CLAY CONTENT OF LESS THAN 6%. THE MIXTURE SHALL BE WELL BLENDED TO PRODUCE A HOMOGENEOUS MIX. THE FINAL MIX TO BE DETERMINED BY THE ENGINEER BASED ON SAMPLES AND TEST RESULTS SUBMITTED.

RAINGARDEN NOTES:

1. RAINGARDENS WITHOUT UNDERDRAINS OR OVERFLOW STRUCTURES SHALL INCLUDE ONLY THE 24" ENGINEERED SOIL OVERTOPPED WITH A WEED PREVENTATIVE GEOFABRIC AND 2"-3" OF RIPRAP COVER.
2. GEOFABRIC TO BE CUT OUT FOR PLANTINGS.
3. RIPRAP-RIVER ROCK AT ENTRY AND EXIT POINTS SHALL BE LARGER AGGREGATE THAN LANDSCAPING RIVER ROCK BUT OF SAME COLORS AND SHAPE (COBBLE STONES, ETC.)
4. HARDWOOD MULCH AND RIPRAP-RIVER ROCK TO BE APPROVED IN ADVANCE BY ENGINEER.

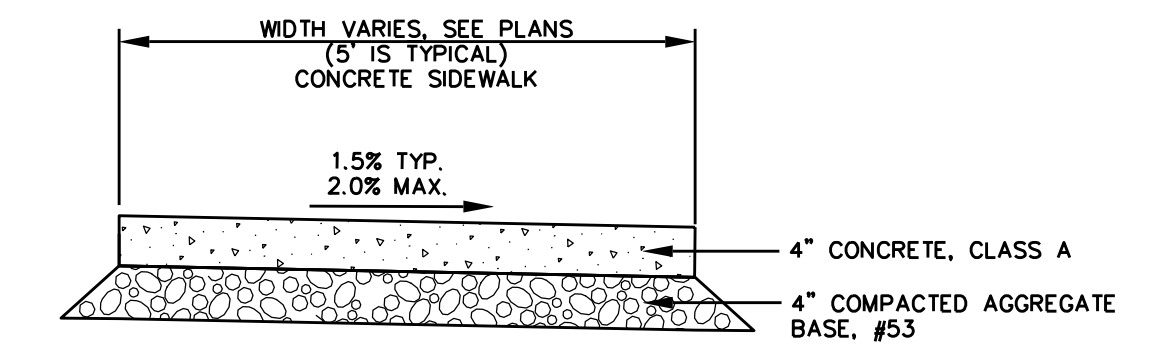

TYPICAL SIDEWALK DETAIL NOT TO SCALE

SIDEWALK JOINT NOTES:

1. INSTALL 1/2" PREFORMED JOINT FILLER BETWEEN SIDEWALKS AND ANY OTHER FIXED FEATURES (CURBS, STEPS, RAMPS, BUILDINGS, ETC.)
2. IN EACH SIDEWALK SEGMENT, TOOL CONSTRUCTION JOINTS AT EVEN SPACING BUT NO MORE THAN 6' MAXIMUM APART. INSTALL AN EXPANSION JOINT WITH 1/2" PREFORMED JOINT FILLER AT A MAXIMUM SPACING EVERY 30' IN SIDEWALKS, AND AT EACH SIDEWALK CONNECTION TO OTHER SIDEWALKS, AT CURBS, AND AT RAMPS.
3. CONTRACTION AND EXPANSION JOINTS SHALL BE INSTALLED BY TOOLING, BUT FINAL SURFACE SHALL BE BROOM FINISHED. NO "WINDOW-PANE" OR SIMILAR TOOLING SHALL BE USED.

CONCRETE SLAB JOINT NOTES:

1. CONCRETE SLAB CONSTRUCTION AND EXPANSION JOINTS SHALL BE IN ACCORDANCE WITH INDOT STANDARDS.

CURB JOINT NOTES:

1. ALL CURBS SHALL RECEIVE A FULL DEPTH EXPANSION JOINT FORMED WITH 1/2" PREFORMED JOINT FILLER AT THE FOLLOWING LOCATIONS:
  - EVERY EXPANSION JOINT IN ADJACENT SIDEWALKS OR MEDIAN BUFFER STRIP
  - AT EACH RADIUS POINT
  - ON EITHER SIDE OF CURB INLETS OR OTHER CASTINGS
  - AT SAWCUT, LIMITS OF REMOVAL TO ANY EXISTING CURB
  - AT 100' MAXIMUM INTERVALS, IF NO OTHER JOINTS NEEDED
2. CURBS & COMBINED CURB AND GUTTER SHALL RECEIVE A TOOLED CONTRACTION JOINT AT 20' MAXIMUM SPACING.

CURB RAMPS AND TRUNCATED DOMES:

1. RAMPS TO BE CONSTRUCTED AT A MAXIMUM 12:1 SLOPE TO A LANDING AREA FOR ENTRY ONTO ROADWAY PER PLANS.

PLAN VIEW

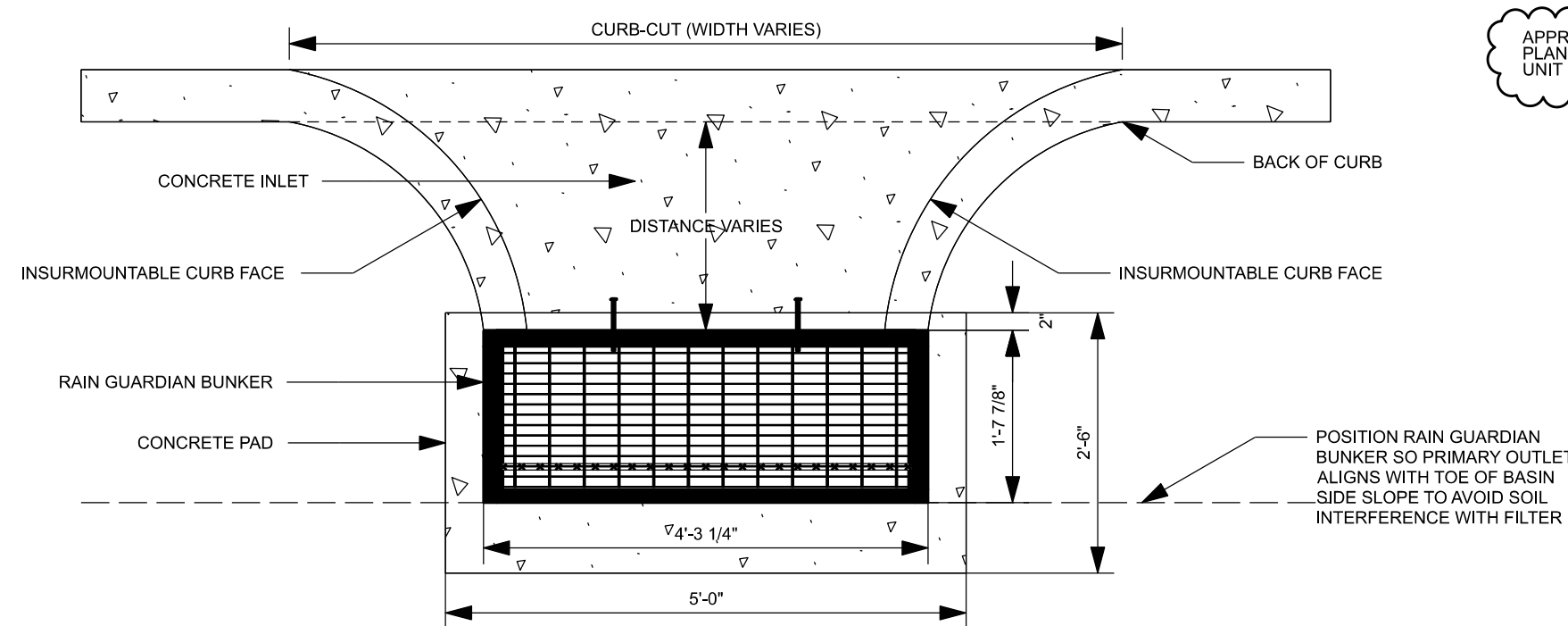

APPROACHING CURBS ARE TO BE PER GREENWAY PLANS AND BUILT TO MEET ENTRANCE OF BUNKER UNIT SIMILAR TO THIS MANUFACTURER'S DETAIL

3D VIEWS

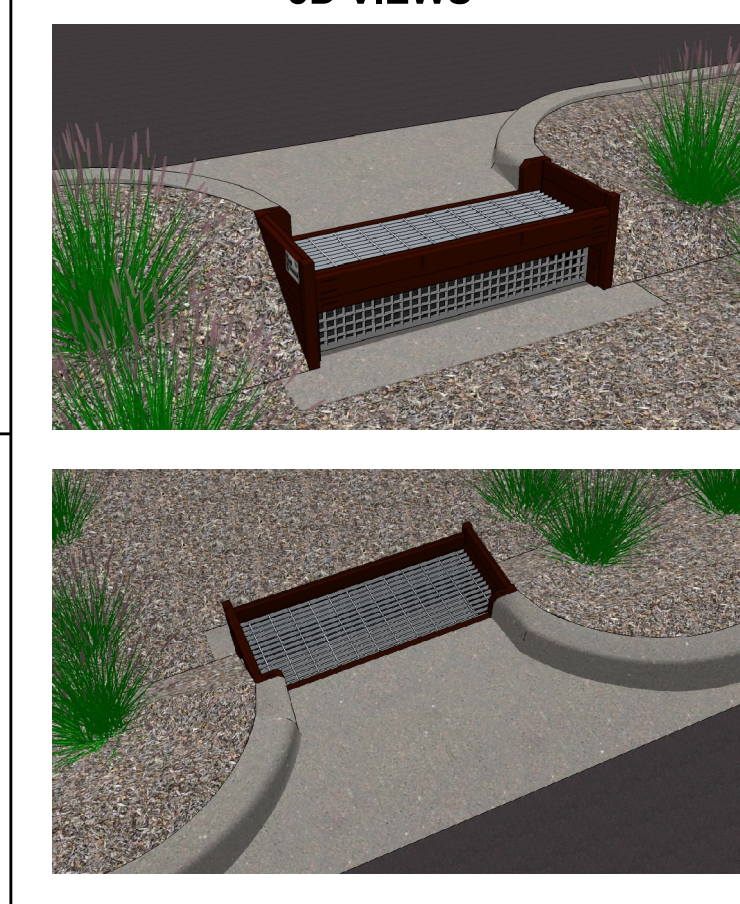

ELEVATION VIEW

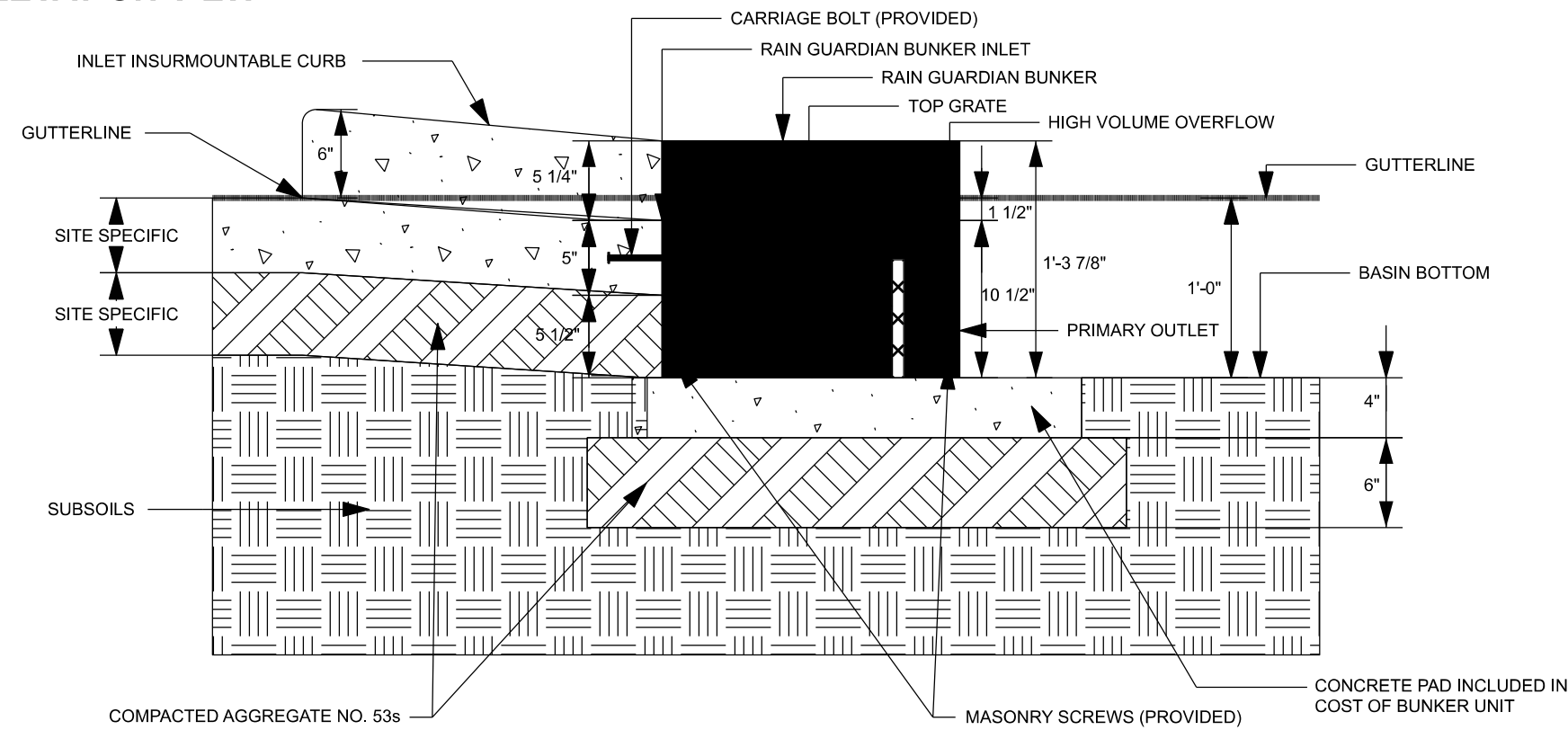

RAIN GUARDIAN BUNKER NOT TO SCALE

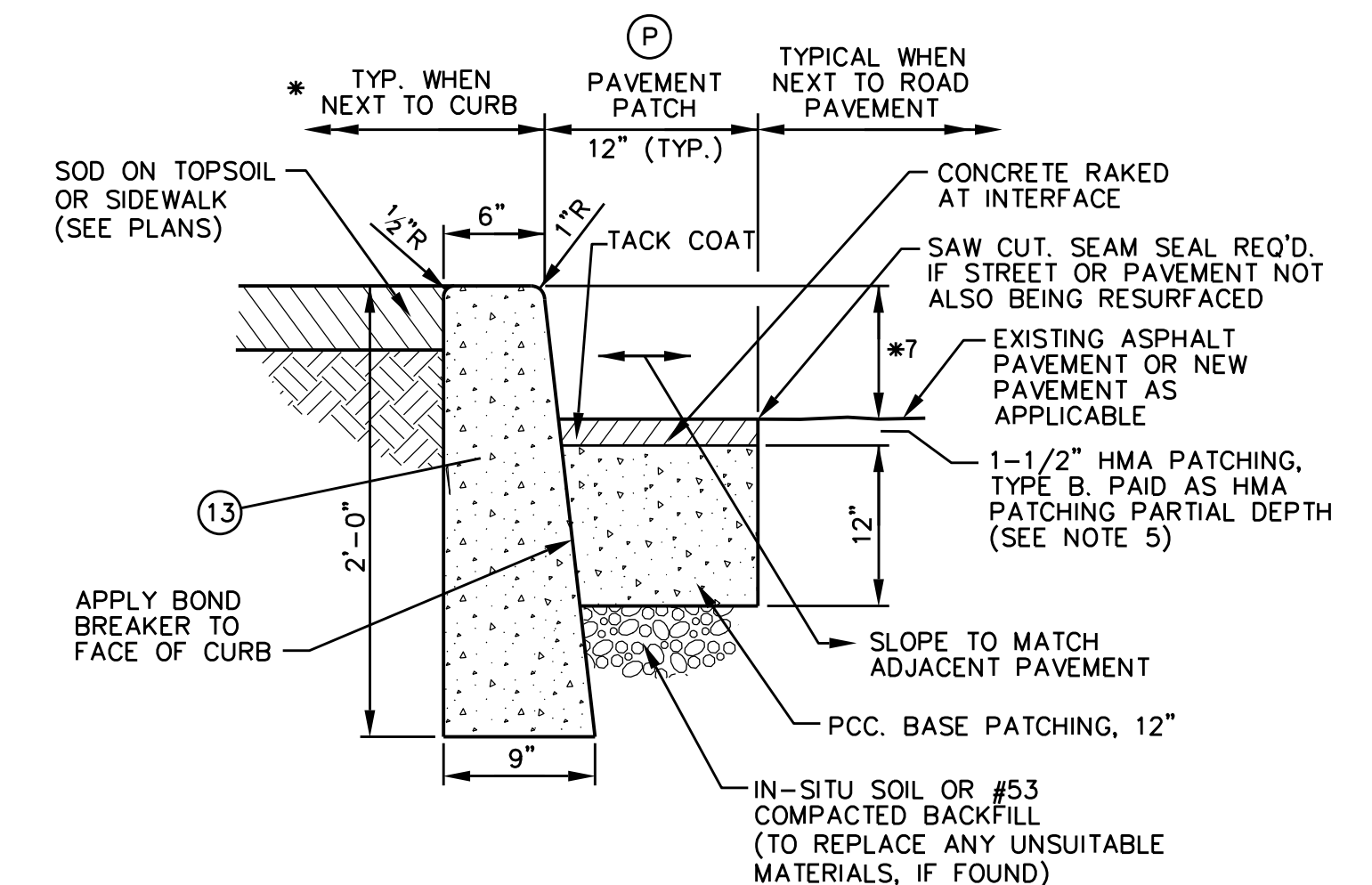

PAVEMENT PATCH / CONCRETE CURB (VERTICAL) NOT TO SCALE

NOTES:

- \* 1. AREA BEHIND CURBS TO RECEIVE TREATMENT AS SHOWN ON PLANS.
2. REFER TO CURB JOINTS NOTES FOR CURB JOINTING.
3. PAVEMENT PATCHING MAY NOT BE REQUIRED IF EXISTING PAVEMENT CAN BE REMOVED TO A CLEAN AND STRAIGHT EDGE AT FRONT OF PROPOSED CURB OR GUTTER. OWNER APPROVAL IS REQUIRED.
4. PAVEMENT PATCHING REQUIRED WHEREVER PAVEMENT IS CUT, AND WHERE EXISTING PAVEMENT IS DAMAGED TO COMPLETE THE REQUIRED CURB, DRIVE OR SIDEWALK WORK.
5. CONTRACTOR SHALL ASSUME THEY ARE TO PLACE THE ASPHALT OVERLAY ON ALL PATCHED AREAS UNLESS OTHERWISE DIRECTED.
6. PATCHING PORTION OF THIS DETAIL TO ALSO BE USED WITH (14) REINFORCED CONCRETE CURB FOR RAINGARDENS.
7. EXPOSED CURB HEIGHT VARIES, BUMPPOINTS SHALL BE TYPICAL 4", RAINGARDENS 6", OTHER LOCATIONS MATCH EXISTING.

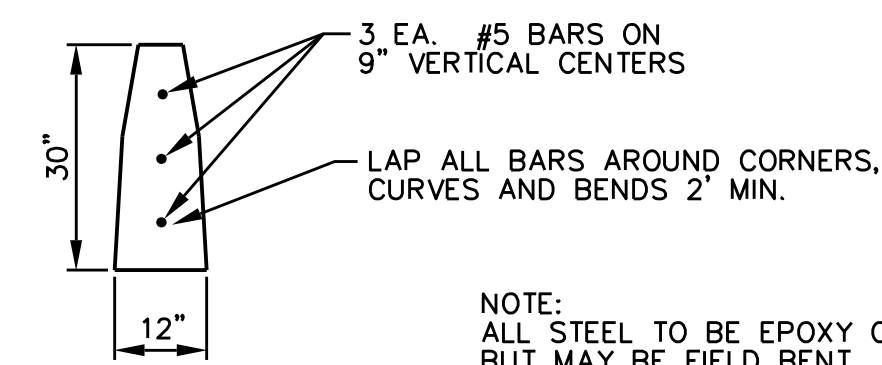

REINFORCED CONCRETE CURB FOR RAINGARDENS NOT TO SCALE

240det003-Longview.dgn 3:41:24 PM 5/13/2024



8720 Castle Creek Pkwy E Dr, Suite 400, Indianapolis, IN 46250  
<https://eticagroup.com>

FOR REVIEW ONLY

RECOMMENDED FOR APPROVAL _____	DESIGN ENGINEER _____	DATE _____
DESIGNED: BR	DRAWN: RBA	
CHECKED: MT	CHECKED: BR	

CITY OF BLOOMINGTON  
DEPARTMENT OF ENGINEERING

MISCELLANEOUS DETAILS

HORIZONTAL SCALE	ETICA GROUP
AS NOTED	230240
VERTICAL SCALE	
	SHEET NUMBER
	5

MOT QUANTITIES		
ROAD CLOSURE ASSEMBLIES		
ROAD CLOSED	R11-2	x EA.
ROAD CLOSED, LOCAL TRAFFIC ONLY	R11-3	x EA.
	TOTAL	x EA.
BARRICADES, III-B		
ON PLANS		x LFT
UNDISTRIBUTED		x LFT
	TOTAL	x LFT
CONSTRUCTION SIGNS, A		
ROAD CONSTRUCTION AHEAD	XW20-1	x EA.
UNDISTRIBUTED/OWNER DETERMINED		x EA.
FLAGGER AHEAD	W20-7a	x EA.
BE PREPARED TO STOP	W20-7b	x EA.
	TOTAL	x EA.
CONSTRUCTION SIGNS, B		
DETOUR	XM4-9	x EA.
END CONSTRUCTION		x EA.
	TOTAL	x EA.

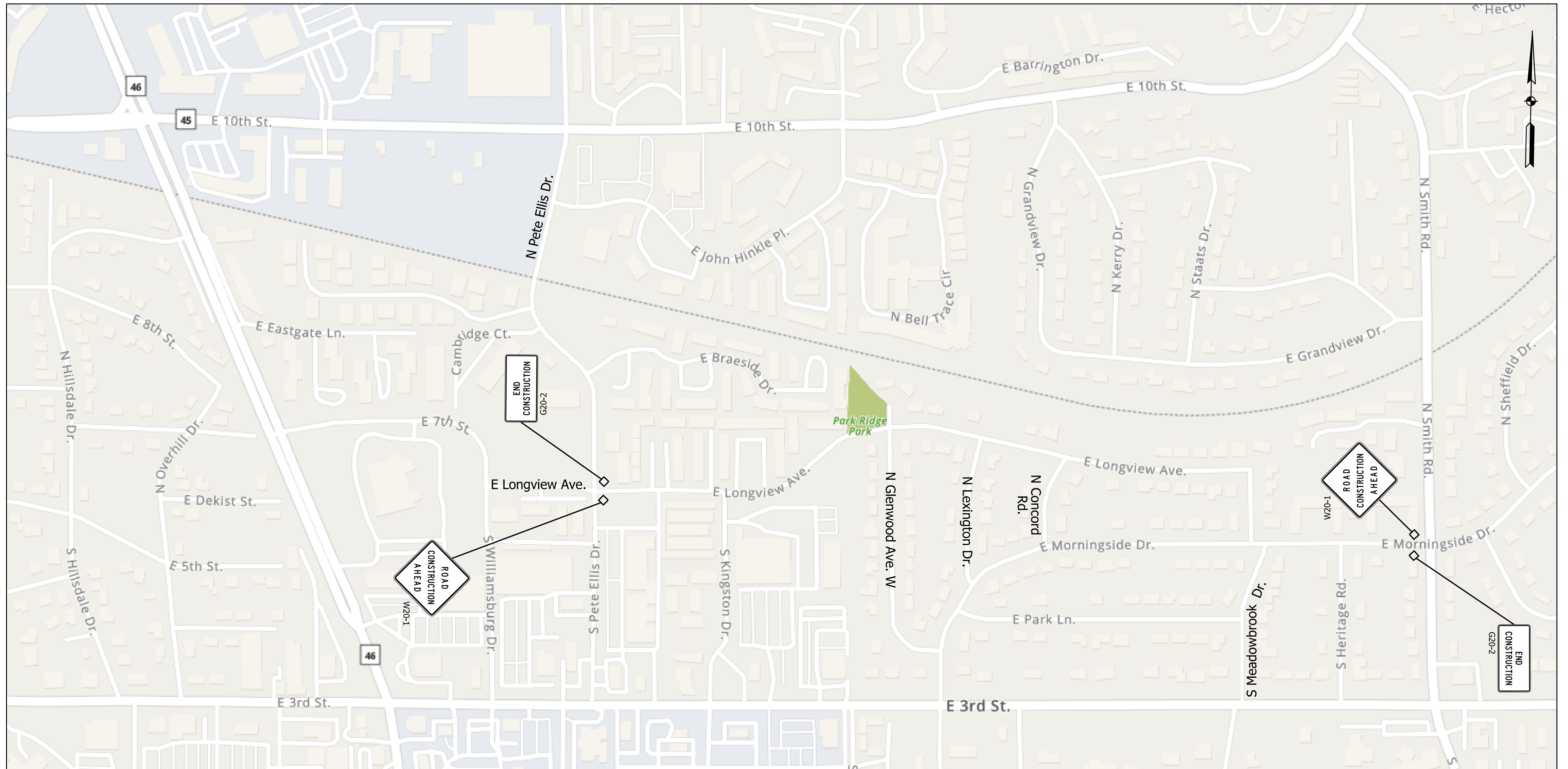

DETOUR ROUTE MAP  
NTS

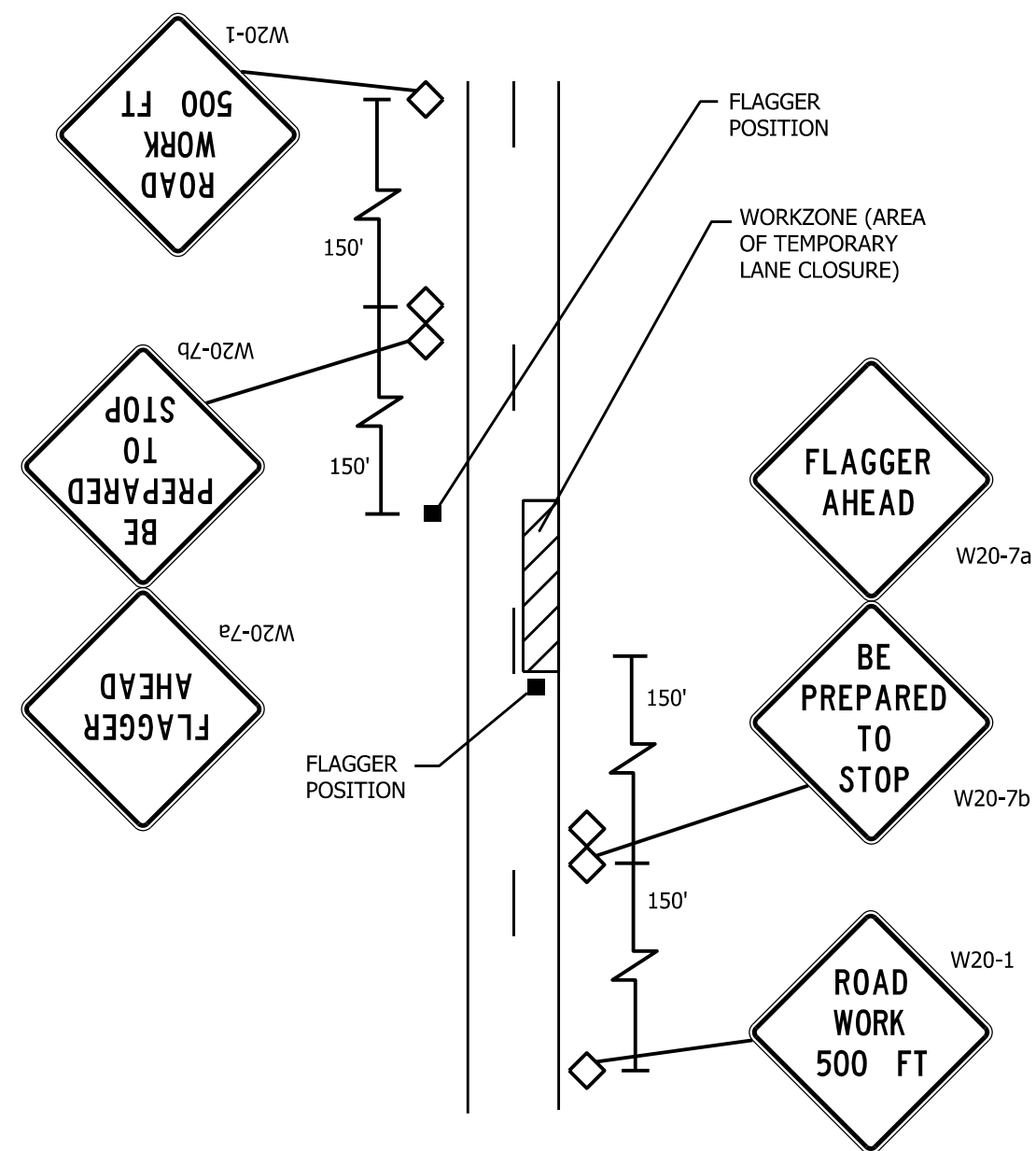

TYPICAL LANE RESTRICTIONS ON PUBLIC ROADS USING FLAGGER (IF NEEDED)

NOTE:  
DISTANCES SHALL BE ADJUSTED TO FIELD CONDITIONS WHERE SPACE IS LIMITED.  
FOR USE WHEN FULL CLOSURE AND POSTED DETOUR ARE NOT NECESSARY.

SPECIAL MAINTENANCE OF TRAFFIC CONDITIONS:

1. FULL ROAD CLOSURES ARE ONLY EXPECTED DURING ASPHALT PAVING IN THE STREET, INCLUDING CUSHION INSTALLATIONS. FLAGGER OPERATIONS SHALL BE USED FOR WORK AT EDGE AND OFF STREETS.
2. FULL CLOSURES SHALL CONSIST OF A SOFT CLOSURE AT PRIMARY CROSS STREETS. HARD CLOSURE SHALL BE AT WORK SITE, SET AS SHORT AS PRACTICABLE.

GENERAL REQUIREMENTS:

1. FLAGGER OPERATIONS AND TEMPORARY SIGNAGE IN ACCORDANCE WITH INDIANA MANUAL OF UNIFORM TRAFFIC CONTROL DEVICES ARE REQUIRED FOR ALL LANE RESTRICTIONS.
2. ALL SIGNS TO BE MOUNTED ON STANDARDS.
3. ALL SIGNS, BARRICADES AND DRUMS TO BE MOUNTED WITH A TYPE C (STEADY BURN) WARNING LIGHT AND MAINTAINED DUSK TO DAWN.

LONGVA-101 3:41:27 PM 5/13/2024 240 MOT001\_LONGVIEW.dgn



8720 Castle Creek Pkwy E Dr, Suite 400,  
Indianapolis, IN 46250  
<https://eticagroup.com>

FOR REVIEW ONLY

RECOMMENDED FOR APPROVAL	DESIGN ENGINEER	DATE
DESIGNED: BR	DRAWN: RBA	
CHECKED: MT	CHECKED: BR	

CITY OF BLOOMINGTON  
DEPARTMENT OF ENGINEERING

MAINTENANCE OF TRAFFIC PLAN

HORIZONTAL SCALE	ETICA GROUP
NTS	230240
VERTICAL SCALE	
	SHEET NUMBER
	X



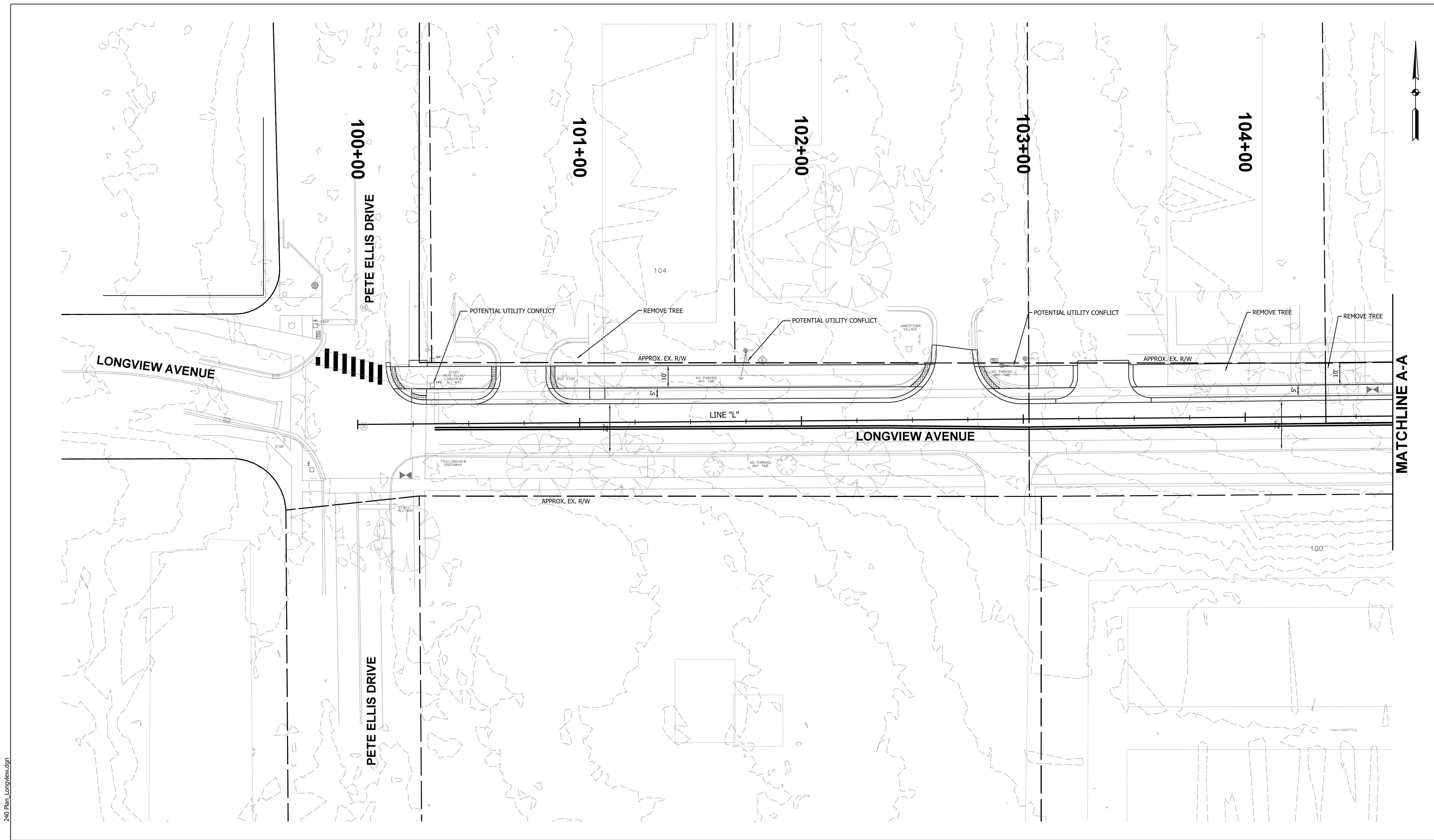

LONGV-101 3:41:32 PM 5/13/2024 240 Plan\_Longview.dgn



8720 Castle Creek Pkwy E Dr, Suite 400,  
 Indianapolis, IN 46250  
<https://eticagroup.com>

**FOR REVIEW ONLY**

RECOMMENDED FOR APPROVAL _____	DESIGN ENGINEER _____	DATE _____
DESIGNED: BR	DRAWN: RBA	
CHECKED: MT	CHECKED: BR	

**CITY OF BLOOMINGTON  
 DEPARTMENT OF ENGINEERING**

**NEIGHBORHOOD GREENWAY PLANS  
 LONGVIEW AVENUE**

HORIZONTAL SCALE 1"=20'-0"	ETICA GROUP 230240
VERTICAL SCALE N/A	
	SHEET NUMBER X





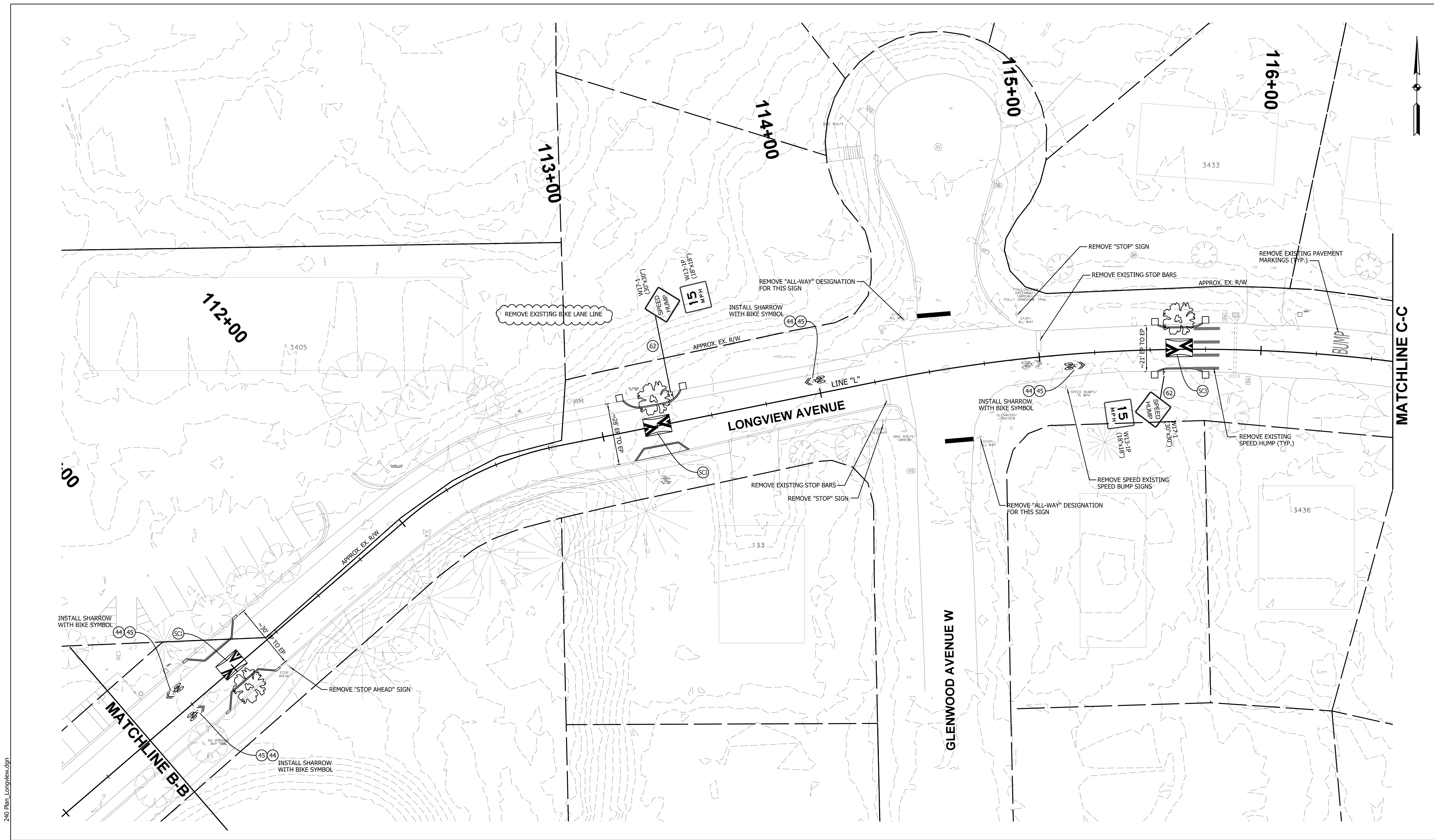

LONGV-103 3:41:33 PM 5/13/2024 240 Plan\_Longview.dgn



8720 Castle Creek Pkwy E Dr, Suite 400,  
Indianapolis, IN 46250  
<https://eticagroup.com>

**FOR REVIEW ONLY**

RECOMMENDED FOR APPROVAL _____	DESIGN ENGINEER _____	DATE _____
DESIGNED: BR	DRAWN: RBA	
CHECKED: MT	CHECKED: BR	

**CITY OF BLOOMINGTON  
DEPARTMENT OF ENGINEERING**

**NEIGHBORHOOD GREENWAY PLANS  
LONGVIEW AVENUE**

HORIZONTAL SCALE 1"=20'-0"	ETICA GROUP 230240
VERTICAL SCALE N/A	
	SHEET NUMBER X

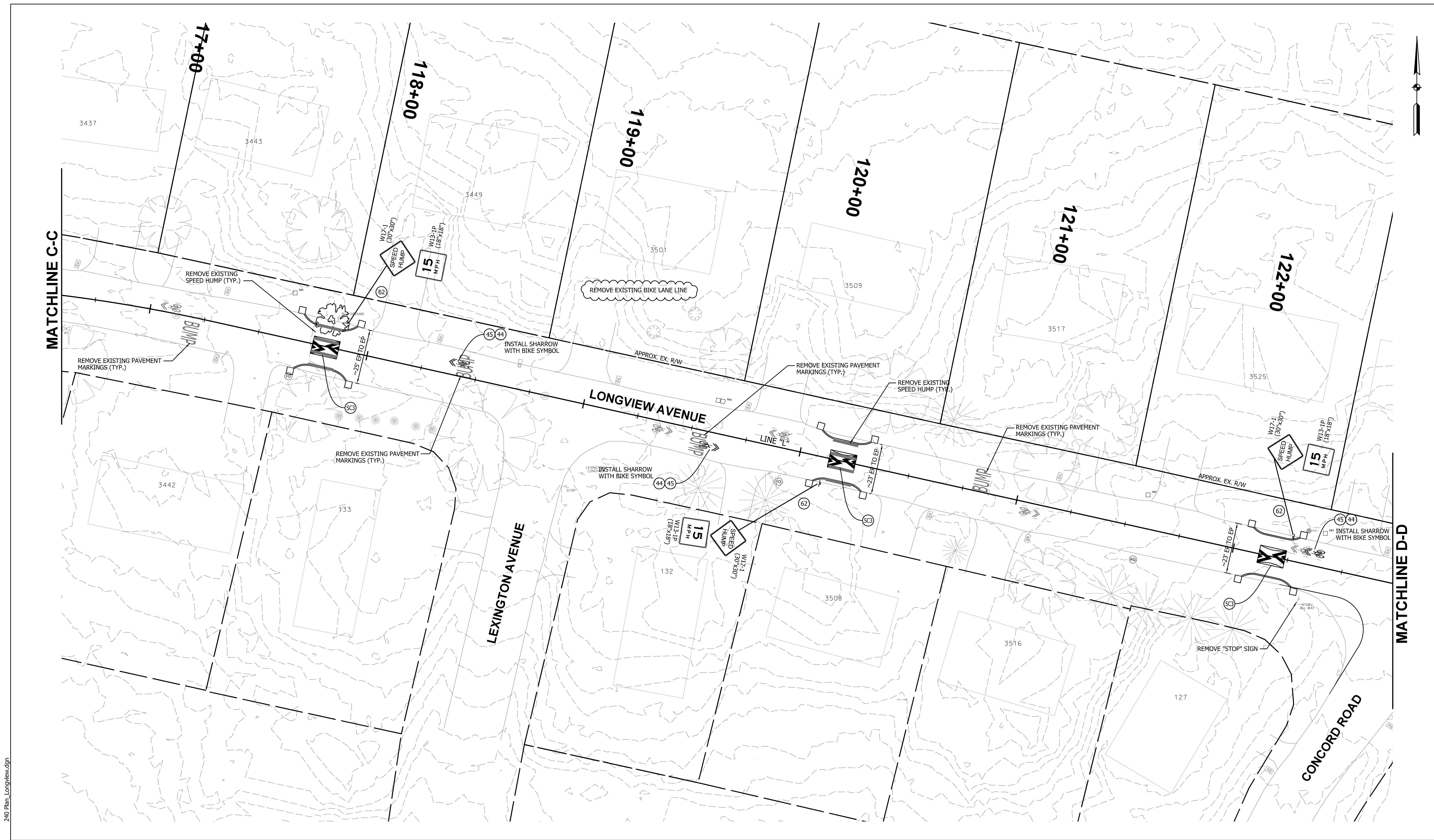

LONGV-104 3:41:34 PM 5/13/2024 240 Plan\_Longview.dgn



8720 Castle Creek Pkwy E Dr, Suite 400,  
Indianapolis, IN 46250  
<https://eticagroup.com>

**FOR REVIEW ONLY**

RECOMMENDED FOR APPROVAL _____	DESIGN ENGINEER _____	DATE _____
DESIGNED: BR	DRAWN: RBA	
CHECKED: MT	CHECKED: BR	

**CITY OF BLOOMINGTON  
DEPARTMENT OF ENGINEERING**

**NEIGHBORHOOD GREENWAY PLANS  
LONGVIEW AVENUE**

HORIZONTAL SCALE 1"=20'-0"	ETICA GROUP 230240
VERTICAL SCALE N/A	
	SHEET NUMBER X

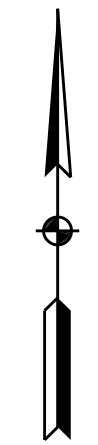
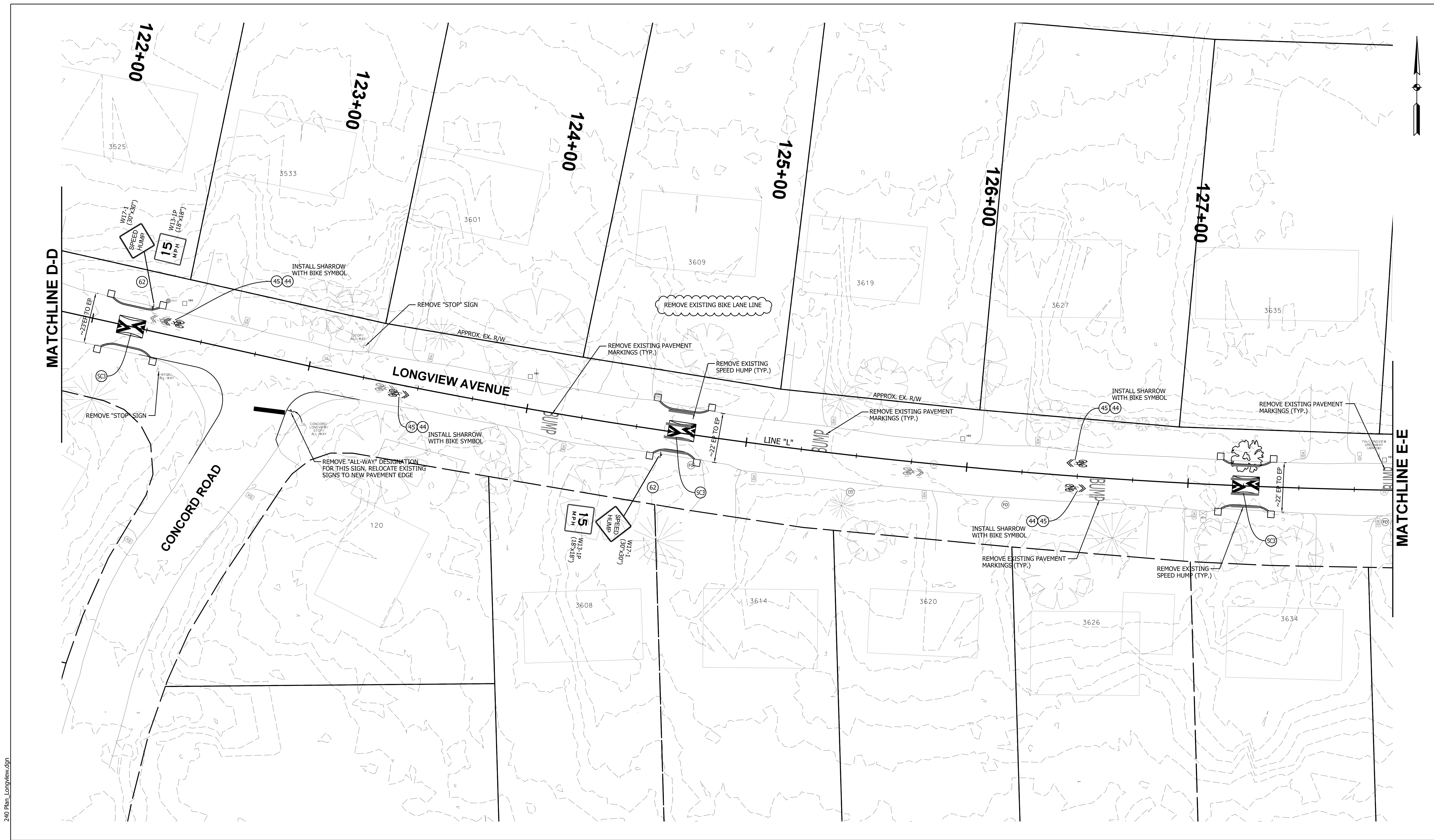

MATCHLINE D-D

MATCHLINE E-E

LONGV-105  
5/13/2024  
3:41:35 PM



8720 Castle Creek Pkwy E Dr, Suite 400,  
Indianapolis, IN 46250  
<https://eticagroup.com>

FOR  
REVIEW  
ONLY

RECOMMENDED FOR APPROVAL	DESIGN ENGINEER	DATE
DESIGNED: BR	DRAWN: RBA	
CHECKED: MT	CHECKED: BR	

CITY OF BLOOMINGTON  
DEPARTMENT OF ENGINEERING

NEIGHBORHOOD GREENWAY PLANS  
LONGVIEW AVENUE

HORIZONTAL SCALE	ETICA GROUP
1"=20'-0"	230240
VERTICAL SCALE	
N/A	
	SHEET NUMBER
	X

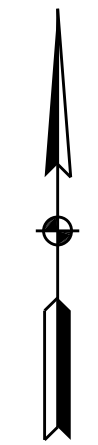

MATCHLINE E-E

MATCHLINE F-F

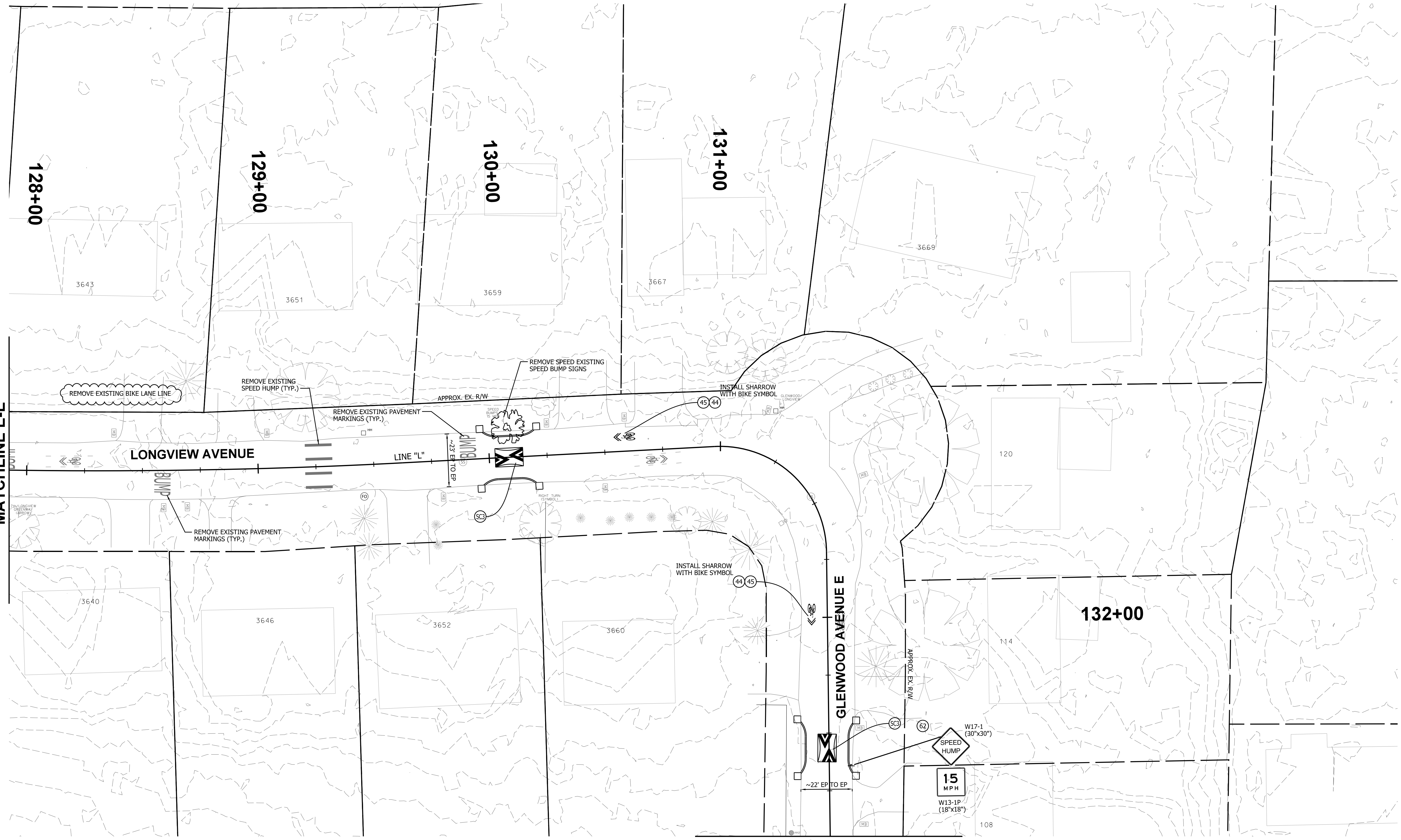

LONGV-106 3:41:35 PM 5/13/2024 240 Plan\_Longview.dgn



8720 Castle Creek Pkwy E Dr, Suite 400,  
Indianapolis, IN 46250  
<https://eticagroup.com>

<b>FOR REVIEW ONLY</b>	RECOMMENDED FOR APPROVAL _____	DESIGN ENGINEER _____	DATE _____
	DESIGNED: BR	DRAWN: RBA	
	CHECKED: MT	CHECKED: BR	

CITY OF BLOOMINGTON  
DEPARTMENT OF ENGINEERING

NEIGHBORHOOD GREENWAY PLANS  
LONGVIEW AVENUE

HORIZONTAL SCALE	ETICA GROUP
1"=20'-0"	230240
VERTICAL SCALE	
N/A	
	SHEET NUMBER
	X

MATCHLINE F-F

133+00

135+00

136+00

134+00

137+00

138+00

139+00

GLENWOOD AVENUE E

MEADOWBROOK DRIVE

MORNINGSIDE DRIVE

HERITAGE ROAD

MATCHLINE G-G

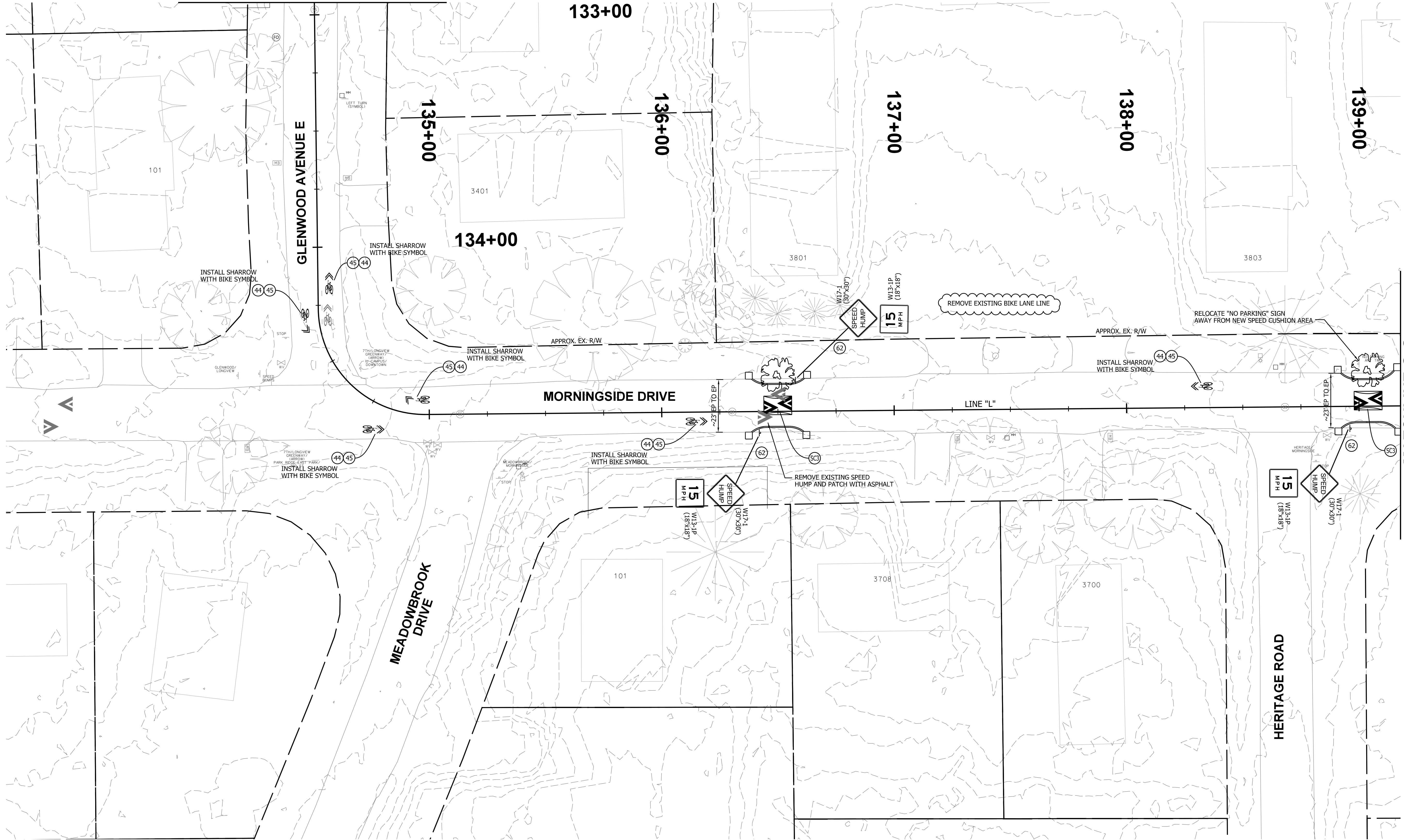

240 Plan\_Longview.dgn

LONGV-107  
5/13/2024  
3:41:36 PM



8720 Castle Creek Pkwy E Dr, Suite 400,  
Indianapolis, IN 46250  
<https://eticagroup.com>

FOR REVIEW ONLY

RECOMMENDED FOR APPROVAL	DESIGN ENGINEER	DATE
DESIGNED: BR	DRAWN: RBA	
CHECKED: MT	CHECKED: BR	

CITY OF BLOOMINGTON  
DEPARTMENT OF ENGINEERING

NEIGHBORHOOD GREENWAY PLANS  
LONGVIEW AVENUE

HORIZONTAL SCALE	ETICA GROUP
1"=20'-0"	230240
VERTICAL SCALE	
N/A	
	SHEET NUMBER
	X

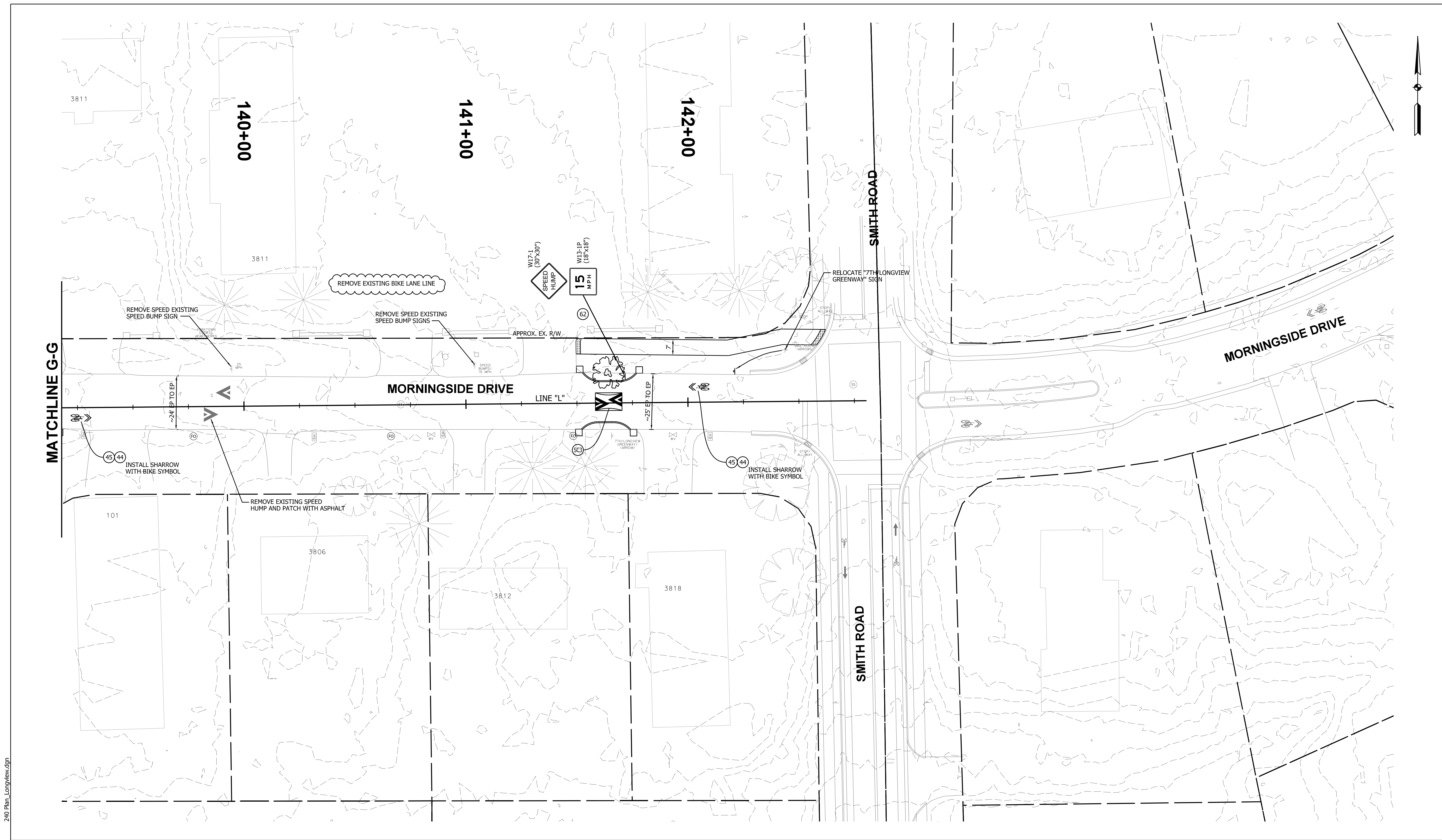

8720 Castle Creek Pkwy E Dr, Suite 400,  
 Indianapolis, IN 46250  
<https://eticagroup.com>

FOR REVIEW ONLY

RECOMMENDED FOR APPROVAL _____	DESIGN ENGINEER _____	DATE _____
DESIGNED: BR	DRAWN: RBA	
CHECKED: MT	CHECKED: BR	

CITY OF BLOOMINGTON  
 DEPARTMENT OF ENGINEERING

NEIGHBORHOOD GREENWAY PLANS  
 LONGVIEW AVENUE

HORIZONTAL SCALE 1"=20'-0"	ETICA GROUP 230240
VERTICAL SCALE N/A	
	SHEET NUMBER X

LONGV-108 3:41:37 PM 5/13/2024 240 Plan\_Longview.dgn