

To Whom it Concerns,

August 22, 2014

The purpose of this letter is two-fold.

First, I'd like for this to be my formal complaint against the property at 808 S. Fess. For years now, this property has had a junk car, large rat infested pile of rocks, black plastic nailed on the house, scrap lumber and six foot tall weeds that attempt to hide all of the above—in summer. Many, but not all, of this trash can be seen from the adjacent alley. Please see the enclosed diagram/photo.

Secondly, I give written permission to HAND to enter my property (616 E. First Street) at the driveway to look into the backyard of 808 S. Fess.

The property at 620 E. First Street is currently for sale and is being negatively impacted on the junk lot behind them. I will want to sell my property in a year or two and hope my neighbor's several eyesores are gone by then.

Thank you for your help.

Sincerely,



David Shaw

RECEIVED  
AUG 25 2014

BY:.....

RECEIVED  
AUG 25 2014

BY:.....

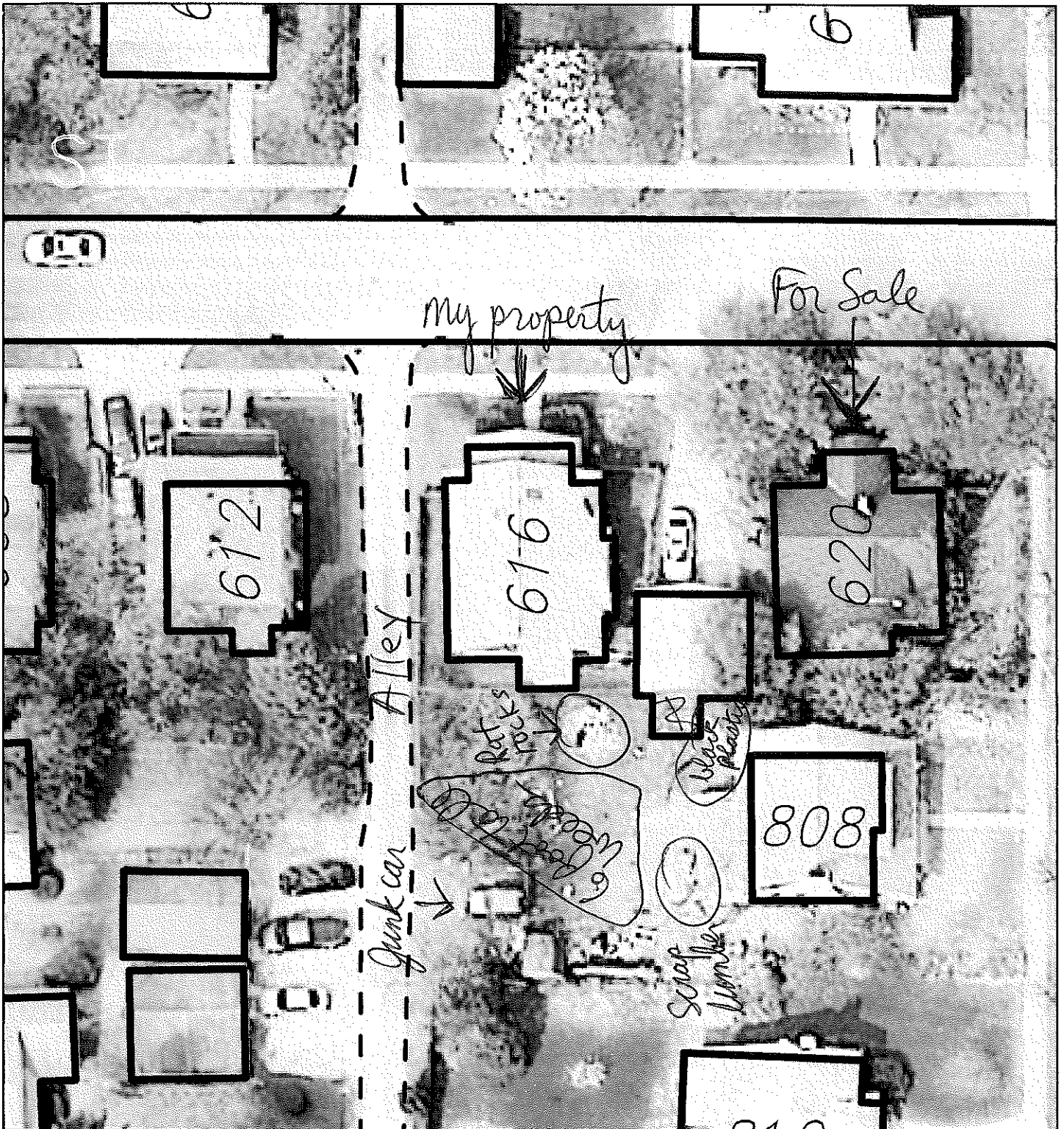

616 E 1st Street

By: stierm  
16 Apr 14

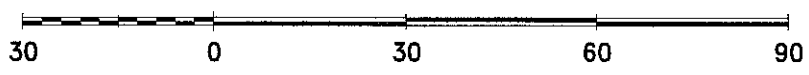

City of Bloomington  
ITS

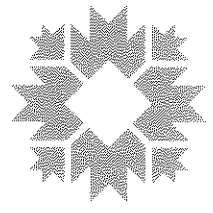

Scale: 1" = 30'

For reference only; map information NOT warranted.