

Passed: 6-0

Pierce absent

Banach, Young out of chambers

RESOLUTION 97-22

**TO ADOPT A WRITTEN FISCAL PLAN AND TO ESTABLISH A POLICY FOR
THE PROVISION OF CITY SERVICES TO AN ANNEXED AREA
(Gentry Honours Area)**

WHEREAS, the City of Bloomington desires to annex the area known as Gentry Honours Area, which is more specifically described in Ordinance 97-46; and

WHEREAS, responsible planning and state law require adoption of a fiscal plan and a definite policy for the provision of City services to the annexed areas; and

WHEREAS, such a plan has been developed and presented to the Common Council, entitled, "Fiscal Plan, Annexation of Gentry Honors Area";

NOW, THEREFORE, BE IT HEREBY RESOLVED BY THE COMMON COUNCIL OF THE CITY OF BLOOMINGTON, MONROE COUNTY, INDIANA, THAT:

1. The Common Council of the City of Bloomington, Monroe County, Indiana, hereby approves and adopts the Fiscal Plan, Annexation of Gentry Honours Area, which plan is attached hereto and made a part hereof, and hereby approves and adopts the specific policies for implementation of the plan as set out therein.

2. Any monies necessary for the provision of services as described and itemized in the attached plan shall be budgeted and appropriated from the applicable fund, pursuant to state law and the City's budget procedure.

3. It is anticipated that this annexation will not result in the elimination of jobs for employees of other governmental entities, but in the event it does, then the Director of Employee Services of the City of Bloomington is hereby directed to assist such employees in obtaining new employment, but nothing herein shall require the City to hire any such employees.

PASSED and ADOPTED by the Common Council of the City of Bloomington, Monroe County, Indiana, upon this 19 day of November, 1997.

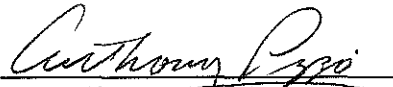
ANTHONY PIZZO, President
Bloomington Common Council

ATTEST:

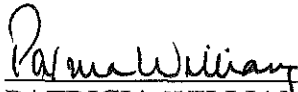
PATRICIA WILLIAMS, Clerk
City of Bloomington

PRESENTED by me to the Mayor on this 19 day of November, 1997.

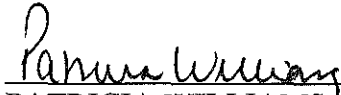
PATRICIA WILLIAMS, Clerk
City of Bloomington

SIGNED and APPROVED by me upon this 19 day of November, 1997.

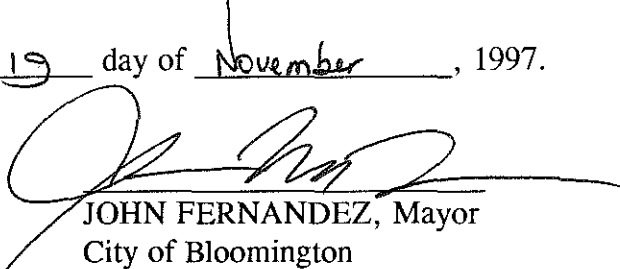
JOHN FERNANDEZ, Mayor
City of Bloomington

Passed:

SYNOPSIS

This resolution requests approval of the Fiscal Plan for the annexation of Gentry Honours Area. A fiscal plan, which is required by state law, outlines a schedule for the implementation of the various services the City will provide to the annexed area.

FISCAL PLAN
ANNEXATION OF
GENTRY HONOURS, PHASE ONE
RESOLUTION 97-22

8.08 STREET LIGHTS	11
8.09 SIDEWALKS	11
8.10 RESIDENTIAL RENTAL INSPECTION	11
8.11 HOUSING DEVELOPMENT SERVICES	12
8.12 ORDINANCE AND NUISANCE ENFORCEMENT SERVICES	12
8.13 NEIGHBORHOOD DEVELOPMENT SERVICES	13
8.14 POLICE PROTECTION	13
8.15 FIRE PROTECTION	15
8.16 ANIMAL SHELTER/ANIMAL CONTROL	16
8.17 REFUSE COLLECTION	18
8.18 PARKS AND RECREATION	18
8.19 COMMUNITY AND FAMILY RESOURCES	19
8.20 PLANNING, ZONING, PLAN REVIEW AND PLAN COMPLIANCE	20
8.21 ADMINISTRATIVE SERVICES	21
8.22 OTHER CITY FUNCTIONS	22
9.00 HIRING PLAN	22
10.00 SUMMARY OF COSTS	23

ANNEXATION OF GENTRY HONOURS, PHASE ONE

INTRODUCTION

The following Fiscal Plan, developed through the cooperative efforts of the City of Bloomington's Controller's Office, Planning Department, Engineering Department, Legal Department, Fire Department, Police Department, Street Department, Sanitation Department, Department of Public Works, Housing and Neighborhood Development Department, Utilities Department, Animal Shelter, Parks and Recreation Department, Community and Family Resources Department, and Employee Services Department represents the City's policy and procedure for the annexation of the following property: GENTRY HONOURS, PHASE ONE.

The cost estimates of the planned services to be furnished, methods of financing, and plan for the organization and extension of services to the Annexation Area are fully discussed. In addition, information is provided to compare the services proposed for the Annexation Area with other areas within the City's corporate boundaries with similar topography, patterns of land use and population density.

Effective Date

Indiana Code 36-4-7(c) provides that when a municipality annexes territory which lies wholly or partly within a fire protection district, the annexation ordinance takes effect on the second January 1 that follows the date the ordinance is adopted. Because the Annexation Area lies within the Perry-Clear Creek Fire District, the effective date of this ordinance would normally be January 1, 1999. However, Indiana Code 36-4-7(b) provides that annexations may not take effect during the year preceding a year in which a federal decennial census is conducted and instead such annexations will take effect January 2 of the year of the census. Pursuant to Indiana Code 36-4-3-7(d) and (b), this ordinance shall take effect on January 2, 2000.

1.00 LOCATION

Annexation Area

The Annexation Area lies in Perry Township section 1. The Annexation Area is contiguous to the City along 53% of its boundary. A copy of the Annexation Area contiguity calculation is attached and incorporated herein as Exhibit 2. The Annexation Area is located in the eastern part of the city. Certified copies of the City Ordinances documenting the City corporate boundaries are attached herein as Exhibit 3.

There are approximately 27 acres of land within the boundaries of the Annexation Area.

2.00 TOPOGRAPHY

The Annexation Area has slopes in the range of 2 to 12%. A more thorough analysis of the terrain and an analysis of soil types is attached and incorporated herein as Exhibit 4.

- d. Population Density: The Annexation Area will have approximately 163 people living on 27 acres for a density of 6.0 persons per acre.

Comparable Area I: Portion of Gentry Estates

- a. Location: Comparable Area I is bordered by S. Greywell Dr. on the west, E. Whitely Dr. on the north, S. Knight Ridge Rd. on the east, and E. Gentry Blvd. on the south.
- b. Topography: Comparable Area I has slopes of 2% to 12%.
- c. Patterns of land use: Comparable Area I is used for residential purposes. It is zoned Planned Unit Development.
- d. Population Density: Comparable Area I has approximately 153 people living on 24 acres for a density of 6.4 persons per acre.

Comparable Area II: Portion of Park Ridge East

- a. Location: Comparable Area II is bordered by E. Saratoga Dr., on the south and west, E. Morningside Dr. on the north, and Park Ridge Road on the east.
- b. Topography: Comparable Area II has slopes of 2-6%.
- c. Patterns of land use: Comparable Area II is used for residential purposes. It is zoned Single-Family Residential (RS3.5).
- d. Population Density: Comparable Area II has 139 people living on 25 acres for a density of approximately 5.6 persons per acre.

6.00 GENERAL RELATIONSHIP TO CITY SERVICES

The Annexation Area is located in the eastern part of the City. The relationship between the Annexation Area and existing incorporated city territory is shown on the map previously incorporated as Exhibit 1. City services are currently being provided to the City areas that border the Annexation Area.

The Annexation Area currently receives fire protection from the Perry-Clear Creek Fire District. Upon annexation, the City will provide this service. City parks are already easily accessible to the Annexation Area. The Annexation Area already has access to the City's planning and zoning services and to the City's recreational and social service programs. The City currently provides water and sewer service to the Annexation Area. For the reasons stated above and the reasons elaborated below, annexation of this area is a logical extension of the City's corporate boundaries.

all existing dwellings in the Annexation Area. Sanitary sewer service will be extended to new dwellings by the developer.

8.02 WATER DISTRIBUTION

The City Water Utility is serving all existing dwellings in the Annexation Area. The map indicating the locations of the water mains currently in place is attached and incorporated herein as Exhibit 9. Utilities Service Board Rules, Regulations and Standards of Service for the City Water Utility are attached and incorporated herein as Exhibit 11.

Maps showing the water mains in the Comparable Areas are attached and incorporated herein as Exhibit 10. Water service in the Annexation Area and Comparable Areas is described as follows:

- Annexation Area: Existing dwellings in are served by publicly-owned ductile iron water mains of minimum 6" diameter. Water lines to new buildings will be provided by the developer.
- Comparable Area I: The water mains serving this area are publicly-owned ductile iron pipe of minimum 4" diameter.
- Comparable Area II: The water mains serving this area are publicly-owned clay pipe of minimum 6" diameter.

SUMMARY OF WATER FACILITIES

COST ESTIMATE OF PLANNED SERVICE: \$0

METHOD OF FINANCING: Not Applicable.

PLAN FOR ORGANIZATION AND EXTENSION OF SERVICE: Water service is provided to existing buildings in the Annexation Area in a manner equal to the Comparable Areas. Water lines to new buildings will be provided by the developer. The City will incur no cost for water services as a result of this annexation.

8.03 FIRE HYDRANTS

There are currently 7 fire hydrants available in the Annexation Area. The Comparable Areas each have fire hydrants installed according to the standards set by the Utilities Department, the Insurance Services Office, and the Ten States Standards incorporated herein as Exhibit 13. Generally, spacing varies between 350 and 600 feet, depending on these standards, with closer spacing required for industrial, commercial, and densely populated areas. The fire hydrant locations in the Comparable Areas are shown on the map attached and incorporated herein as Exhibit 12.

Fire hydrants are publicly-owned and maintained. The rental charges for publicly-owned hydrants are incorporated into the existing billing structure for water users within the City's corporate boundaries, as approved by Ordinance of the Bloomington Common Council and the Utilities Regulatory Commission. No General Fund expenses for fire hydrants will occur as a result of this annexation.

8.05 STREET AND ROAD CONSTRUCTION AND MAINTENANCE

Upon annexation, the City will assume responsibility for roads in dedicated public rights-of-way way within the Annexation Area once they meet any conditions of plan approval and City street construction standards and have been inspected by the Engineering Department and approved by the Board of Public Works. These roads will then be known as "public streets." Any other roads in the Annexation Area will remain private and will be privately maintained after annexation.

The City Street Department will maintain and periodically resurface the public streets in the Annexation Area in accordance with the City's preventive street maintenance program. The extension of these services to the Annexation Area will not require an increase in expenditures for equipment or for new personnel. However, it will result in increased operational expenses for materials and services. The cost estimate of these expenses is derived by dividing the budgeted materials expenses by the miles of city streets maintained. For the 1997 budget, materials expenses are as follows:

Line 233: Street, Alley, & Sewer Materials - \$545,000.
Line 431: Improvements Other Than Building - \$450,000.
These two items total \$995,000.

\$995,000 divided by 187.5 miles of city streets equals a yearly cost of \$5,307 per mile of street maintained. This \$5,307 multiplied by 0.7 miles (not lane miles) of public roadway in the Annexation Area equals a yearly maintenance cost of \$3,715.

SUMMARY OF STREET AND ROAD CONSTRUCTION AND MAINTENANCE

COST ESTIMATE OF MAINTENANCE: \$3,715.

METHOD OF FINANCING: MVH (Motor Vehicle-Highway), LRS (Local Road & Street), & CUM CAP (Cumulative Capital) funds for the annual expense.

PLAN FOR ORGANIZATION AND EXTENSION OF SERVICES: Upon annexation, the City will assume responsibility for roads in dedicated public rights-of-way way within the Annexation Area once they meet any conditions of plan approval and City street construction standards, and have been inspected by the Engineering Department and approved by the Board of Public Works. These roads will then be known as "public streets." Any other roads in the Annexation Area will remain private and will be privately maintained after annexation. Public streets in the Annexation Area will be repaired and maintained by the City in accordance with established policies. Funding will be provided for by the City's general street repair and maintenance funds.

8.06 STREET AND ROAD SERVICES

Upon annexation, the City will begin providing Street Department services to roads in dedicated public rights-of-way within the Annexation Area once they meet any conditions of plan approval and City street construction standards, and have been inspected by the Engineering Department and approved by the Board of Public Works. These roads will then be known as "public streets." Any other roads in the Annexation Area will remain private and will be privately maintained after annexation.

The services the City Street Department will extend to public streets in the Annexation Area includes routine pavement sweeping, routine leaf collection in residential areas, and snow and ice removal

SUMMARY OF STREET AND ROAD SERVICES

COST ESTIMATE OF SERVICE: \$5,121

METHOD OF FINANCING: Motor Vehicle Highway Fund.

PLAN FOR ORGANIZATION AND EXTENSION OF SERVICES: Regular street and road services will begin immediately on public streets upon annexation on an as-needed basis, due to factors such as weather and public safety. Service activities for public streets include street sweeping, residential leaf collection, and snow and ice removal.

8.07 STREET SIGNS AND TRAFFIC SIGNALS

Street signs and traffic signals in the Annexation Area will be installed by the developer according to City policy regarding the location and installation of traffic control and street signs. Street sign and traffic signal maintenance and replacement services will be extended to public streets in the Annexation to a level at least equal with the Comparable Areas. The street signs in the Comparable Areas are recorded on the map that was previously incorporated as Exhibit 12. The City policy on street signs fulfills the requirements contained in the "Indiana Manual on Uniform Traffic Control Devices" and in the Bloomington Municipal Code Book. Both of these volumes describe conditions under which each type of sign is to be installed; the City Engineer recommends sign placement to the Traffic Control Commission accordingly. Street Signs and Traffic Signals in the Annexation Area and the Comparable Areas are listed below:

- Annexation Area: Installation of signs and pavement markings according to City standards is the responsibility of the developer.
- Comparable Area I: Has all necessary street and road signs.
- Comparable Area II: Has all necessary street and road signs.

Yearly maintenance costs to the City for signs on public streets in the Annexation Area is as follows: Replacement every 8 years. Cost to be determined when the City assumes responsibility for the Annexation Area.

SUMMARY OF STREET SIGNS AND TRAFFIC SIGNALS

COST ESTIMATE OF PLANNED SERVICES: \$0

METHOD OF FINANCING: Not Applicable.

PLAN FOR ORGANIZATION AND EXTENSION OF SERVICES: Installation of signs and pavement markings according to City standards in the Annexation Area are the responsibility of the developer. Street sign services on public streets will begin immediately upon annexation and will be performed on an as-needed basis. Maintenance of the existing signage within the Annexation Area will become part of the City's sign maintenance program. Funding will be provided for by the appropriate Traffic Division Funds.

METHOD OF FINANCING: Not Applicable.

PLAN FOR ORGANIZATION AND EXTENSION OF SERVICES: As there are no residential rental units within the Annexation Area, no extension of services is planned in the Annexation Area.

8.11 HOUSING DEVELOPMENT SERVICES

The Housing and Neighborhood Development Department administers programs for the implementation of Community Development Block Grants available to the City through the Federal Department of Housing and Urban Development. The annual grant amount is determined by the Federal Government and may be disbursed at the City's discretion among various eligible activities.

During fiscal year 1996 (May 1996 through May 1997), the City received Community Development Block Grants totaling \$1,105,000 which will be allocated to various projects including rehabilitation of housing for low-moderate income families on a city-wide basis, small scale drainage projects and site improvements in targeted low-income areas, economic development activities, various public service programs, and a utility service program for low-moderate income families.

The amount of funds allocated to each Community Development Block Grant program is fixed and is disbursed as eligible applicants and projects utilize the funds. For this reason, annexation will not result in any additional costs to these programs.

SUMMARY OF HOUSING DEVELOPMENT SERVICES

COST ESTIMATE OF SERVICE: \$0

METHOD OF FINANCING: Not Applicable.

PLAN FOR PROVISION OF SERVICES: Property Owners will be able to apply for any of the other Community Development Block Grant Programs for which they may be eligible under program rules.

8.12 ORDINANCE AND NUISANCE ENFORCEMENT SERVICES

The Housing and Neighborhood Development Department provides ordinance enforcement to the area on a compliance basis. Also, nuisance enforcement will be provided for things like weeds, trash and other types of nuisances on both a regular patrol and on an as-needed basis. This service is performed by salaried staff and extension of service to the Annexation Area will not result in any additional expenditures.

SUMMARY OF ORDINANCE AND NUISANCE ENFORCEMENT SERVICES

COST ESTIMATE OF SERVICE: \$0

METHOD OF FINANCING: Not Applicable.

PLAN FOR PROVISION OF SERVICES: Immediately upon annexation, the Housing and Neighborhood Development Department will extend ordinance and nuisance enforcement in a manner consistent with all areas within the corporate limits.

Traffic Enforcement	13%	(1 hour 4 minutes)
Accident Investigation	11%	(50 minutes)
Criminal Investigation	12%	(59 minutes)
Pro-active Patrol	45%	(3 hours 35 minutes)

Pro-active patrol serves several purposes. The primary purpose of patrol is to prevent crime. The function of detection and apprehension of offenders is closely related to the crime prevention function of patrol. Also, patrol promotes safe movement of vehicular and pedestrian traffic by enforcing traffic and parking laws. In addition, the general well-being of the community is enhanced by officers on patrol doing the following: reporting traffic control devices out of service, icy road conditions, location of water or power outages, and fires; rendering aid to the injured; and directing citizens in need to the services of other agencies such as the welfare department, ambulance, or other departments within the city.

In order to be effective, pro-active patrol must be random. To patrol on a set schedule would result in officers' movements becoming predictable, reducing their effectiveness. While engaged in pro-active patrol, officers are available for immediate dispatch to a call for service. In this way, officers would be able to respond to the additional calls anticipated by the Annexation Area. However, responding to additional calls will reduce the percentage of time spent in pro-active patrol, unless additional time is provided either through additional staff or through overtime.

It is a City priority not to decrease pro-active patrol time. So that this annexation will not diminish time for pro-active patrol by increasing the work load within the same number of work hours, additional funds for overtime are included in this Plan.

The service demands expected from the Annexation Area have been estimated by a review of calls from the Comparable Areas in the following chart:

COMPARABLE AREAS POLICE CALL RESPONSE CHART

<u>Area</u>	<u>1996 Calls</u>	<u>Est Population</u>	<u>Calls per Person</u>
Comparable I	3	153	0.02
Comparable II	<u>23</u>	<u>139</u>	<u>0.17</u>
Total:	26	292	0.09

The Annexation Area will have an estimated population of 163. Using the average number of calls per person in each of the Comparable Areas, the number of calls anticipated for the Annexation Area is 15.

The Police Department estimates that each call uses approximately 48 minutes of an officer's time. Therefore, the total additional time needed to respond to calls from the Annexation Area is 720 minutes, or 12.0 hours.

The additional time needed for calls from the Annexation Area can be provided for in any one of 3 ways. The time could be subtracted from pro-active patrol. Since the City has as a priority that pro-active patrol time not be reduced, this option is not applied in this Plan. The second option would be to hire an additional officer.

The third and selected option is to provide for overtime for current officers to respond to the increase in calls. According to the Fraternal Order of Police (FOP) contract in effect with the City, overtime must

The cost of materials that are needed to provide Fire Protection for the Annexation Area is estimated by using the 1997 budgeted amount of \$77,292 for operational expenses. This is composed of the following line items: Line 223 - Garage & Motor Supplies: Line 224 - Fuel & Oil: Line 232 - Motor Vehicle Repair: Line 242 - Other Supplies: Line 362 - Motor: and Line 365 - Other Repairs.

That amount divided by the total number of fire runs made in 1996 is:

\$77,292 divided by 1,610 runs = \$48 cost per run
\$48 x 1 additional runs = \$48 additional cost for Fire Department services

There is ample time for the Fire Department staff to respond to 1 additional run per year. When added to the 1,610 runs in 1996, this is still less than one run per day for the primary responding station (and less than 1 additional run for the secondary responding station):

365 days x 5 stations = 1,825 station response days
1,610 runs in 1996 + 1 run anticipated from the Annexation Area = 1,611
1,611 runs divided by 1,825 days = 0.88 runs per day per station

Staff is already on payroll with time available to operate the 5 stations for 24 hours a day, 365 days per year. Thus, service will be provided using existing staff and equipment, and with additional funds to make the runs anticipated in serving the Annexation Area to the same standard and scope as the Comparable Areas are served.

SUMMARY OF FIRE PROTECTION

COST ESTIMATE OF SERVICE: \$48

METHOD OF FINANCING: General Fund.

PLAN FOR ORGANIZATION AND EXTENSION OF SERVICE: Immediately upon annexation, full fire protection service on a first call basis will be provided to the Annexation Area.

8.16 ANIMAL SHELTER/ANIMAL CONTROL

The City of Bloomington provides two types of services related to animals. The Animal Shelter function involves a facility where animals are sheltered, cared for and, if necessary, humanely euthanized. The Animal Control function involves serving the community with regular patrol, investigation of complaints, education, and emergency services.

Animal Control services are provided only within the corporate City limits at the present time. Immediately upon annexation, the following animal control services will be provided to the Annexation Area:

- Three full time animal control officers will be available 8 AM to 8 PM Monday through Friday and from 8 AM to 5 PM on Saturday. These officers provide service contacts including pickup of stray, injured or dead animals; investigation of complaints, assistance with bite cases; and issuance of citations for violations of animal control ordinances.

those provided to comparable areas of the City. Additional funds are budgeted to provide the additional operating and overtime costs anticipated.

8.17 REFUSE COLLECTION

Upon annexation, the City will begin curbside refuse collection and recycling collection to the Annexation Area to the same standard and scope of service provided to all comparable areas within the City including the Comparable Areas.

Sanitation services that will be extended to the Annexation Area include refuse collection, yard waste collection, and recycling pickup.

Refuse and recycling collection services to the Annexation Area will be incorporated into existing collection areas. A map showing existing refuse collection routes is attached and incorporated herein as Exhibit 16. The Sanitation Department plans to add the Annexation Area to the Wednesday-B area.

Additional costs incurred resulting from the annexation will be in personnel, operating supplies, services, and landfill fees. The Sanitation Department reports that the annexation will not require additional funds for equipment.

The Director of Public Works estimates the net annual cost of sanitation services in the city to be \$103 per household. This cost multiplied by the 68 households anticipated in the Annexation Area comes to \$7,004 per year for sanitation services.

In addition, a one-time cost for recycling bins at \$6 per bin per household comes to \$408.

SUMMARY OF REFUSE COLLECTION

ONE-TIME COST ESTIMATE: \$408
COST ESTIMATE OF SERVICE: \$7,004

METHOD OF FINANCING: General Fund, Sanitation Fund.

PLAN FOR ORGANIZATION AND EXTENSION OF SERVICES: Upon annexation, the Annexation Area's single-family residences will receive curbside refuse collection, as well as periodic pickup of recyclable items. Service will be provided in a manner equivalent in standard and scope to the curbside service provided to all comparable areas in the City.

8.18 PARKS AND RECREATION

The City's Parks and Recreation Department offers a wide variety of organized activities including, but not limited to, passive recreation, recreational sports, competitive sports, sports instruction, holiday and seasonal celebrations, special events, seasonal playground programs, community programs, fitness training, and Older American programs. Some activities are free, and some involve a fee.

The Annexation Area is located within 2 miles of several City Parks and Recreation sites which together offer a wide range of opportunities. These distances are similar to those of the Comparable Areas from similar sites. A map noting the Parks and Recreation site locations and the locations of the

Nearly all Community and Family Resources Department programs are already available to the Annexation Area on the same basis as they are available to other areas in the City, including the Comparable Areas. Certain programs require specific client qualifications having to do with income, age, family circumstances, etc. Access to these programs for the Annexation Area residents is determined on the same basis as access for residents of other areas, including the Comparable Areas.

The two programs that are available only to city residents will be extended to the Annexation Area immediately upon annexation. Because these programs are supported by salaried staff, no new costs will be associated with extending these programs to the Annexation Area. Since the Annexation Area is otherwise already served to an equivalent standard and scope as the Comparable Areas, no other new service is proposed.

SUMMARY OF COMMUNITY AND FAMILY RESOURCES SERVICES

COST ESTIMATE OF SERVICE: \$0

METHOD OF FINANCING: Not Applicable.

PLAN FOR ORGANIZATION AND EXTENSION OF SERVICES: Most services are organized and in place for the Annexation Area to the same standard and scope offered to the Comparable Areas. Remaining services will be extended to the Annexation Area upon annexation with no additional cost.

8.20 PLANNING, ZONING, PLAN REVIEW AND PLAN COMPLIANCE

Planning, zoning, plan review, and plan compliance enforcement are performed by the Planning Department, and are currently being provided to all residents of the City of Bloomington and to the Areas Intended for Annexation. The Annexation Area is presently included within the Areas Intended for Annexation. A map showing the area to which these services are being provided is attached and incorporated as Exhibit 18.

The Planning Department reviews and approves site plans of proposed new construction to insure compliance with applicable regulations. Specific proposals such as variance requests, special exceptions, conditional use, rezoning requests, and public right-of-way vacations are reviewed and recommendations are forwarded to the Plan Commission, Board of Zoning Appeals and Common Council for their consideration. Additionally, the Planning Department conducts comprehensive planning and transportation studies.

As a portion of the unincorporated area within the municipal planning jurisdiction, the Annexation Area presently receives these services to the same standard and scope provided to all other areas of the City, including the Comparable Areas.

SUMMARY OF PLANNING , ZONING, PLAN REVIEW AND PLAN COMPLIANCE ENFORCEMENT SERVICES

COST ESTIMATE OF PLANNED SERVICE: \$0

METHOD OF FINANCING: Not Applicable.

same manner and scope that these services are provided to the Comparable Areas. Because the Annexation Area does not represent an increase in the City's population, these services will be extended without hardship to these administrative offices and departments, and without increased cost.

8.22 OTHER CITY FUNCTIONS

This Plan outlines all City services that will be impacted by the inclusion of the Annexation Area within the City's corporate boundaries.

Because the Annexation Area represents only a 0.26% increase in population, the effect of inclusion of this Area within the City limits will have minimal impact upon services not previously mentioned, such as Municipal Building maintenance.

Any services not specifically addressed in this report have not been omitted for lack of consideration. Rather, their absence indicates that provision of these services to the Annexation Area will be provided in the same manner that such services are provided to the Comparable Areas without the expenditure of additional funds.

In conclusion, therefore, it must be noted that any services currently available to the Comparable Areas which were not previously discussed in this Plan will be made available in the same manner to the Annexation Area immediately upon annexation.

OTHER CITY FUNCTIONS SUMMARY

COST ESTIMATE FOR PROVISION OF SERVICES: \$0

METHOD OF FINANCING: Not Applicable.

PLAN FOR ORGANIZATION AND EXTENSION OF SERVICES: Immediately upon annexation, any municipal services not previously discussed in this plan will be made available in the same manner to the Annexation Area as it is currently available to comparable areas of the City, including the Comparable Areas.

9.00 HIRING PLAN

It is not anticipated that this annexation will result in the elimination of jobs for employees of other governmental entities, but, in the event it does, the Director of Employee Services is directed to assist these employees in obtaining new employment. However, the City will not be required to hire any of these employees.

In the event of unforeseen elimination of jobs, the Employee Services Director will take the application of any such employee and maintain a special file of these applications. Each application will be forwarded to major employers in the area, and to any City department having a job opportunity for which the individual is qualified. Each individual will also be referred to the Indiana State Employment Security Division.

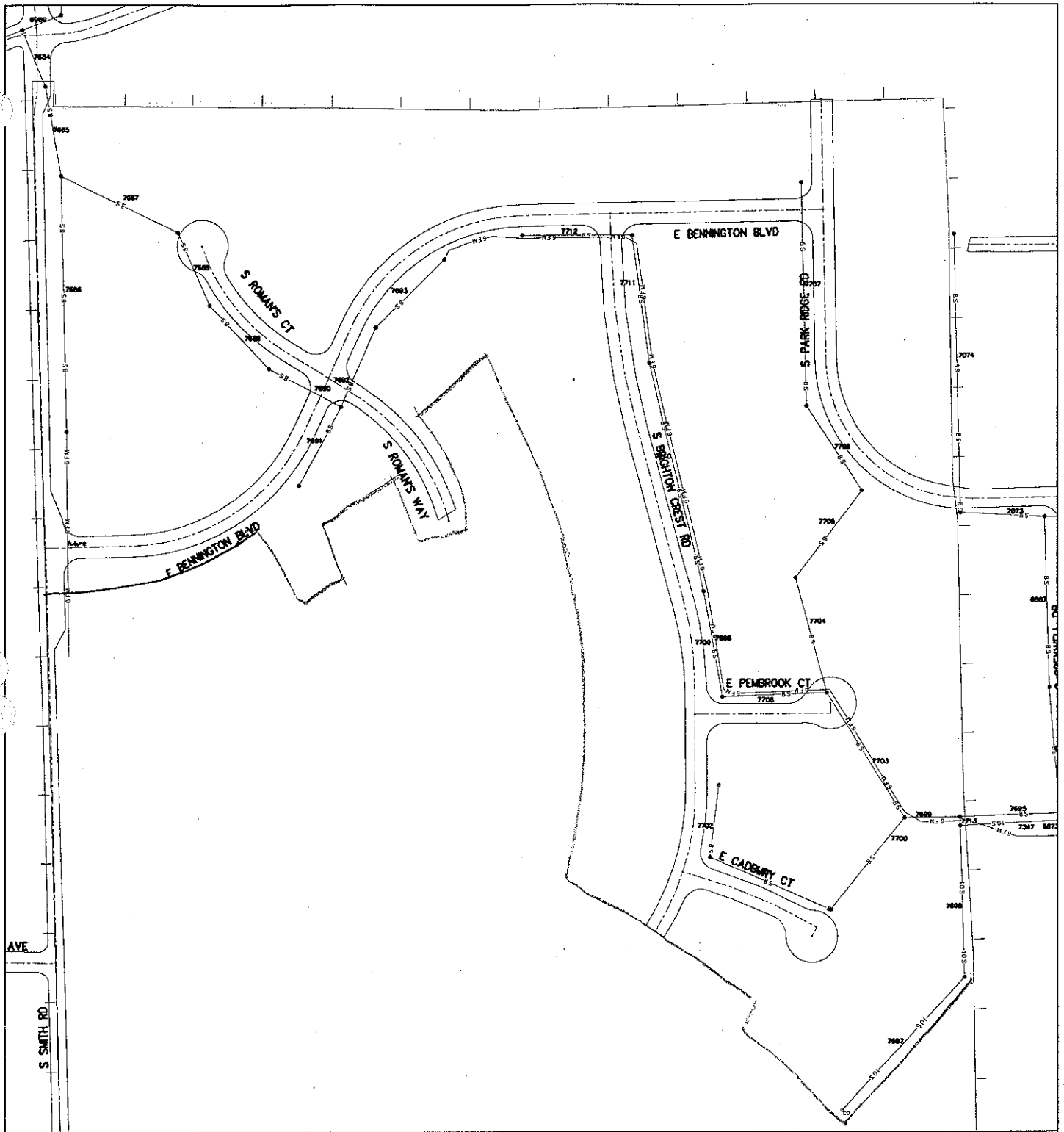

1997 Annexation Areas
 Gentry Honours, Phase One
 Exhibit 9. Sewer Mains

By: mearsl
 24 Oct 97

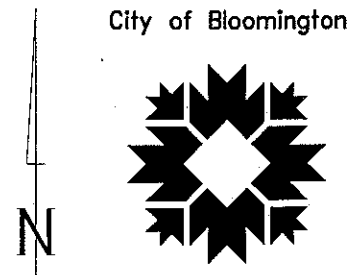
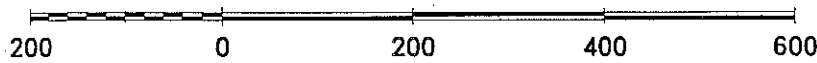

Scale: 1" = 200'

For reference only; map information NOT warranted.

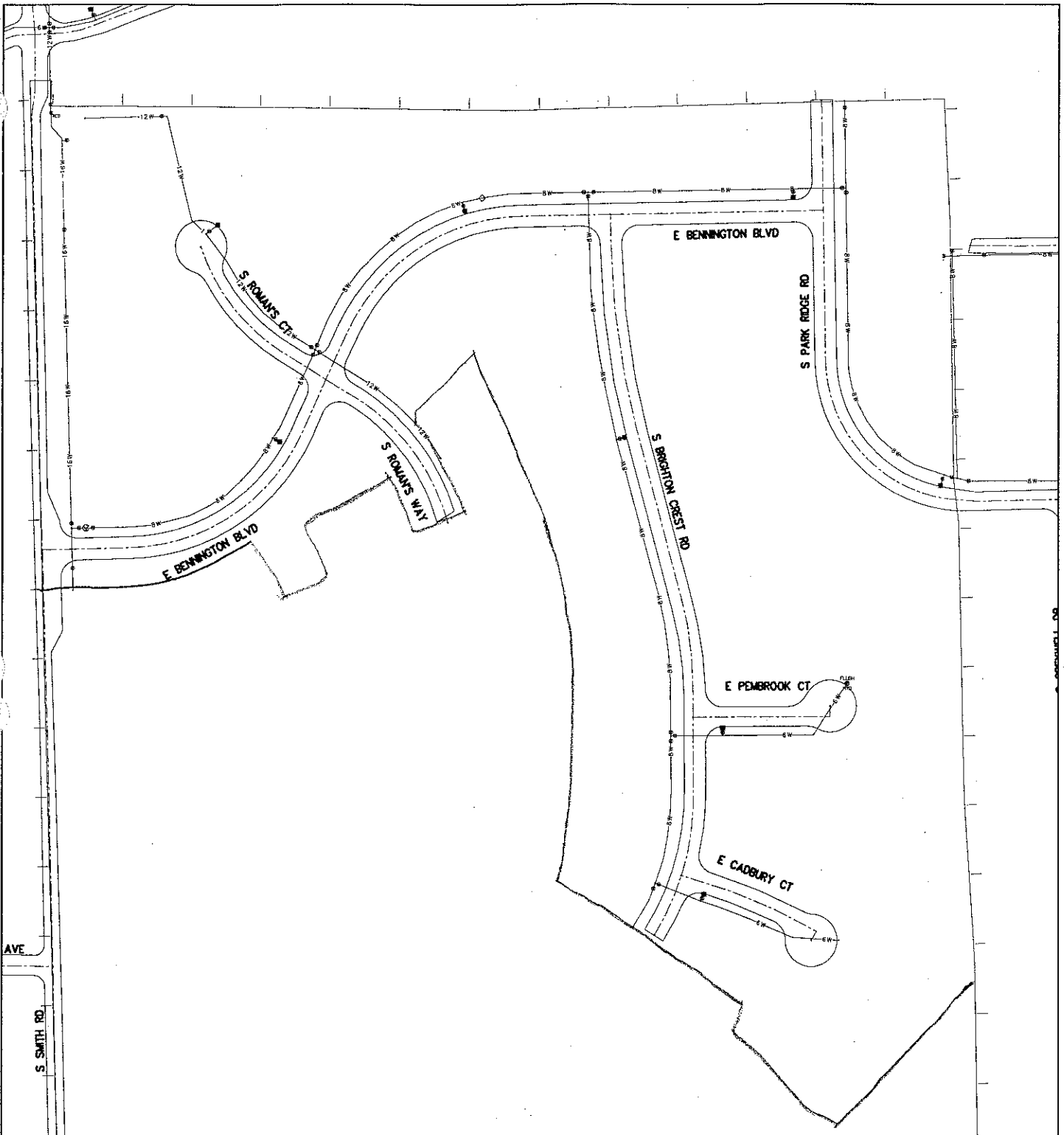

1997 Annexation Areas
 Gentry Honours, Phase One
 Exhibit 9. Water Lines

By: mearsl
 24 Oct 97

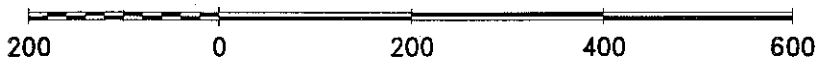

City of Bloomington

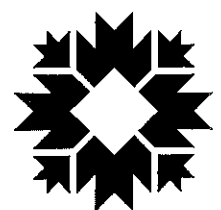

Scale: 1" = 200'

For reference only; map information NOT warranted.