

# CITY OF BLOOMINGTON, INDIANA

## 17TH STREET (LISMORE DRIVE TO MONROE STREET)

### VERTICAL PROFILE

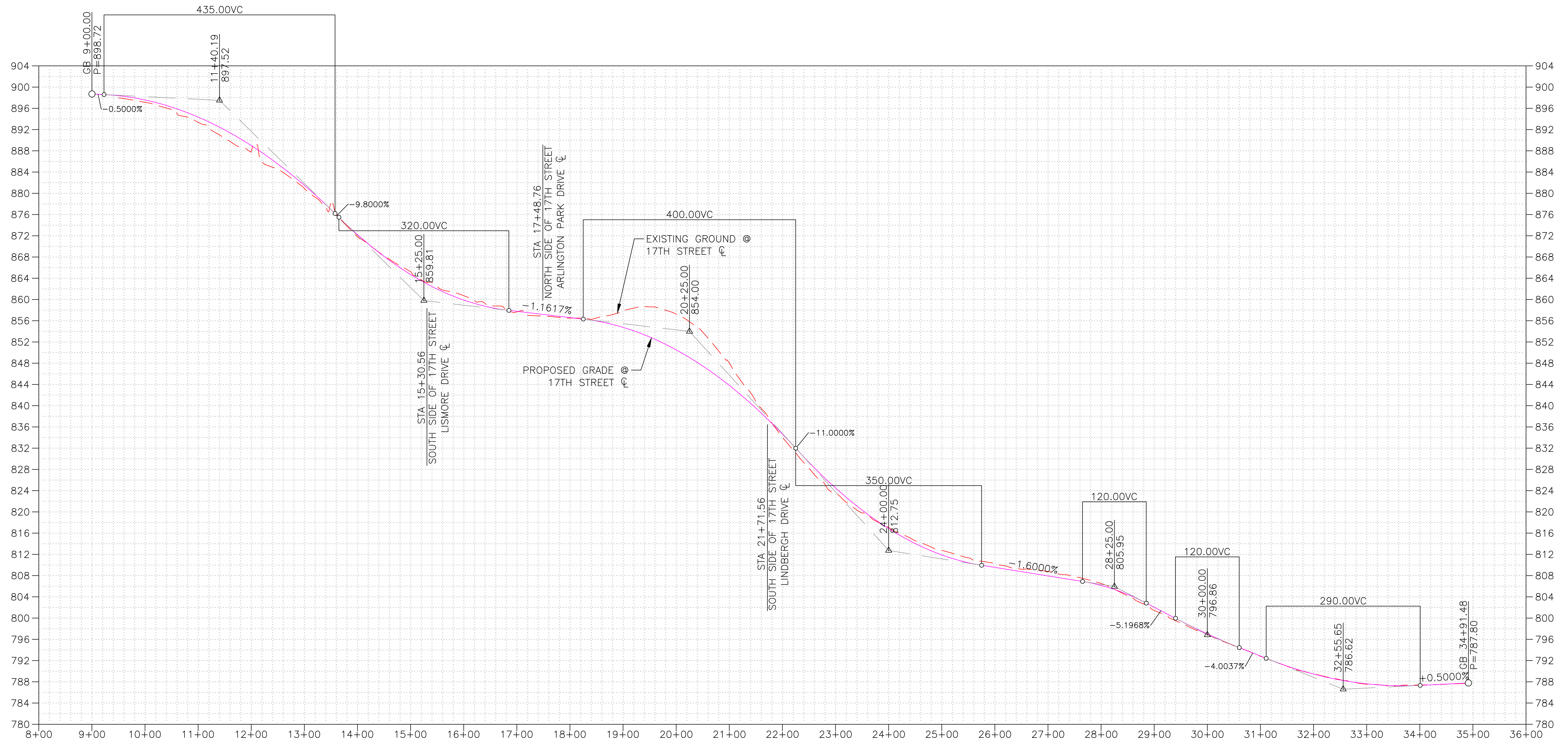

#### LEGEND

- PROPOSED GRADE AT 17TH STREET C
- - - EXISTING GROUND AT 17TH STREET C

**AZTEC**

320 W. 8th Street, Suite 100  
 Bloomington, IN 47404  
 Tel(812)717-2555  
 Fax(812)333-3941  
 www.aztec.us

