

The Pavilion at



SWITCHYARD PARK
BLOOMINGTON INDIANA

For rental information, or to make a
reservation, contact:

Hsiung Marler, General Manager

812.349.3742

marlerh@bloomington.in.gov



SWITCHYARD PARK

BLOOMINGTON INDIANA

NOW OPEN!
5 a.m.-11 p.m. daily

The 57.2-acre Switchyard Park, formerly known as the McDoel Switchyard, served as a hub for railroad operations for a series of companies including the New Albany and Salem Railroad, the Monon Railroad, and eventually CSX Railroad. CSX Railroad made the decision to phase out its services in 2000, and the last train left McDoel Switchyard in 2004.

The City of Bloomington purchased 18 acres of old railroad bed that ran through the Switchyard, and opened the second phase of the B-Line Trail, a paved, accessible pathway that extends 3.1 miles from Adams Street on the north to Country Club Drive on the south, in 2011. The City then set its sights on transforming the former switchyard into a community park.

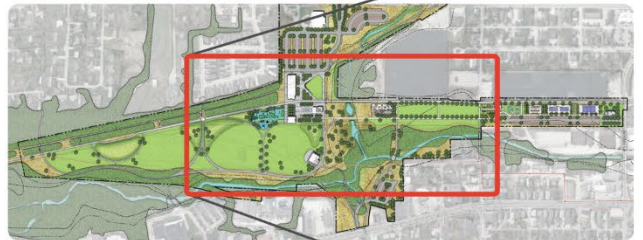

The city purchased most of the land that was to become Switchyard Park in 2009. The city had a vision for the 57.2 acres of former railroad property, and collected input from its residents, stakeholders, interest groups, environmental advocates, and neighboring property owners to develop a Master Plan that would guide the development of Switchyard Park.

Construction of the new Switchyard Park began in 2017, with a year-long project to install critical infrastructure: a 40" sanitary sewer line. Weddle Brothers Building Group LLC was awarded a construction contract for Switchyard Park in April 2018, for a total cost of \$25,857,200.

Members of the public gathered with elected officials on May 11, 2018 for a ceremonial groundbreaking at Switchyard Park, near Grimes Lane. The Switchyard was officially revealed to the public in November 2019.

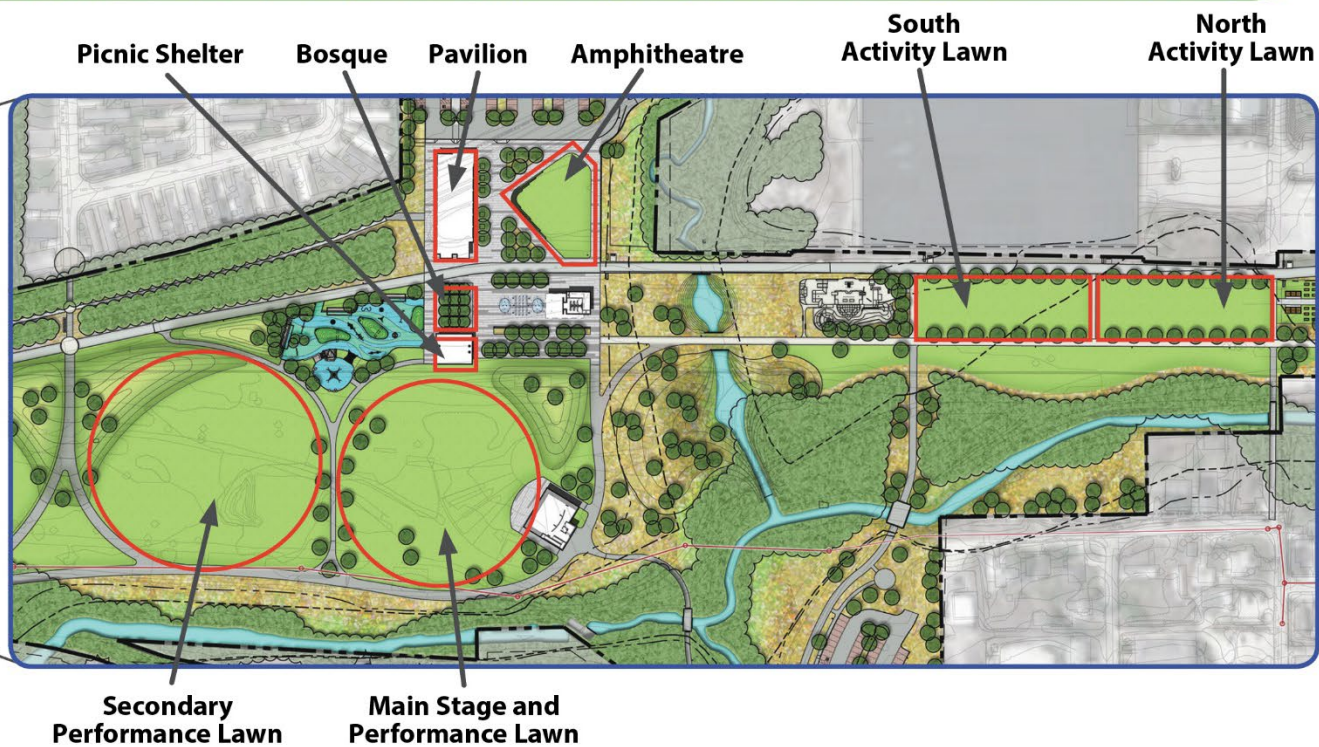

Switchyard Park Rentals	2020 fee
Picnic Shelter (per day) 1,800 sq. ft. per side	
Rental (weekdays M–F)	\$75
Rental (weekends and holidays)	\$90
Pavilion—11,000 sq. ft.	
Rental—per hour (weekdays M–F)	\$60
Rental—per hour (weekends and holidays)	\$75
Rental—per day + \$250 deposit (weekdays M–F)	\$500
Rental—per day + \$300 deposit (weekends and holidays)	\$600
Projector use—per day	\$25
Table and chair reset fee (for changes after initial set)	\$50
Amphitheatre (per day) 17,586 sq. ft.	
Rental (weekdays M–F)	\$75
Rental (weekends and holidays)	\$90
Bosque (per day)	
Rental (weekdays M–F)	\$75
Rental (weekends and holidays)	\$90

Switchyard Park Rentals	2020 fee
North Activity Lawn (per day) 29,795 sq. ft.	
Rental (weekdays M–F)	\$75
Rental (weekends and holidays)	\$90
South Activity Lawn (per day) 30,301 sq. ft.	
Rental (weekdays M–F)	\$75
Rental (weekends and holidays)	\$90
Main Stage and Performance Lawn (per day) Lawn: 30,301 sq. ft. Stage: 60' x 40'	
Non-profit—without theatrical lighting + \$100 deposit	\$200
Non-profit—with theatrical lighting + \$250 deposit	\$500
For-profit—without theatrical lighting + \$125 deposit	\$250
For-profit—with theatrical lighting + \$375 deposit	\$750
Secondary Performance Lawn (per day) 123,840 sq. ft.	
Rental (weekdays M–F)	\$75
Rental (weekends and holidays)	\$90

All rentals for more than 100 people, additional physical infrastructure, or alcohol permit may require a special use permit and additional costs. For details about reserving space, contact Hsiung Marler at 349-3742 or marlerh@bloomington.in.gov.





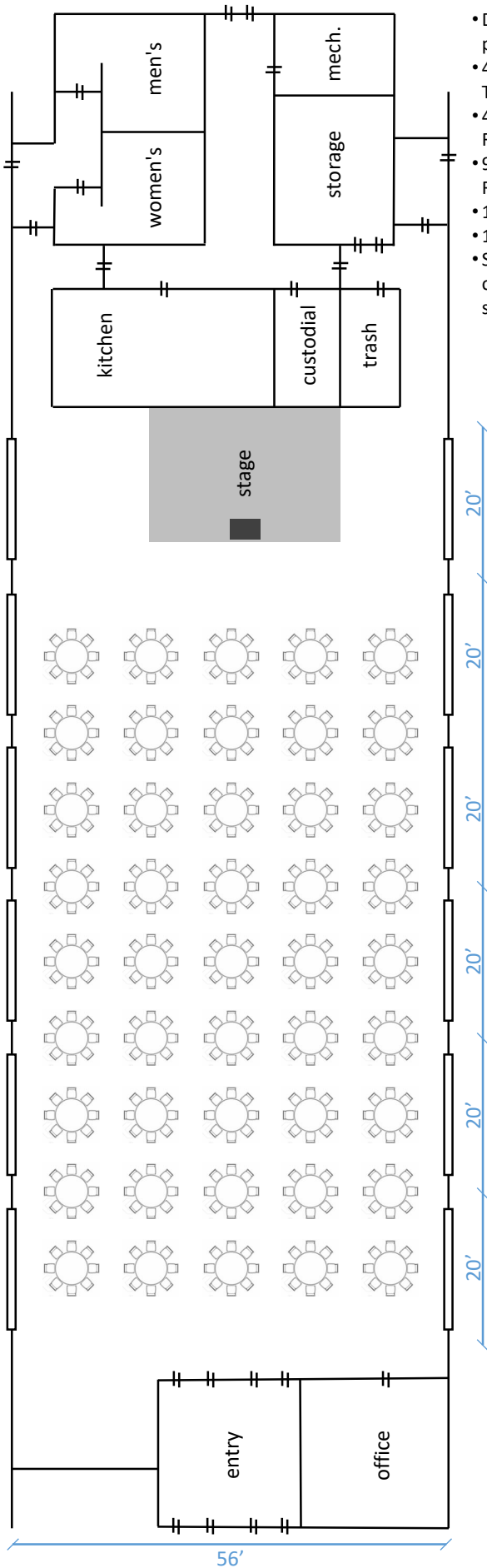

- Default is 8 chairs per round table
- 45 x 60" Round Tables
- 45 x 30"x72" Rectangle Tables
- 9 x 24" Cocktail Rounds
- 1 x Lectern
- 1 x Portable Bar
- Stage is made up of 6 4' x 8' sections

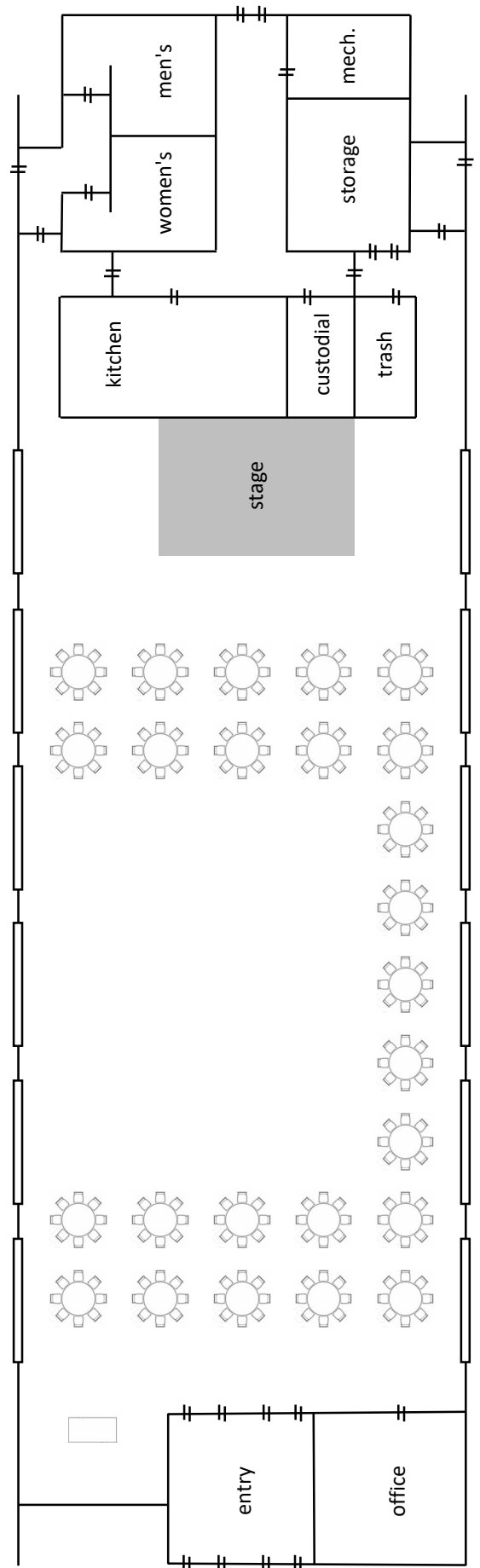
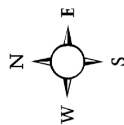

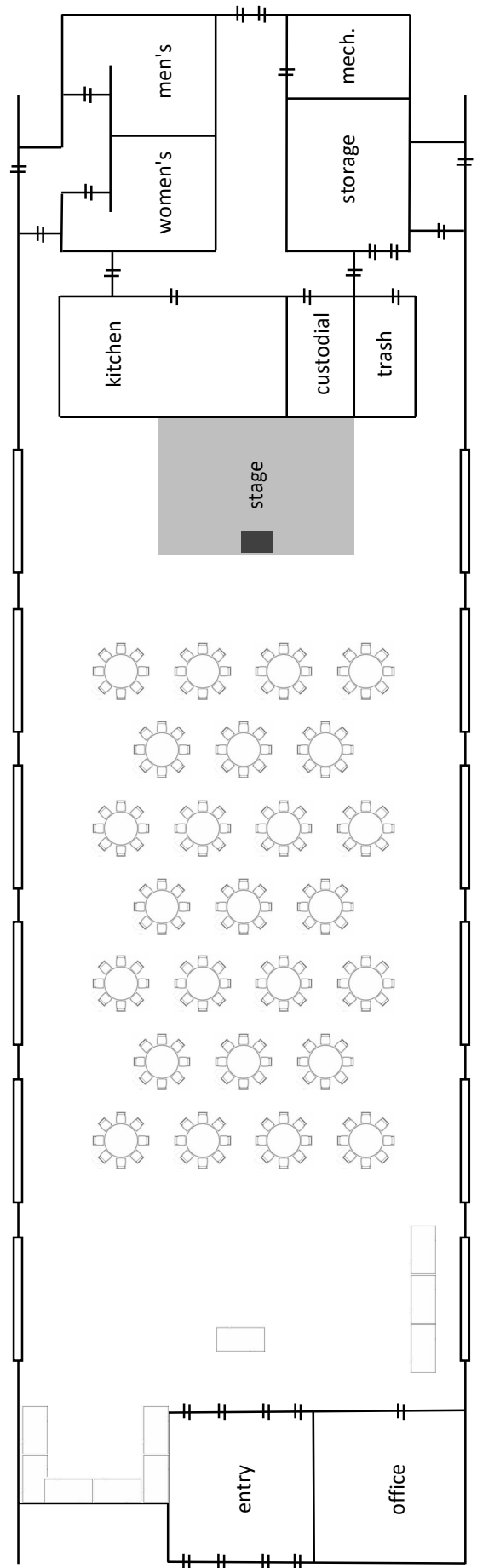
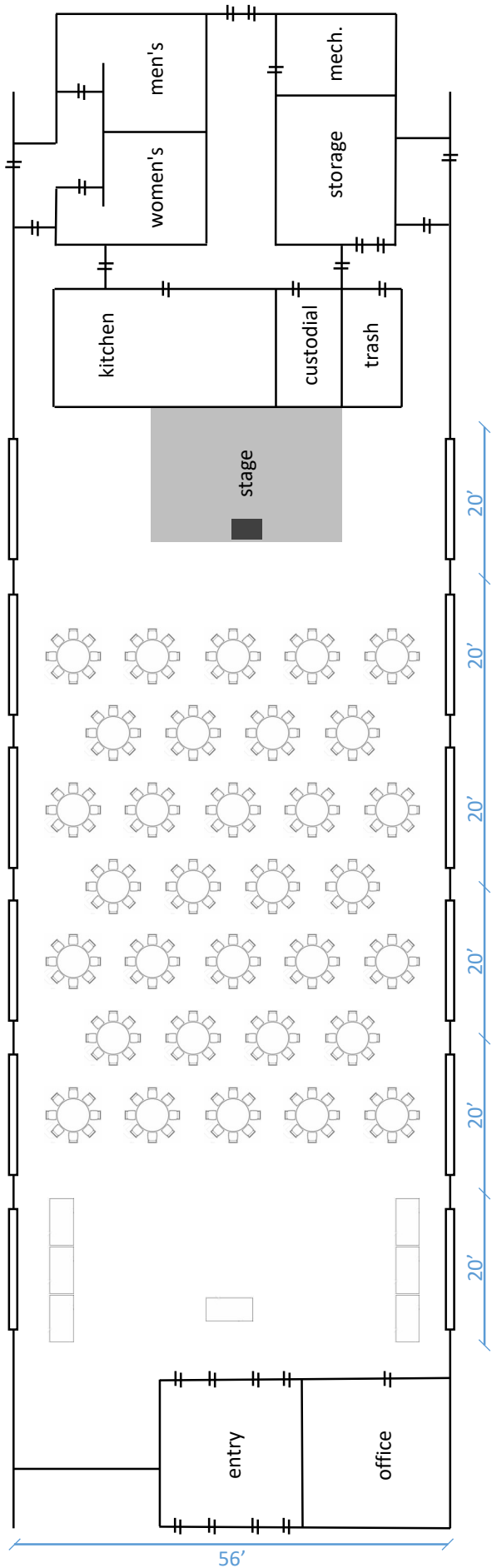

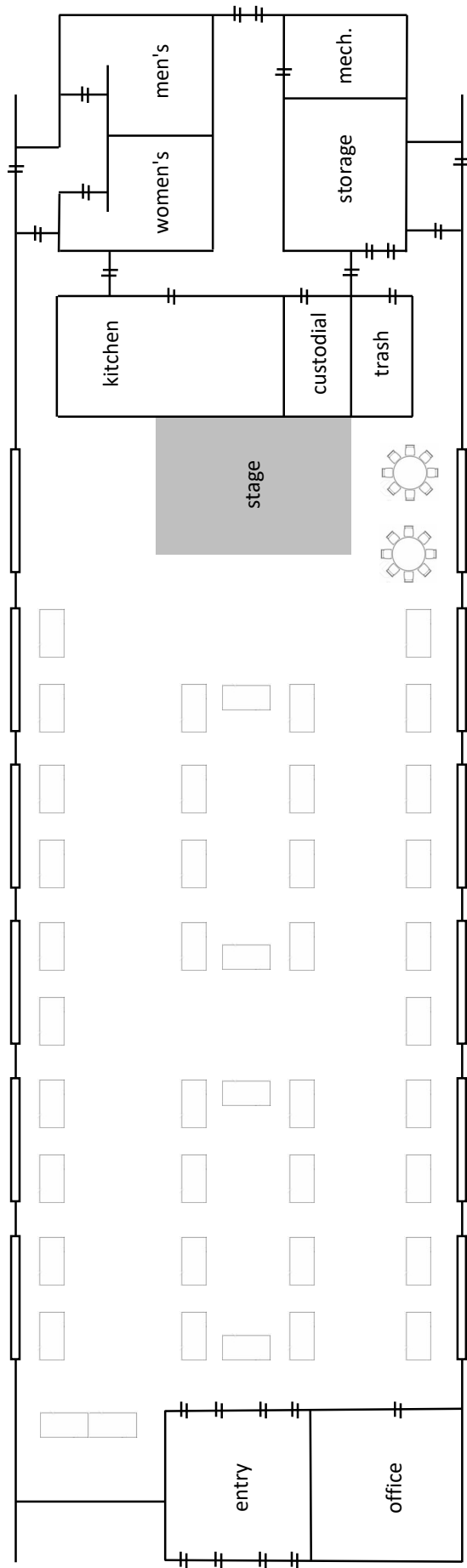
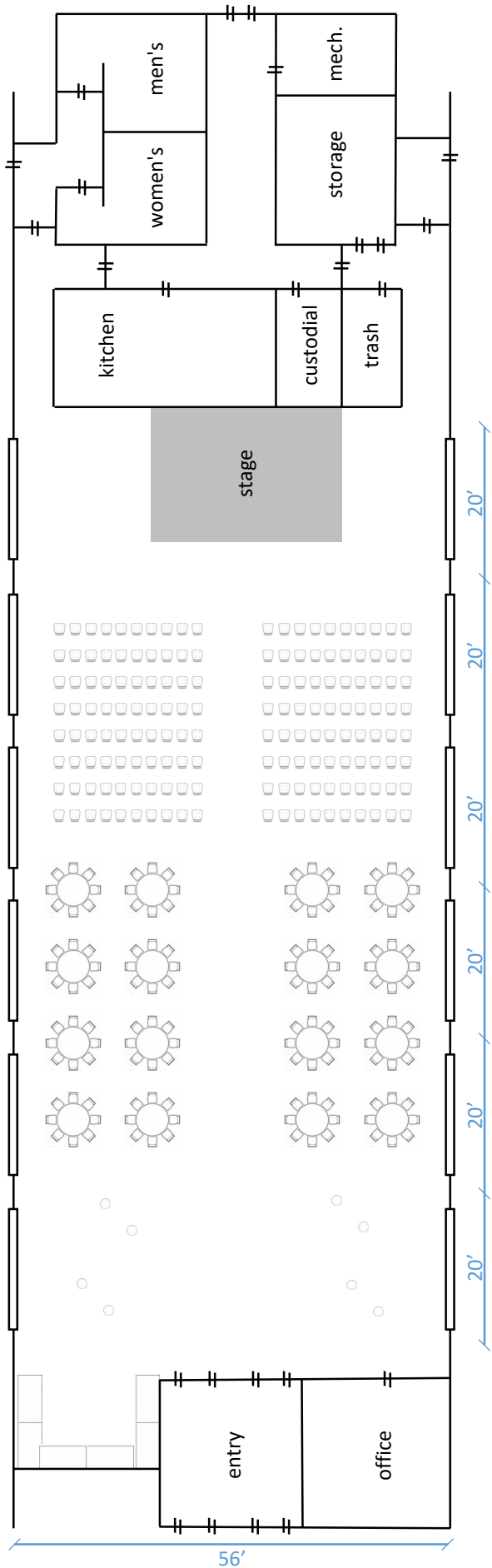

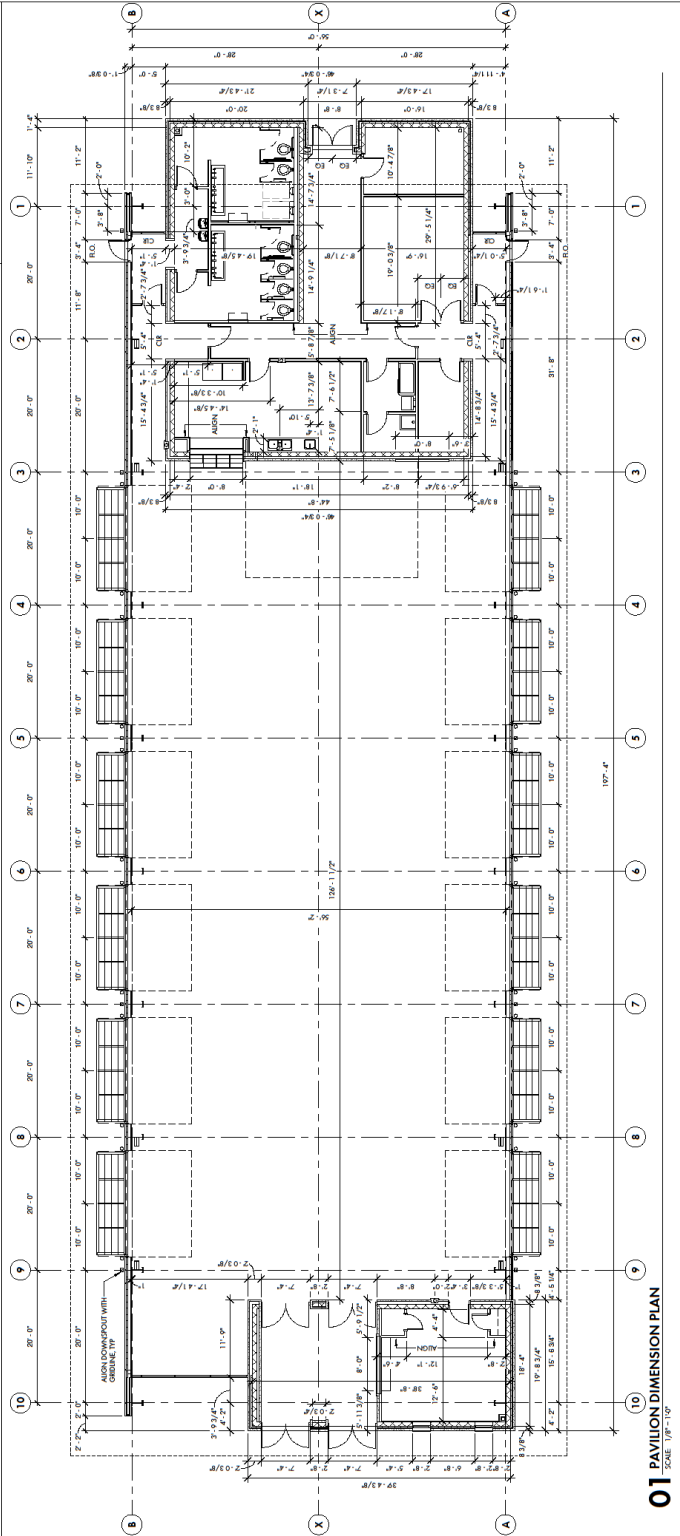

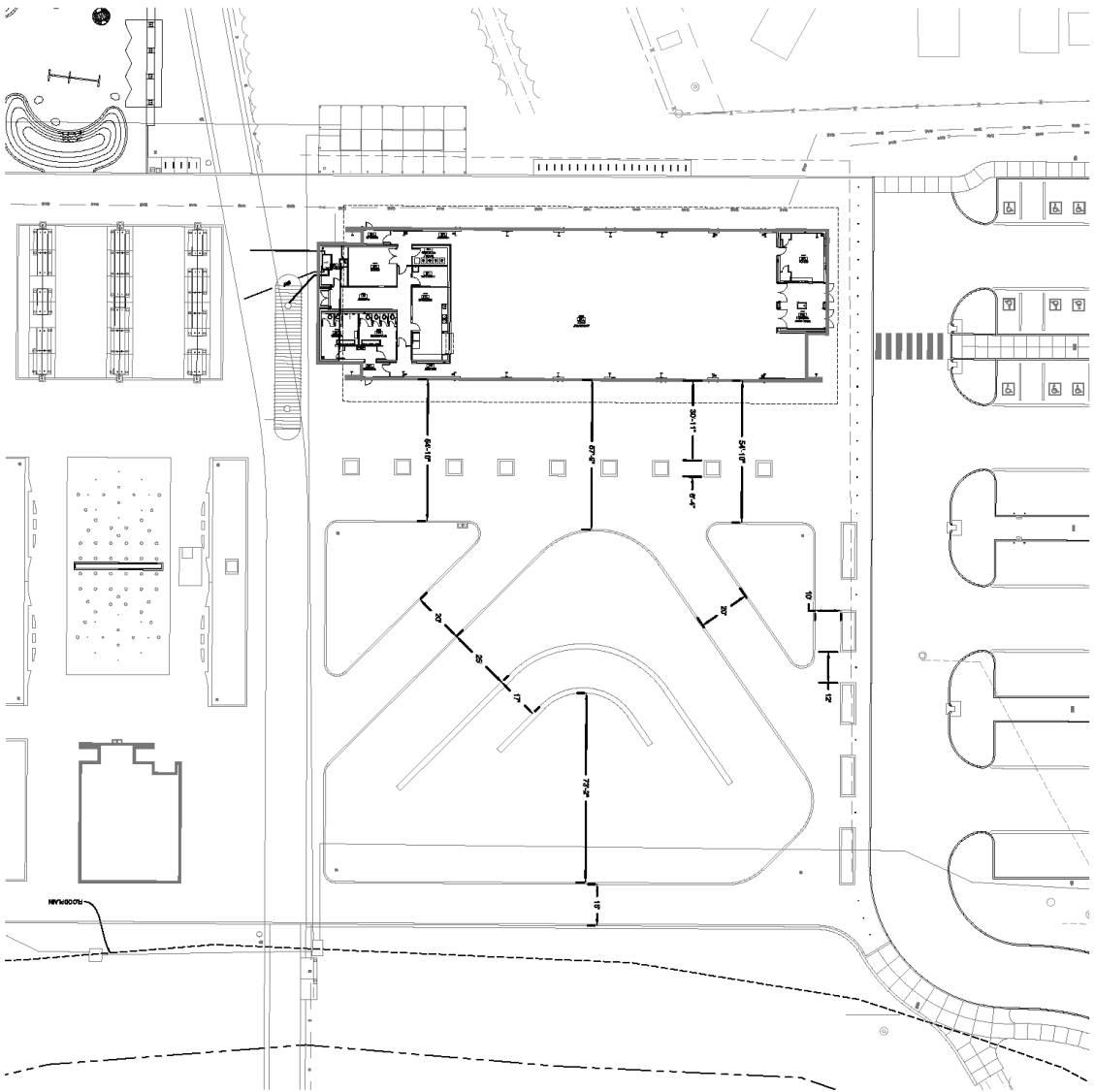

COPYRIGHT NOTICE

ALL RIGHTS RESERVED. NO PART OF THIS DOCUMENT MAY BE REPRODUCED OR TRANSMITTED IN ANY FORM OR BY ANY MEANS, ELECTRONIC OR MECHANICAL, INCLUDING PHOTOCOPYING, RECORDING, OR BY ANY INFORMATION STORAGE AND RETRIEVAL SYSTEM, WITHOUT PERMISSION IN WRITING FROM THE AUTHOR.

SITE LAYOUT PLAN E

DATE	10/1/95
DESIGNED BY	SD 3.5(2)
CHECKED BY	SD 3.5(2)
DATE	10/1/95
DESIGNED BY	SD 3.5(2)
CHECKED BY	SD 3.5(2)

Scale

0' 10' 20'

1" = 20'

SCALE 1" = 20'

Switchyard Park

Construction Issue Set

Bloomington, Indiana 47404

CITY OF BLOOMINGTON

Office of Planning and Development

401 N. Meridian St., 6th Floor, Bloomington, IN 47404

Phone: (317) 855-2000

Fax: (317) 855-2001

RUNDELL

ERNSTBERGER

ASSOCIATES

LANDSCAPE ARCHITECTS • P.A. • Bloomington, IN

411 W. Main Street, Suite 200, Bloomington, IN 47404

TELEPHONE: (317) 855-2000

FAX: (317) 855-2001

WWW.RUNDELL-ERNSTBERGER.COM