

ADDENDUM NO. 2

TO THE

DRAWINGS AND SPECIFICATIONS

FOR THE

South Walnut Street (Winslow to Ridgeview) Sidewalk Project

Issued From: The City of Bloomington
Engineering Department
Post Office Box 100
401 North Morton Street, Suite #130
Bloomington, Indiana 47404

Issue Date: December 16, 2021

Letting Date: December 20, 2021

This Addendum No.2 to the drawings and specifications shall supplement, amend and become a part of the Bid documents, plans, and specifications for the South Walnut Sidewalk (Winslow to Ridgeview) Sidewalk Project. All Bids and construction contracts shall be based on these modifications to the original contract documents. Bidders shall acknowledge receipt of this Addendum on the Bid Form. Failure to do so may subject the Bidder to disqualification.

Item No. 1: ADDITIONAL INFORMATION OR CLARIFICATIONS- LANDCAPING

A revised "South Walnut Street (Winslow to Ridgeview) Sidewalk Project Site landscape Plan" Sheet C701, has been issued and is attached to the addendum. This revised sheet shall replace the previously issued Sheet C701. The project shall be built as shown on the revised sheet.

Item No. 2: QUESTIONS AND ANSWERS

(Q) I wanted to pass along that there are deltas between the plant schedule and the actual plan count on the landscape plan, sheet C701.

(A) Bidders shall use the previously provided quantities shown in the Unit Price sheet of the Bid Packet. The City believes that the plant quantities are accurate. Note that the plan sheets have a 50' overlap in stationing which may lead to mistakenly double-counting some trees.

	CERTIFIED BY: <u>Neil Kopper</u> NEIL KOPPER SENIOR PROJECT ENGINEER CITY OF BLOOMINGTON, IN
--	--

Acknowledge receipt of the addendum by representing it on the Bid Form in Section B and submitting a signed copy with your quote proposal.

RECEIVED BY: CONTRACTOR (FIRM AND ADDRESS)

SIGNATURE: _____ **DATE:** _____

PRINTED NAME: _____

TITLE: _____

PLANTING SCHEDULE

KEY	QTY	SCIENTIFIC NAME	COMMON NAME	SIZE	CONDITION
AC	8	Ametanchier Canadensis	Shadblow Serviceberry	8" High multi-stem	B & B
CB	4	Carpinus betulus 'Frans Fontaine'	Frans Fontaine Common Hornbeam	1.5" Caliper Minimum	B & B
GB	9	Ginkgo biloba 'Fastigiata'	Fastigiata Maidenhair Tree	2" Caliper Minimum	B & B
LT	4	Liriodendron tulipifera 'FS-Oz'	Emerald City Tulip Tree	2" Caliper Minimum	B & B
NS	4	Nyssa sylvatica	Black Gum	2" Caliper Minimum	B & B

GENERAL NOTES:

- STAKE TREES ONLY IF THEY DO NOT REMAIN PLUMB.
- DO NOT HEAVILY PRUNE TREES AT PLANTING. PRUNE ONLY CROSSOVER LIMBS, CO-DOMINANT LEADERS, AND BROKEN OR DEAD BRANCHES. SOME INTERIOR TWIGS AND LATERAL BRANCHES MAY BE PRUNED, HOWEVER, DO NOT REMOVE TERMINAL BUDS OR BRANCHES THAT EXTEND TO THE EDGE OF THE CROWN.
- TREES MUST BE PLANTED SUCH THAT THE TRUNK PLANTS VISIBLE AT THE TOP OF THE ROOT BALL. DO NOT COVER THE TOP OF THE ROOT BALL WITH SOIL. AFTER INSTALLATION, FINISH GRADE OF ROOT BALL SHOULD BE AT OR ABOVE SURROUNDING GRADE.
- STAKES WITH RUBBER TUBING AND FLAGS (SEE GENERAL NOTES FOR STAKING REQUIREMENTS). STAKES ARE TO BE LOCATED WITHIN MULCH RING. TREE GATOR OR EQUIVALENT PORTABLE GASP IRRIGATION BAG, NOT REQUIRED IF OPERATIONAL IRRIGATION SYSTEM EXISTS AT TIME OF PLANTING. USE ONLY FROM APRIL 1 TO OCTOBER 31.
- 3" HARDWOOD BARK MULCH, DO NOT PLACE IN CONTACT WITH TREE TRUNK. HARDWOOD MULCH 50 FT REMAINS WEED FREE.
- REMOVE TOP HALF OF BURAP AS WELL AS ANY BRINDERS FROM THE TOP OF ROOT BALL.
- FINISHED GRADE
- SHADED BED EDGE
- TOPSOIL
- SCARP ALL SIDES OF TREE HIT
- PLACE ROOTBALL ON UNGRAVATED OR TAMPED NATIVE SOIL.

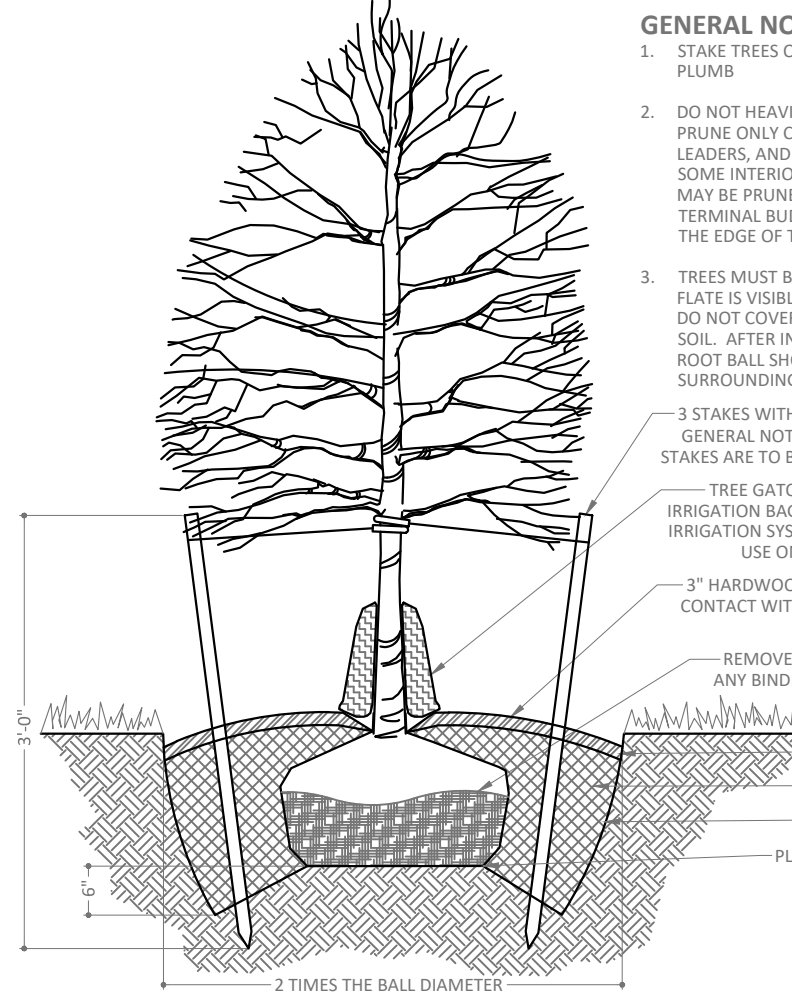

1 TREE PLANTING DETAIL

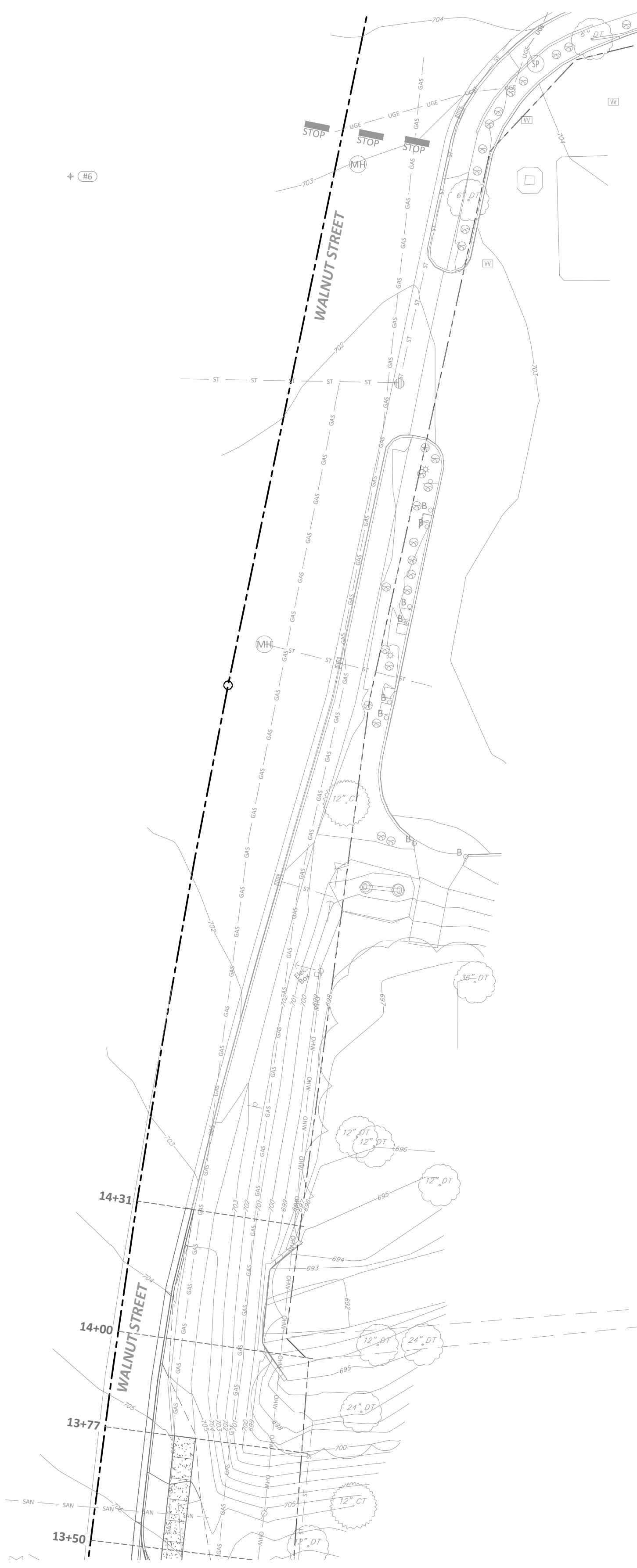

STATION 13+50 to 17+44

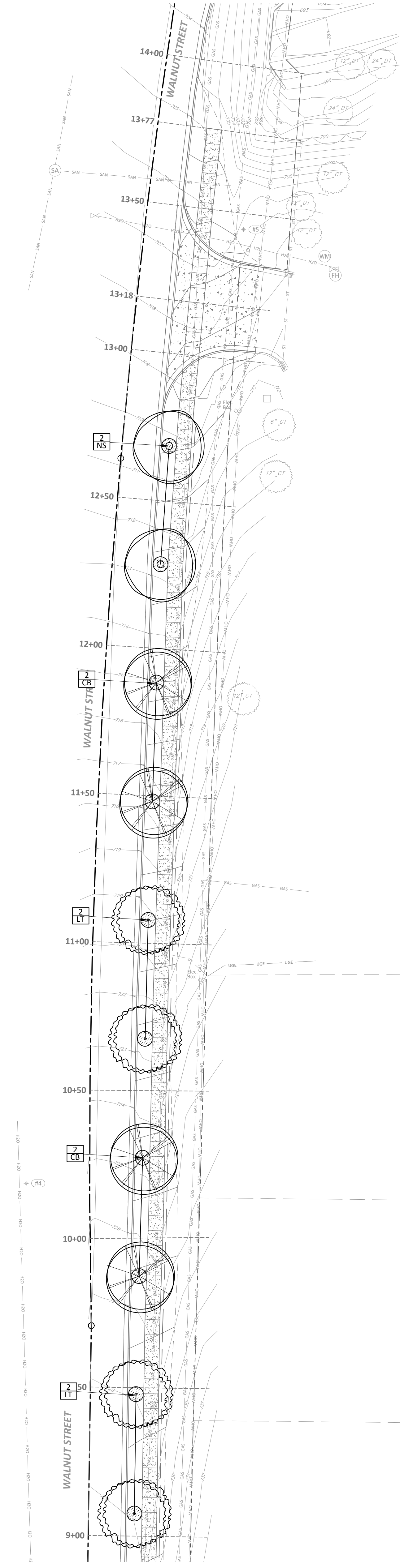

STATION 9+00 to 14+00

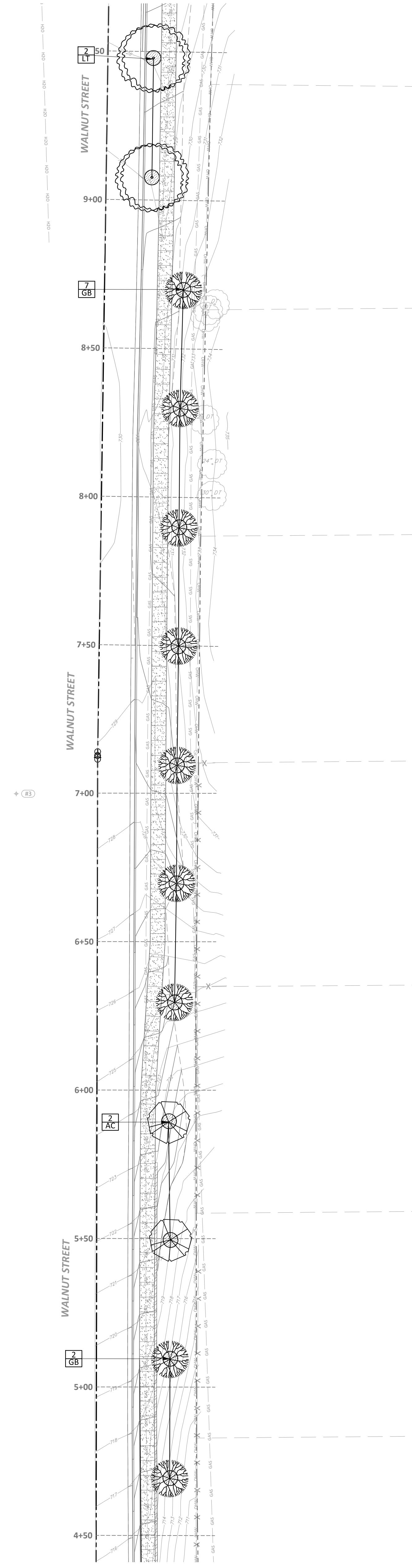

STATION 4+50 to 9+50

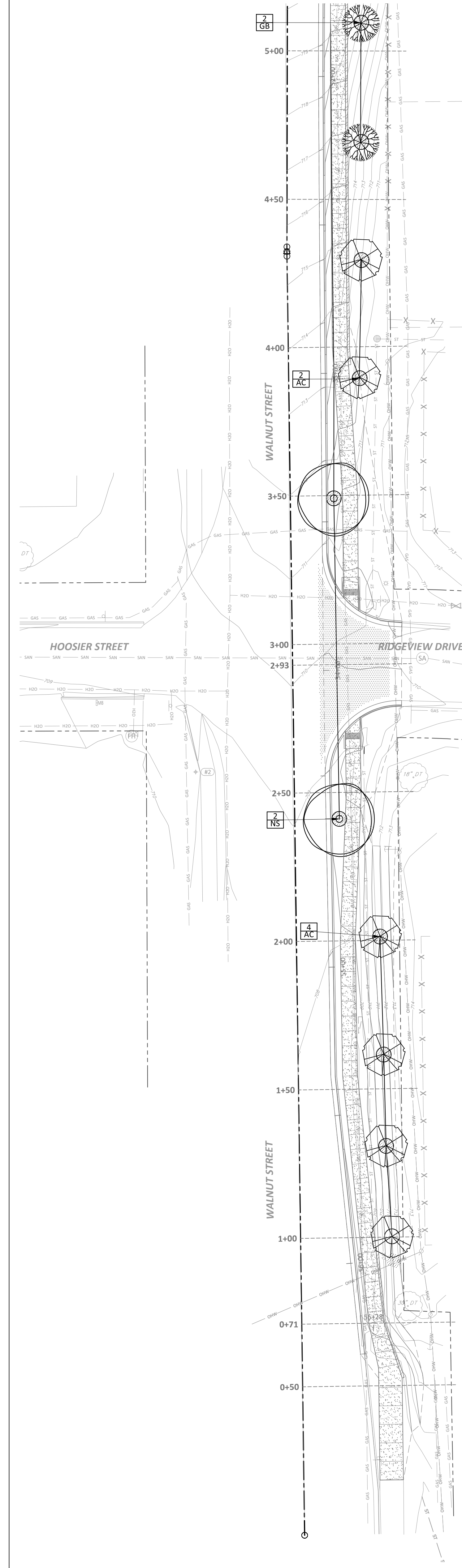

STATION 0+00 to 5+00

GENERAL NOTES

- THE CONTRACTOR SHALL LOCATE ALL UTILITIES AND VERIFY SITE CONDITION INFORMATION ON DRAWINGS PRIOR TO STARTING WORK AND PROMPTLY REPORT ANY DISCREPANCIES OR DEVIATIONS FROM THE INFORMATION SHOWN ON THE PLAN TO THE DESIGNER AND OWNER. THE OWNER IS NOT RESPONSIBLE FOR UNAUTHORIZED CHANGES OR EXTRA WORK REQUIRED TO CORRECT UNREPORTED DISCREPANCIES.
- THE CONTRACTOR SHALL SUPPLY ALL PLANT MATERIAL IN QUANTITIES AND CONDITIONS SUFFICIENT TO COMPLETE THE PLANTING AS SHOWN ON THE LANDSCAPE PLAN. PLANT MATERIAL QUANTITIES SHOWN ON PLAN TAKE PRECEDENCE OVER THOSE IN THE PLANT LIST.
- ALL PLANT MATERIAL SHALL CONFORM TO ANSI Z 60-1996 AND CURRENT ASSOCIATION OF AMERICAN NURSERMEN STANDARDS. NO PARK GRADE MATERIAL SHALL BE ACCEPTED.
- SPECIMEN SIZES INDICATED ON PLANT SCHEDULE ARE MINIMUM ACCEPTABLE SIZES. LARGER SPECIMENS MAY BE UTILIZED.
- ALL PLANTING MASSES SHALL BE CONTAINED WITHIN MULCH BEDS AND RECEIVE 3" THICK SHROUDED HARDWOOD MULCH. ALL TREES OUTSIDE PLANTING BED AREAS SHALL RECEIVE A 5' MIN. DIAMETER MULCH RING AT BASE.
- ALL LANDSCAPED AREAS NOT BARK MULCHED SHALL BE SEEDED OR SODDED AS INDICATED, UNLESS NOTED OTHERWISE. ALL OTHER AREAS DISTURBED, GRADED OR OTHERWISE MODIFIED BY NEW CONSTRUCTION SHALL RECEIVE 6" OF TOP SOIL, SEED AND MULCH. SEE SPECIFICATIONS FOR SEEDING REQUIREMENTS.
- ALL PLANT MATERIAL SHALL BEAR THE SAME RELATIONSHIP TO FINISH GRADE AS THE PLANT'S ORIGINAL GRADE PRIOR TO DIGGING. ALL PLANTS SHALL BE SET PLUMB. UNLESS NOTED OTHERWISE, IT IS THE CONTRACTOR'S OPTION TO STAKE TREES. HOWEVER, IT SHALL REMAIN THE CONTRACTOR'S RESPONSIBILITY TO ASSURE PLANTS REMAIN PLUMB UNTIL THE END OF CONTRACTED GUARANTEE PERIOD.
- ALL PLANTINGS SHALL BE WATERED DURING THE FIRST 24 HOUR PERIOD AFTER PLANTING. WATER THOROUGHLY TO ENSURE ALL AIR POCKETS ARE REMOVED AROUND ROOT BALL.
- CONTRACTOR IS RESPONSIBLE FOR WATERING AND MAINTAINING PLANT MATERIAL UNTIL TIME OF ACCEPTED ESTABLISHMENT.
- ALL PLANTING BED EDGES TO BE SPADE CUT UNLESS SPECIFIED WITH MOW STRIP OR OTHER INSTALLED EDGING.
- PLACE BIODEGRADABLE STRAW BLANKET NORTH AMERICAN GREEN 15LBN OR APPROVED EQUAL ON SLOPES OF OR EXCEEDING 3:1 OR AS OTHERWISE INDICATED OR DIRECTED BY ENGINEER.
- COORDINATE LANDSCAPE PLAN WITH ALL WATER QUALITY AND EROSION CONTROL MEASURES.
- IF OWNER REQUESTS, PLANTS SHALL BE STAKED AND/OR FIELD-LOCATED BY DESIGNER AND CONTRACTOR. FINAL LOCATIONS OF TREES SHOULD BE ADJUSTED IF NEEDED TO AVOID OVERHEAD AND UNDERGROUND UTILITIES.
- ANY PLANT MATERIAL SUBSTITUTIONS INSTALLED WITHOUT APPROVAL FROM DESIGNER AND/OR OWNER SHALL BE REPLACED AT CONTRACTOR'S EXPENSE.
- ALL PLANTING MATERIALS, REGARDLESS OF SIZE SPECIFIED, SHALL BE OF SIZES THAT COMPLY WITH CITY OF BLOOMINGTON LUDO LANDSCAPING STANDARDS.
- NO HEAVY MACHINERY/EQUIPMENT SHALL BE USED WITHIN ROOT ZONES OF EXISTING TREES THAT ARE TO REMAIN, EXCEPT WHERE DISTURBANCE IS INDICATED. CONTRACTOR SHALL ENSURE EXISTING TREES TO REMAIN ARE PROTECTED AND FULLY PRESERVED DURING THE CONSTRUCTION/GRADING PROCESS.

Bledsoe Riggert Cooper James
BRCJ
 LAND SURVEYING • CIVIL ENGINEERING • GIS
 1351 West Tapp Road Bloomington, Indiana 47403
 Phone: 812-336-8277 www.brcjvll.com

CITY OF BLOOMINGTON

**SOUTH WALNUT STREET
 SIDEWALK IMPROVEMENTS**
 SOUTH WALNUT STREET
 BLOOMINGTON, INDIANA
 BRCJ Project No: 10525

SITE LANDSCAPE PLAN

SCALE: 1" = 20'

Date: 11-05-2021 Issue: 100% CONSTRUCTION DOCUMENTS

REVISION SCHEDULE		
Rev. #	Rev. Description:	Issue Date
1	ADDENDUM 2	2021-12-16

LEGEND

1 GB PLANT QUANTITY/KEY

Drawn By: DLN
 Designed By: DLN
 Checked By: WSR

C701

PLANTING SCHEDULE

KEY	QTY	SCIENTIFIC NAME	COMMON NAME	SIZE	CONDITION
AC	8	Ametanochier Canadensis	Shadblow Serviceberry	8" High multi-stem	B & B
CB	4	Carpinus betulus 'Frans Fontaine'	Frans Fontaine Common Hornbeam	1.5" Caliper Minimum	B & B
GB	9	Ginkgo biloba 'Fastigiata'	Fastigiata Maidenhair Tree	2" Caliper Minimum	B & B
LT	4	Liriodendron tulipifera 'FS-Oz'	Emerald City Tulip Tree	2" Caliper Minimum	B & B
NS	4	Nyssa sylvatica	Black Gum	2" Caliper Minimum	B & B

GENERAL NOTES:

- STAKE TREES ONLY IF THEY DO NOT REMAIN PLUMB.
- DO NOT HEAVILY PRUNE TREES AT PLANTING. PRUNE ONLY CROSSOVER LIMBS, CO-DOMINANT LEADERS, AND BROKEN OR DEAD BRANCHES. SOME INTERIOR TWIGS AND LATERAL BRANCHES MAY BE PRUNED, HOWEVER, DO NOT REMOVE TERMINAL BUDS OR BRANCHES THAT EXTEND TO THE EDGE OF THE CROWN.
- TREES MUST BE PLANTED SUCH THAT THE TRUNK PLANTS VISIBLE AT THE TOP OF THE ROOT BALL. DO NOT COVER THE TOP OF THE ROOT BALL WITH SOIL. AFTER INSTALLATION, FINISH GRADE OF ROOT BALL SHOULD BE AT OR ABOVE SURROUNDING GRADE.
- STAKES WITH RUBBER TUBING AND FLAGS (SEE GENERAL NOTES FOR STAKING REQUIREMENTS). STAKES ARE TO BE LOCATED WITHIN MULCH RING. TREE GATOR OR EQUIVALENT PORTABLE GASP IRRIGATION BAG, NOT REQUIRED IF OPERATIONAL IRRIGATION SYSTEM EXISTS AT TIME OF PLANTING. USE ONLY FROM APRIL 1 TO OCTOBER 31.
- 3" HARDWOOD BARK MULCH. DO NOT PLACE IN CONTACT WITH TREE TRUNK. HARDWOOD MULCH 50 FT REMAINS WEED FREE.
- REMOVE TOP HALF OF BURAP AS WELL AS ANY BRUSH FROM THE TOP OF ROOT BALL.
- FINISHED GRADE
- SHADED BED EDGE
- TOPSOIL
- SCARP ALL SIDES OF TREE PIT
- PLACE ROOTBALL ON UNGRAVATED OR TAMPED NATIVE SOIL.

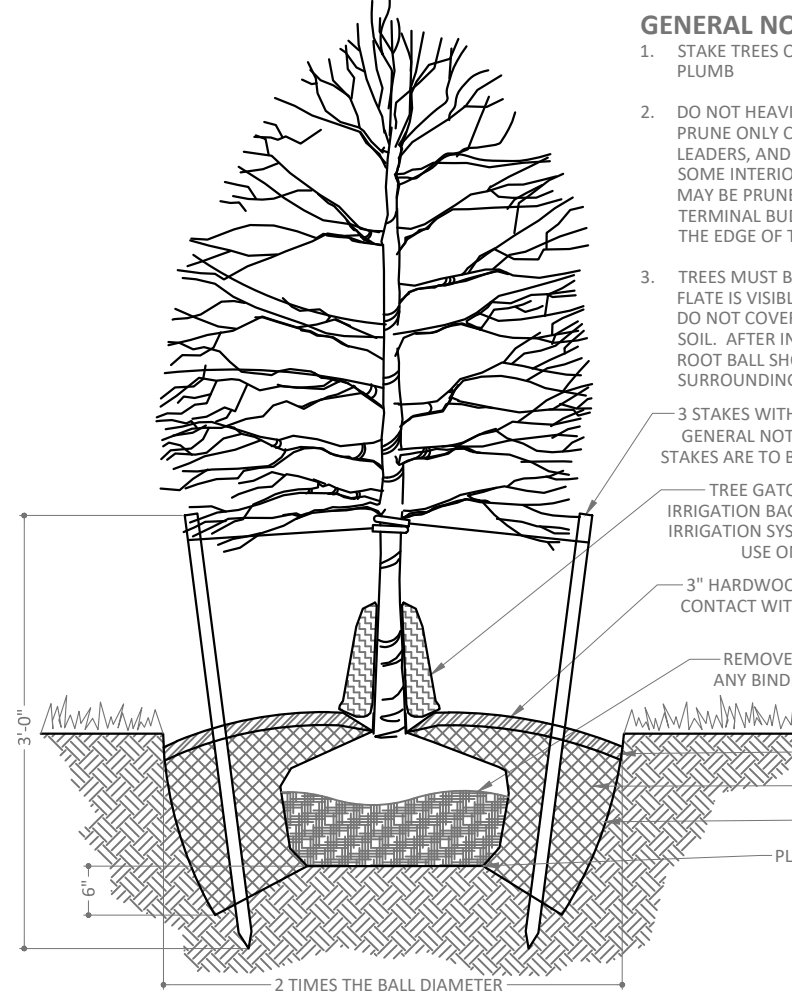

1 TREE PLANTING DETAIL

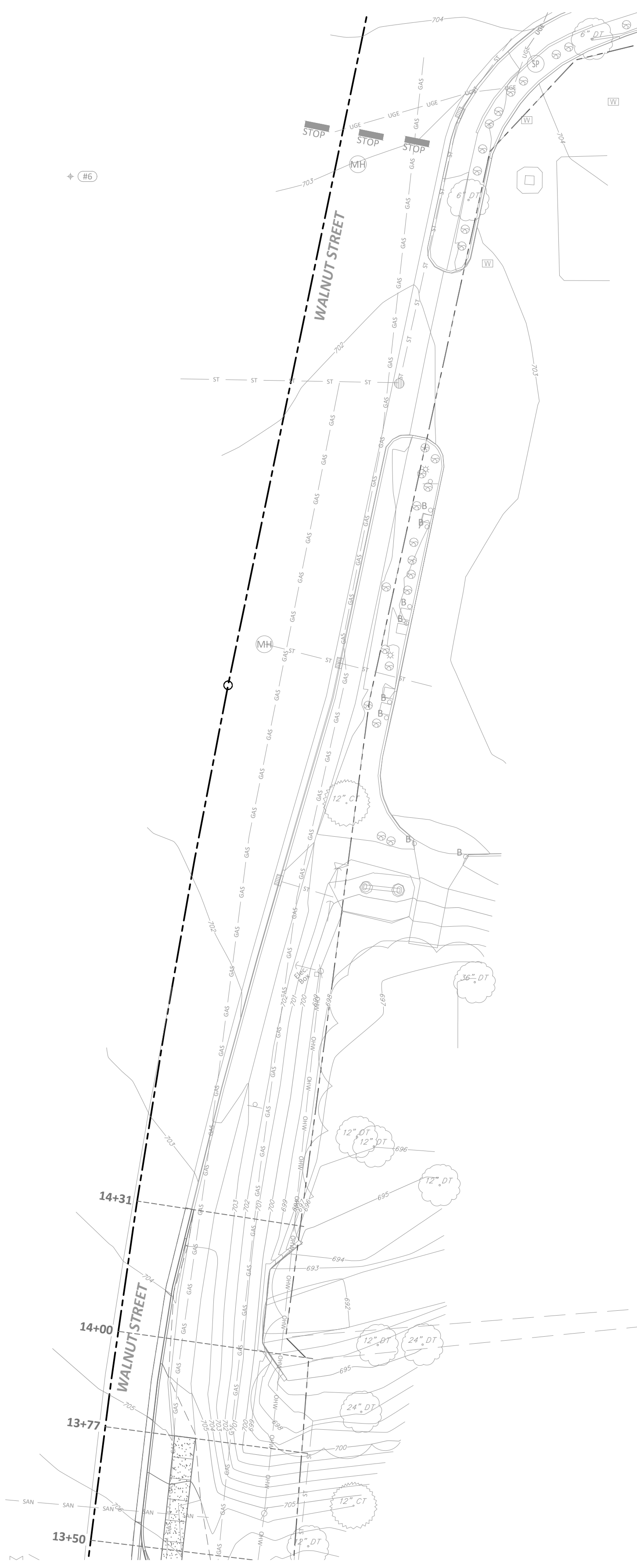

STATION 13+50 to 17+44

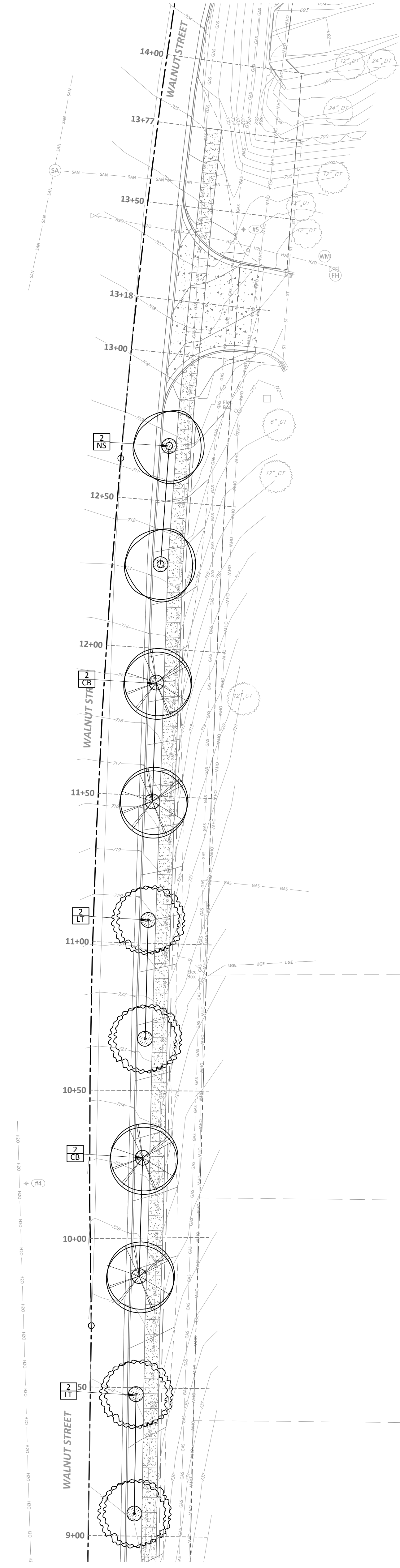

STATION 9+00 to 14+00

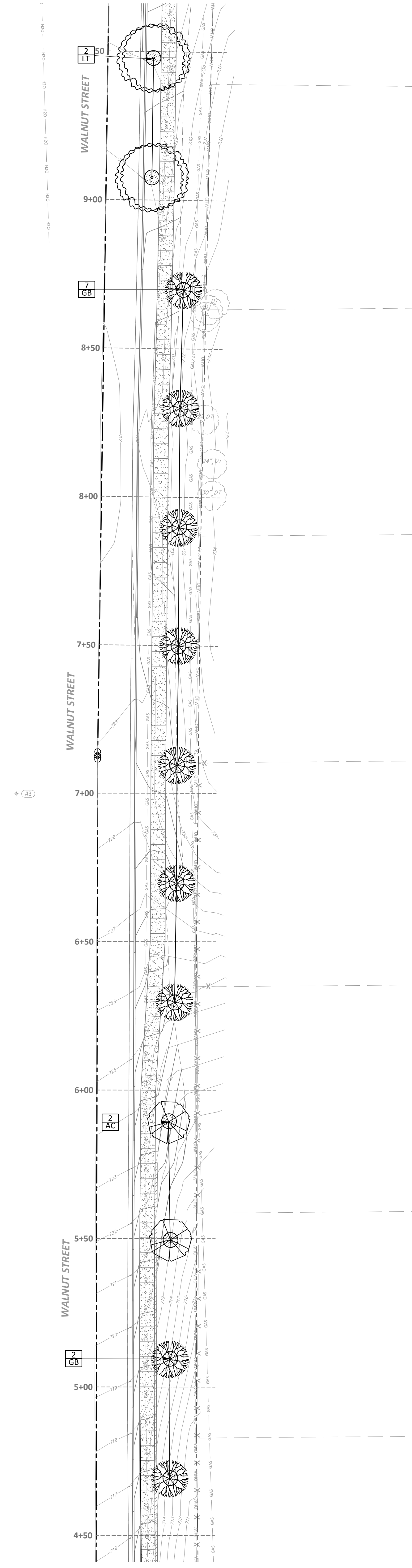

STATION 4+50 to 9+50

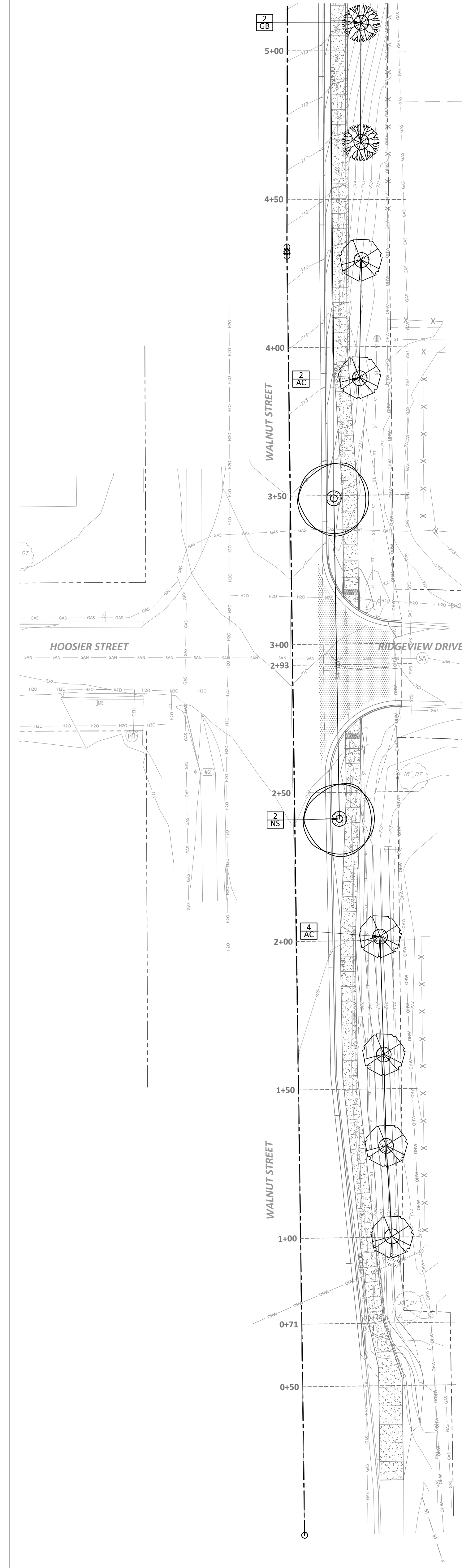

STATION 0+00 to 5+00

GENERAL NOTES

- THE CONTRACTOR SHALL LOCATE ALL UTILITIES AND VERIFY SITE CONDITION INFORMATION ON DRAWINGS PRIOR TO STARTING WORK AND PROMPTLY REPORT ANY DISCREPANCIES OR DEVIATIONS FROM THE INFORMATION SHOWN ON THE PLAN TO THE DESIGNER AND OWNER. THE OWNER IS NOT RESPONSIBLE FOR UNAUTHORIZED CHANGES OR EXTRA WORK REQUIRED TO CORRECT UNREPORTED DISCREPANCIES.
- THE CONTRACTOR SHALL SUPPLY ALL PLANT MATERIAL IN QUANTITIES AND CONDITIONS SUFFICIENT TO COMPLETE THE PLANTING AS SHOWN ON THE LANDSCAPE PLAN. PLANT MATERIAL QUANTITIES SHOWN ON PLAN TAKE PRECEDENCE OVER THOSE IN THE PLANT LIST.
- ALL PLANT MATERIAL SHALL CONFORM TO ANSI Z 60-1996 AND CURRENT ASSOCIATION OF AMERICAN NURSERMEN STANDARDS. NO PARK GRADE MATERIAL SHALL BE ACCEPTED.
- SPECIMEN SIZES INDICATED ON PLANT SCHEDULE ARE MINIMUM ACCEPTABLE SIZES. LARGER SPECIMENS MAY BE UTILIZED.
- ALL PLANTING MASSES SHALL BE CONTAINED WITHIN MULCH BEDS AND RECEIVE 3" THICK SHROUDED HARDWOOD MULCH. ALL TREES OUTSIDE PLANTING BED AREAS SHALL RECEIVE A 5' MIN. DIAMETER MULCH RING AT BASE.
- ALL LANDSCAPED AREAS NOT BARK MULCHED SHALL BE SEEDED OR SODDED AS INDICATED, UNLESS NOTED OTHERWISE. ALL OTHER AREAS DISTURBED, GRADED OR OTHERWISE MODIFIED BY NEW CONSTRUCTION SHALL RECEIVE 6" OF TOP SOIL, SEED AND MULCH. SEE SPECIFICATIONS FOR SEEDING REQUIREMENTS.
- ALL PLANT MATERIAL SHALL BEAR THE SAME RELATIONSHIP TO FINISH GRADE AS THE PLANT'S ORIGINAL GRADE PRIOR TO DIGGING. ALL PLANTS SHALL BE SET PLUMB. UNLESS NOTED OTHERWISE, IT IS THE CONTRACTOR'S OPTION TO STAKE TREES. HOWEVER, IT SHALL REMAIN THE CONTRACTOR'S RESPONSIBILITY TO ASSURE PLANTS REMAIN PLUMB UNTIL THE END OF CONTRACTED GUARANTEE PERIOD.
- ALL PLANTINGS SHALL BE WATERED DURING THE FIRST 24 HOUR PERIOD AFTER PLANTING. WATER THOROUGHLY TO ENSURE ALL AIR POCKETS ARE REMOVED AROUND ROOT BALL.
- CONTRACTOR IS RESPONSIBLE FOR WATERING AND MAINTAINING PLANT MATERIAL UNTIL TIME OF ACCEPTED ESTABLISHMENT.
- ALL PLANTING BED EDGES TO BE SPADE CUT UNLESS SPECIFIED WITH MOW STRIP OR OTHER INSTALLED EDGING.
- PLACE BIODEGRADABLE STRAW BLANKET NORTH AMERICAN GREEN 15LBN OR APPROVED EQUAL ON SLOPES OF OR EXCEEDING 3:1 OR AS OTHERWISE INDICATED OR DIRECTED BY ENGINEER.
- COORDINATE LANDSCAPE PLAN WITH ALL WATER QUALITY AND EROSION CONTROL MEASURES.
- IF OWNER REQUESTS, PLANTS SHALL BE STAKED AND/OR FIELD-LOCATED BY DESIGNER AND CONTRACTOR. FINAL LOCATIONS OF TREES SHOULD BE ADJUSTED IF NEEDED TO AVOID OVERHEAD AND UNDERGROUND UTILITIES.
- ANY PLANT MATERIAL SUBSTITUTIONS INSTALLED WITHOUT APPROVAL FROM DESIGNER AND/OR OWNER SHALL BE REPLACED AT CONTRACTOR'S EXPENSE.
- ALL PLANTING MATERIALS, REGARDLESS OF SIZE SPECIFIED, SHALL BE OF SIZES THAT COMPLY WITH CITY OF BLOOMINGTON LUDO LANDSCAPING STANDARDS.
- NO HEAVY MACHINERY/EQUIPMENT SHALL BE USED WITHIN ROOT ZONES OF EXISTING TREES THAT ARE TO REMAIN, EXCEPT WHERE DISTURBANCE IS INDICATED. CONTRACTOR SHALL ENSURE EXISTING TREES TO REMAIN ARE PROTECTED AND FULLY PRESERVED DURING THE CONSTRUCTION/GRADING PROCESS.

Bledsoe Riggert Cooper James
BRCJ
 LAND SURVEYING • CIVIL ENGINEERING • GIS
 1351 West Tapp Road Bloomington, Indiana 47403
 Phone: 812-336-8277 www.brcjvll.com

CITY OF BLOOMINGTON

**SOUTH WALNUT STREET
 SIDEWALK IMPROVEMENTS**
 SOUTH WALNUT STREET
 BLOOMINGTON, INDIANA
 BRCJ Project No: 10525
SITE LANDSCAPE PLAN

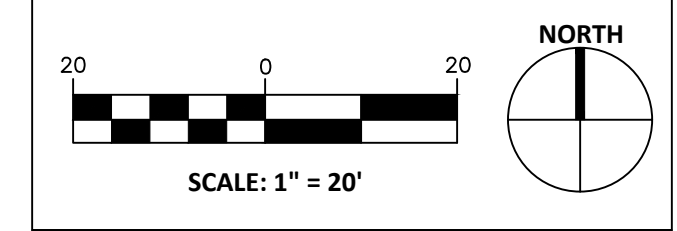

Date: 11-05-2021 Issue: 100% CONSTRUCTION DOCUMENTS

REVISION SCHEDULE		
Rev. #	Rev. Description:	Issue Date
1	ADDENDUM 2	2021-12-16

LEGEND

1 GB PLANT QUANTITY/KEY

Drawn By: DLN
 Designed By: DLN
 Checked By: WSR

C701