

ADDENDUM NO. 2

JUNE 15, 2026

PREPARED BY SCHMIDT ASSOCIATES FOR:
BLOOMINGTON CONVENTION CENTER WAYFINDING & SIGNAGE
BLOOMINGTON CONVENTION CENTER

This Addendum consists of 1 Addendum page and 5 attachment pages totaling 6 pages.

Acknowledge receipt of this Addendum by inserting its number on the Bid Form. Failure to do so may subject the Bid to disqualification. This Addendum is part of the Contract Documents.

Bidder is encouraged to verify with reprographer of record all Addenda issued (do not rely exclusively on third party plan room services).

PART 1 - CHANGES TO PRIOR ADDENDA (NOT APPLICABLE)

PART 2 - CHANGES TO THE PROJECT MANUAL (NOT APPLICABLE)

PART 3 - CHANGES TO THE DRAWINGS

Modifications described herein shall be incorporated in the Drawings. All other Work shall remain unchanged.

3.1 DRAWING SHEETS: ADDITIONS, DELETIONS AND REPLACEMENTS

DRAWING NO.	INDICATE ACTION: ADD (A), DELETE (D), DELETE & REPLACE (R),
WF-SERIES DRAWINGS	
WF1F2	DELETE AND REPLACE
WF-401	DELETE AND REPLACE
WF-402	DELETE AND REPLACE
WF-403	DELETE AND REPLACE

END OF ADDENDUM 2

AVAILABLE PROJECT INFORMATION

The following information is being made available to Bidders for informational purposes only and is not a part of the Addendum.

- A. See the following Bidding RFI Responses Report

**Type "M1" Monument Sign
MONUMENT SIGN WITH INTEGRATED DIGITAL DISPLAY**

- Sign structure to be fabricated aluminum monument assembly with integrated red and black metal panel system and recessed digital display.
- Sign face to be formed aluminum panels with matte black finish and gloss red accent panel. Total panel depth to be 8". Black panel field to project 2.25" with red accent inset flush at 3.5" within assembly.
- Overall sign dimensions to be 72" height including base, with 65" sign body and 7" base. Sign width to be 45.5". Base depth to be 10".
- Top of sign to be sloped down at a 7-degree angle with continuous metal cap.
- All metal panels to be minimum 0.125" aluminum with high-performance exterior paint or powder-coated finish. Black panel to be matte/satin finish. Red panel to be gloss finish.
- Internal structure to be welded aluminum or steel frame engineered for exterior conditions.
- All edges of sign to be straight with square corners unless noted. Panel joints to be tight and aligned. Fasteners to be concealed or color-matched.
- Sign to be mounted to concrete footing with concealed anchor system. Coordinate structural support and footing design - delegated design
- Contractor to verify all dimensions and field conditions prior to fabrication. Signage to comply with applicable local codes.

• Remove existing monument sign. Restore all adjacent disturbed materials to original condition after installation of new sign. Provide and install three bushes behind the new sign, matching the existing bushes in size, type, and overall appearance.

Front of Sign

- Primary vertical text will be the wordmark from the logo (vector supplied by Architect) with 1/2" to 1" depth, painted white with non-glare finish and mechanically fastened to sign face. Dimensional lettering to be routed out of sign metal panel face with acrylic letters pushed through from behind and bonded on interior side.
- Provide (1) 43" digital display integrated into the black panel field with visible opening of 22.5" x 38.5". Display to be recessed with metal trim surround, flush with face of sign.
- Provide 20" wide logo element graphic above digital display. Maintain consistent margins around display opening and adjacent lettering.
- Digital display to be internally supported within sign structure with concealed wiring, ventilation clearances, and removable access panel for maintenance.

Back of Sign

- Provide 22.5" wide logo graphic (vector logo to be supplied by Architect).
- "Welcome" text to be Montserrat Bold uppercase dimensional lettering at 27.25" wide with 1/2" to 1" depth, painted white with non-glare finish and mechanically fastened to sign face. Dimensional lettering to be routed out of sign metal panel face with acrylic letters pushed through from behind and bonded on interior side.

*Full-scale vector artwork is available from Architect upon request.

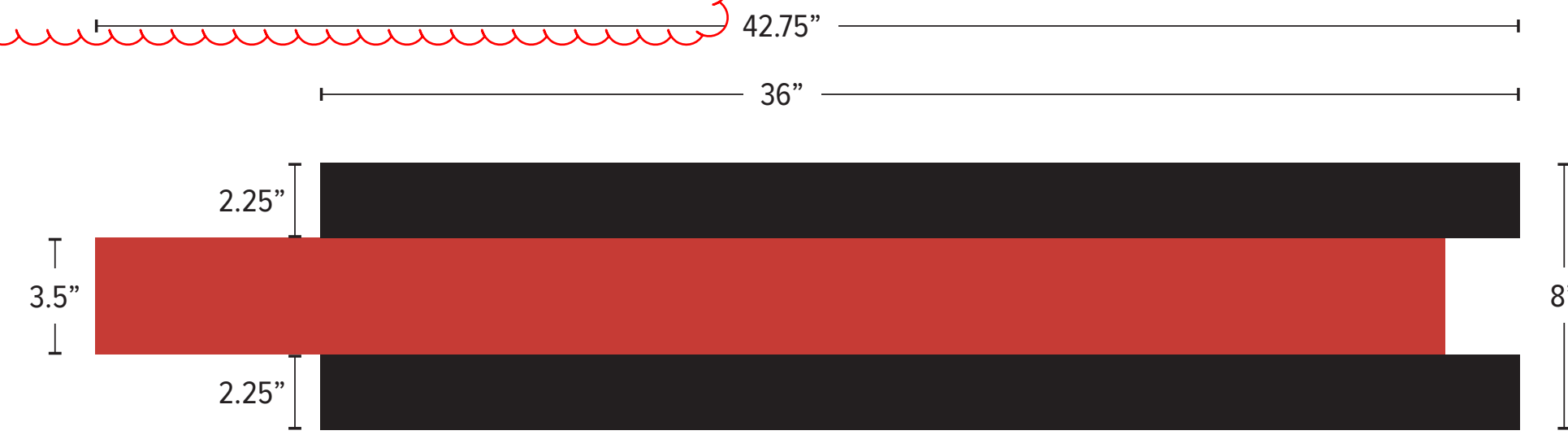

TOP VIEW



TOP VIEW



FRONT VIEW



BACK VIEW



LEFT VIEW



RIGHT VIEW



Project No. 2025-232.WAY
Project Date 05.21.2026
Produced KG JG

These Drawings and Specifications, and all copies thereof are and shall remain the property and copyright of the Architect. They shall be used only with respect to this Project and are not to be used on any other Project or Work without prior written permission from the Architect.

#	Revision	Date
A2	ADDENDUM 2	06.15.2026

302 S College Ave,
Bloomington, IN 47403

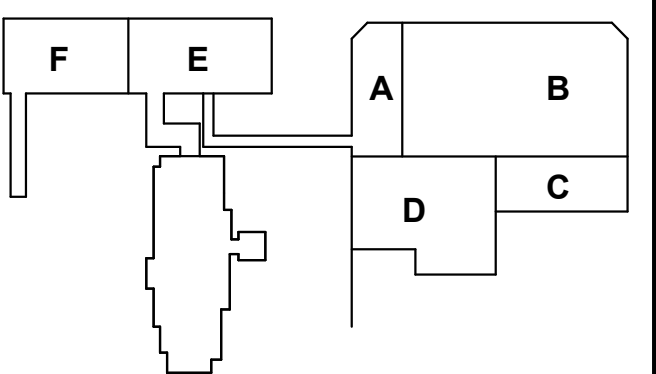

KEY PLAN

MONROE COUNTY CAPITAL IMPROVEMENT BOARD



BLOOMINGTON CONVENTION CENTER - WAYFINDING

MONUMENT SIGN

WF-401



Better Foresight
Better Insight
Better On-Site

317.263.6226
Indianapolis | Louisville
schmidt-arch.com

Bidding RFI Responses Report

2025-232.WAY

Bloomington Convention Center Expansion and Renovation Wayfinding & Signage

Prepared On: 6/15/2026

ID	Subject	Question	Response
BID-005	Exterior Sign Location	Please provide column lines showing the location of the exterior sign shown on sheet WF405.	Response (Answered) from: Eddie Layton (Schmidt Associates) Remarks: Please see revised floor plan noting location in Addendum #2
BID-006	Monument Sign	The monument sign location shown on WF100 appears to be in the same location as the existing sign but there is no mention of demolition of the existing monument sign, nor any landscape or hardscape that is to be included. Please advise.	Response (Answered) from: Eddie Layton (Schmidt Associates) Remarks: Please see addendum #2
BID-007	Directional Sign Location	The locations of the 14 directional signs are vague, and I anticipate some of these are in landscaping, some in sidewalks, and some in some type of pavement. Please advise if there is any additional information on exact locations and what the contractor's scope of putback of adjacent finishes.	Response (Answered) from: Eddie Layton (Schmidt Associates) Remarks: Please see addendum #2 for guidance on how to handle adjacent existing conditions.
BID-008	Permitting	Please advise if the awarded contractor is to submit for any permitting.	Response (Answered) from: Eddie Layton (Schmidt Associates) Remarks: Exterior signs have been conceptually approved through BZA. Awarded contractor will be responsible for final City of Bloomington signage permit.